

JACKTECH Aluminium bell housing

Product Characteristics

- By using bell housings motor and pump shaft are aligned to each other optimally
- Material aluminium low weight with sufficient strength
- Horizontal assembly possible with foot cum flange motor
- Bell housing material high grade aluminium pressure die cast
- Jacktech GJM series aluminium bell housing are precisely machined to reduce misalignment of coupled shafts
- Aluminium bell housing also reduces the noise generation considerably
- Aluminium bell housing size available as per factory stock



Units Dimensions

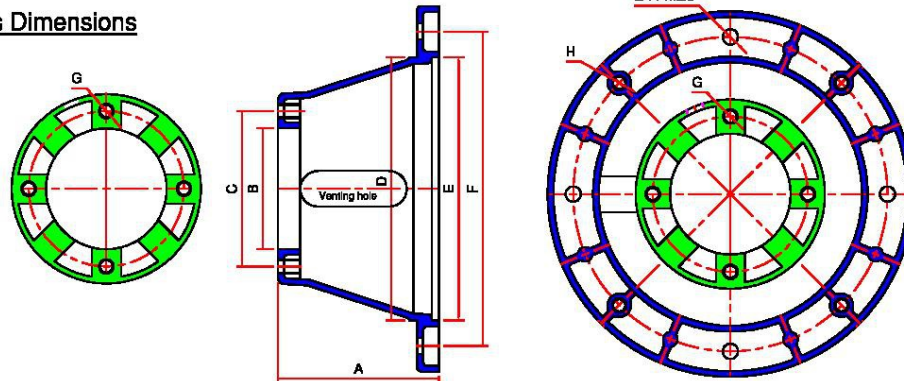

Dimensional Details & Ordering information

PART NO.	FRAME SIZE	MOTOR H.P.	A	B	C	D	E	F	G	H
13082680	80	0.75,1	80	82.6	106.2	140	130	165	M10	M10
130826100	80,90 S/L	0.75,1,1.5,2	100	82.6	106.2	140	130	165	M10	M10
130826130	80,90 S/L	0.75,1,1.5,2	130	82.6	106.2	140	130	165	M10	M10
13060130	80,90 S/L	0.75,1,1.5,2	130	60	80	140	130	165	Ø9	M10
180826110	100L/112M	3,5	110	82.6	106.2	180	180	215	M10	M12
180826124	100L/112M	3,5	124	82.6	106.2	180	180	215	M10	M12
18060124	100L/112M	3,5	124	60	80	180	180	215	Ø9	M12
230826145	132S/132M	7.5,10	145	82.6	106.2	230	230	265	M10	M12
2301016145	132S/132M	7.5,10	145	101.6	145.9	230	230	265	M12	M12
23060145	132S/132M	7.5,10	145	60	80	230	230	265	Ø9	M12

Note: *This bell housing dimension as per jacktech gear coupling & jacktech standard
 * bell housing kits with Bore key ways coupling & all mounting bolt also available

