

# Towline Floor Conveyor Plant for Wood Finished Paint Shop

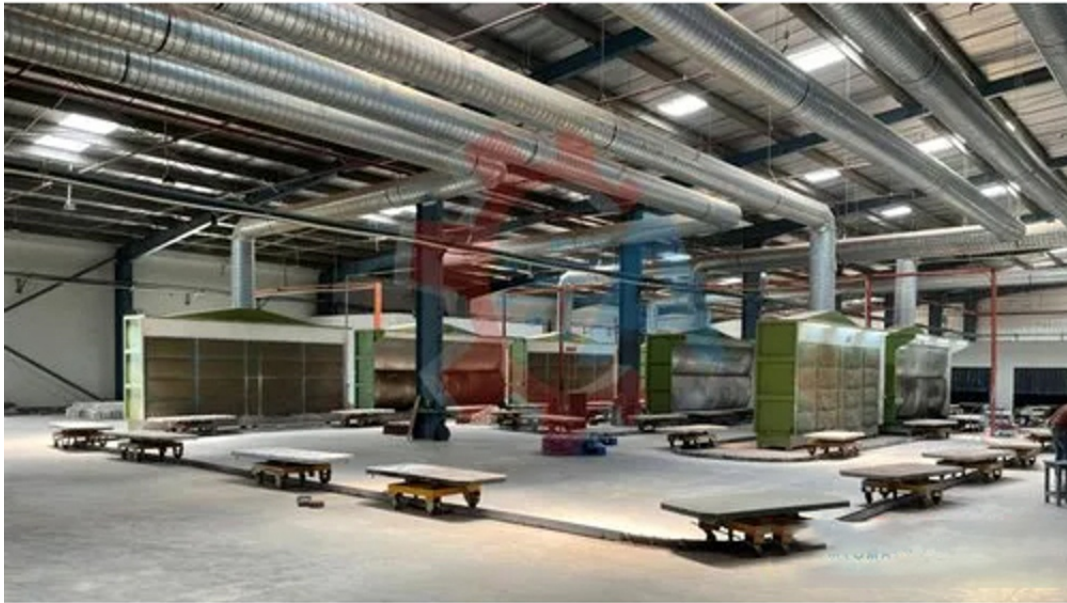

A Towline Floor Conveyor Plant for Wood Finished Paint Shop is a type of material handling system that involves carts or carriers being pulled along a fixed track, transporting materials or products through various stages of a production process. This consists of a network of tracks or pathways embedded in the floor of the facility. These tracks guide wheeled carriers that are attached to a towing mechanism, usually a chain or cable system. Towline Floor Conveyor Plant for Wood Finished Paint Shop offers benefits such as increased efficiency, reduced labor costs, improved product consistency, and a streamlined production process.

## FAQ

**Q:** What material is used to manufacture the Towline Floor Conveyor Plant for Wood Finished Paint Shop?

**A:** The Towline Floor Conveyor Plant for Wood Finished Paint Shop is manufactured using superior quality materials like MS, Alloy Chain, and Stainless Steel.

**Q:** What is the color of the Towline Floor Conveyor Plant for Wood Finished Paint Shop?

**A:** The Towline Floor Conveyor Plant for Wood Finished Paint Shop is available in silver color.

**Q:** Is the Towline Floor Conveyor Plant for Wood Finished Paint Shop suitable for use in automotive, aerospace, and other industries?

**A:** Yes, it is suitable for use in automotive, aerospace, and other industries.