

- Application to all range of hydraulic equipment and in the transmission market.
- Maintenance free no lubrication Crowned – tooth form gears permitting axial and angular misalignment
- Cost effective, Easy to assemble
- 2 drive hubs engaging in a sleeve
- Compact and streamlined available in five sizes to suit 1 to 75 HP maximum
- Maximum permissible angular misalignment 1.5 degrees. Ensure that the coupling hubs easily fit on shaft.
- Do not use undue force.
- Maintain gap between hubs as shown in sketch.
- Use grub screws to locate gear hubs on their respective shaft
- For shock load application use the following formula

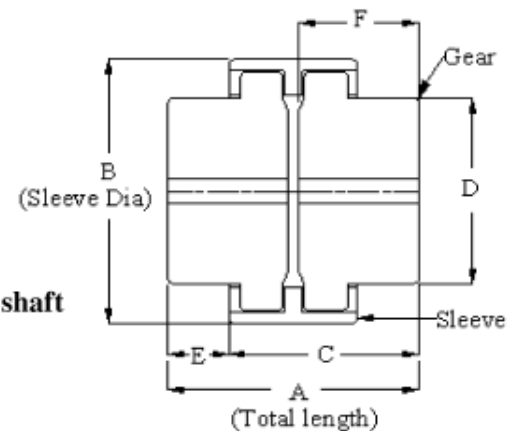

Rating / 100 RPM of coupling

$\frac{Hp \text{ of application} \times 100}{RPM \text{ of application}}$

## ORDERING MODEL CODE

| M  | GEAR COUPLING |
|----|---------------|
| 19 | SIZE          |

| DIMENSION        | M-19<br>MM | M-28<br>MM | M-38<br>MM | M-48<br>MM | M-65<br>MM |
|------------------|------------|------------|------------|------------|------------|
| A                | 53.0       | 81         | 84         | 106        | 146        |
| B                | 49.0       | 67         | 85         | 103.5      | 138.5      |
| C                | 45.0       | 64         | 67         | 79         | 111        |
| D                | 30.5       | 45         | 59         | 68         | 96         |
| E                | 8.0        | 17         | 17         | 27         | 35         |
| F                | 25.0       | 40         | 40         | 50         | 70         |
| G Pilot bore dia | 10.0       | 10         | 12         | 12         | 18         |
| Teeth            | 24.0       | 34         | 44         | 50         | 54         |

| COUPLING | 3000 RPM |      | 1500 RPM |    | 1000 RPM |     | 750 RPM |     | MAX TORQUE AT 1500 RPM |        | MAX RPM | WEIGHT |
|----------|----------|------|----------|----|----------|-----|---------|-----|------------------------|--------|---------|--------|
| SIZE     | KW       | HP   | KW       | HP | KW       | HP  | KW      | HP  | KG.M                   | FT.LBS |         | KGS    |
| 19       | 1.5      | 2    | 0.75     | 1  | 0.75     | 1   | 0.75    | 1   | 0.5                    | 3.5    | 3000    | 0.33   |
| 28       | 7.5      | 10   | 3.7      | 5  | 3.7      | 5   | 2.2     | 3   | 2.5                    | 17.5   | 3000    | 1.06   |
| 38       | 10       | 13.5 | 7.5      | 10 | 5.5      | 7.5 | 3.36    | 4.5 | 4.8                    | 35     | 3000    | 1.83   |
| 48       | 22       | 30   | 18       | 25 | 15       | 20  | 11      | 15  | 12                     | 87.5   | 3000    | 3.15   |
| 65       | 55       | 75   | 55       | 75 | 37       | 50  | 30      | 40  | 35.5                   | 260    | 3000    | 9.13   |

TOLARNCE =±1MM

DIMENSION IN MMFOR REFERENCE ONLY

