



**HD INTERNATIONAL**

**ISO**  
9001:2015



**Manufacturers & Exporters of  
All Kind of Brass, Copper, Aluminum &  
Non Ferrous Metal Components**



## ABOUT US

### LEADING MANUFACTURER OF PRECISION BRASS COMPONENTS



With experience and expertise of more than two decades, our best quality products and effective client services have put our name as the well-known metal components manufacturer and supplier among leading companies in India and Overseas. Our products suits to all industrial sectors like Automotive, Electronics, Aerospace & Defence, Petro Chemical, Hydraulics, Medical, Construction and other Industrial Application. With state of the art machineries, skilled labour, sufficient measuring instruments and Well experienced management, we always serve better quality at best prices. We are committed in our efforts to give you total satisfaction in terms of product and service.

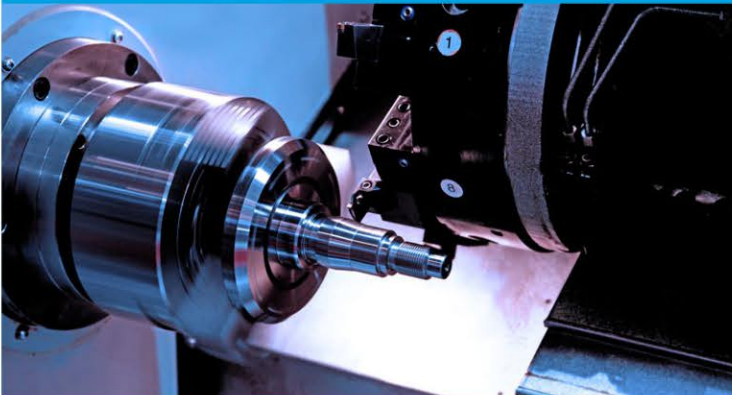

## Our Mission

Our Mission is to assure our customers' success by providing them with the best manufacturing solutions and delivering superior quality products on time.

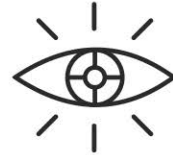

## Our Vision

"Our Vision is to be the company of choice for our customers and employees. To provide innovative solutions using the best technology and people assuring stability and longevity."



YEARS OF EXPERIENCE



CUSTOMISED COMPONENTS  
DEVELOPED



COUNTRIES WE EXPORT



APPLICATIVE SECTORS

## WHY US?

- ▶ Cost Effective Solution & Best Quality Products.
- ▶ Advanced Manufacturing Facilities.
- ▶ Most Competitive Prices.
- ▶ More Focus On The Core Activities.
- ▶ Project Oriented Work.
- ▶ Customized Components Solution.
- ▶ Highly Skilled Workforce.
- ▶ Latest Technology Machines.
- ▶ Strong R & D Department.
- ▶ Speedy Work & On Time Delivery.

## QUALITY



We strictly adhere to stringent quality management systems in order to facilitate an error free production from every stage our entire manufacturing process is monitored by a team of well professionals having years of experience behind them.

Our efforts for offering quality products have been recognized due to our Quality Management System awarded us with an ISO 9001:2015 certifications. Each and every stage of the manufacturing process is closely monitored by our team of quality check managers. We possess an in-house testing facility to ensure maximum accuracy in the finished products.

## QUALITY TESTING EQUIPMENTS



Vision Measuring System



Profile Projector



Hardness Tester



Roughness Tester

## CAPABILITIES

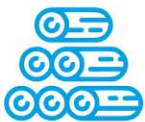

### Raw Material

Brass, Copper, Aluminium, Stainless Steel, Bronze etc.



### Forging

Size Up to 15kg Forging Part



### Casting

Size Up to 25kg Casted Parts

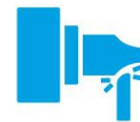

### Turning

Up To  $\phi$  to 500 MM

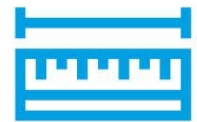

### Length

Up to 1000 MM



### Surface Finish

Natural  
Buffed  
Blasted



### Surface Treatment

Nickel, Tin, Silver, Chrome, Gold, Anodizing, Electroless Plating Treatment etc.



### Documentation

ISO 9001, Pap-level5, RoHs, Reach Compliances, & as per Customer's Need



### Packing

As Per Customer's Requirement

### Brass Neutral Links

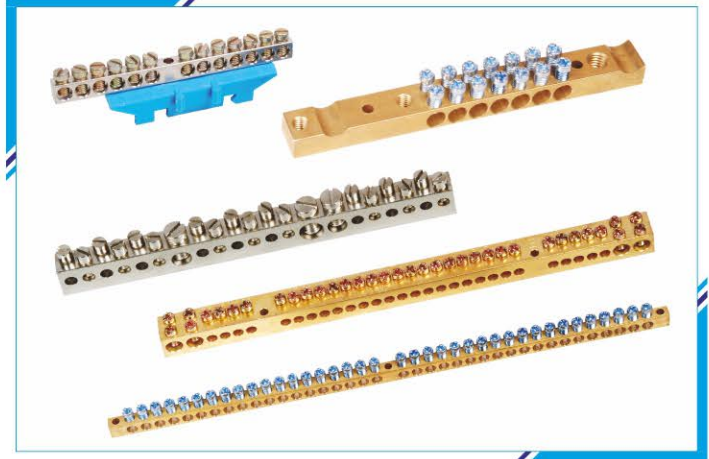
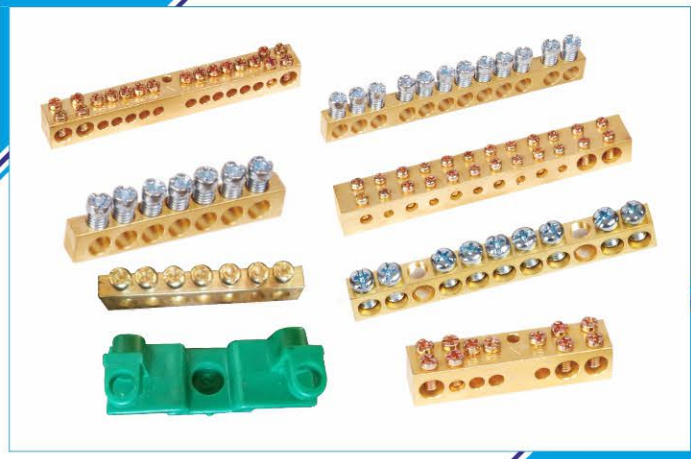

### Copper Neutral Links

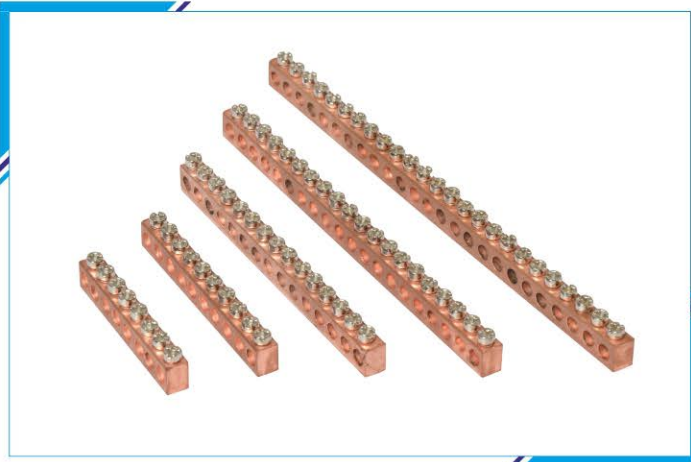

### Aluminum Neutral Links



### Copper Bus Bar



### BRASS FUSE PARTS



### BRASS TERMINAL BLOCKS

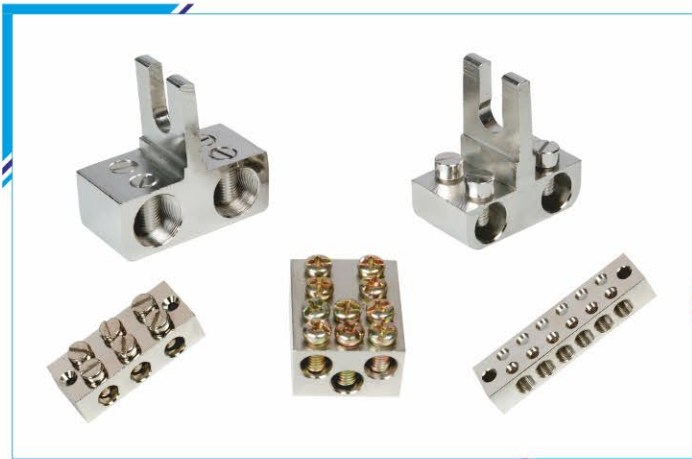

### BRASS SWITCHGEAR COMPONENTS

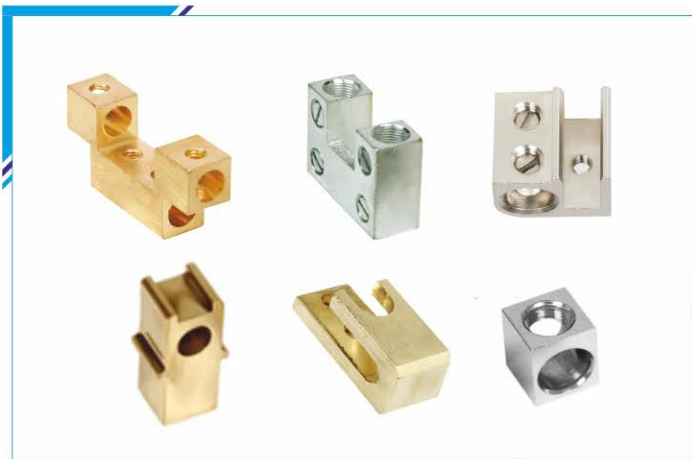

### BRASS ENERGY METER PARTS



### BRASS TERMINAL & ASSEMBLY



### BRASS PLUG & SOCKET PINS



## BW INDUSTRIAL CABLE GLAND

- Size : 20 mm to 90 mm
- Standard : BS 6121
- Application : Dry Indoor, for use with all types of SWA Cable
- Function : Provide mechanical Cable Retention & Electrical Wire continuity via Armoured Wire.
- Material : Brass BS 2874 CZ121 Pb3
- Optional Threads : METRIC, NPT, BSP, PG or as specified
- Finish : Brass Finish, Nickel Finish, Chrome Finish or as specified
- Operating Temp. : -800 C to +3000 C
- Accessories : Matching Accessories available like PVC Shrouds, Lock Nuts, Earth Tag, Reducers, Adaptors, etc. as per the requirement

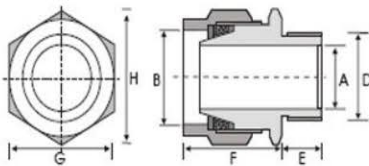

Size	Cable Dimensions Accomodate			Gland Dimensions			
	Under Armour Dia. A Max. mm	Overall Dia. B Max. mm	Armour wire dia C mm	ISO Entry Thread		Hexagon Size	
				Dia. D mm	Length E mm	Across flat G mm	Across corners H mm
20S	11.80	16.10	0.90/1.25	20	9.50	21	23.80
20	14.10	18.40	0.90/1.25	20	9.50	22.50	25.50
25	20.20	25.20	1.25/1.60	25	9.50	31.50	35
32	26.40	32.40	1.60/2.00	32	10	40.40	44.80
40	32.30	38.60	1.60/2.00	40	15	46.50	51
50S	38.20	46.20	2.00/2.50	50	15	54	60
50	44	52	2.00/2.50	50	15	60.50	66
63S	50.40	58.10	2.50	63	15	66	73
63	56.30	64.60	2.50	63	15	72.50	81.50
75S	61	70.90	2.50	75	15	80	90.50
75	68.30	78.20	2.50/3.15	75	15	85	93
82	74.50	84.10		82	15	96	106
90	80.50	92.70	3.15	90	15	102.50	112

## CW INDUSTRIAL CABLE GLAND

- Size : 20 mm to 90 mm
- Standard ; BS 6121
- Application ; Dry Indoor, for use with all types of SWA Cable
- Function : Provide mechanical Cable Retention & Electrical Wire continuity via Armoured Wire.
- Material : Brass BS 2874 CZ121 Pb3
- Optional Threads : METRIC, NPT, BSP, PG or as specified
- Finish : Brass Finish, Nickel Finish, Chrome Finish or as specified
- Operating Temp. : -800 C to +3000 C
- Accessories : Matching Accessories available like PVC Shrouds, Lock Nuts, Earth Tag, Reducers, Adaptors, etc. as per the requirement



Size	Cable Dimensions Accomodate		ISO Entry Thread		Gland Dimensions	
	Under Armour Dia. A Max.	Overall Dia. B Max.	Dia.	Length	Hexagon Size	
					Across flat	Across corners
	mm	mm	D mm	E mm	G mm	H mm
20S	12	19	20	9.50	23	25
20	15	23.50	20	9.50	27	31.80
25S	17.20	25.20	25	10	30	34
25	20.70	30	25	10	34.50	38
32	27	36	32	10	40.50	44
40S	31	41	40	12	46	51
40	33	44.50	40	13	48.50	53.50
50S	40	52	50	15	58	64
50	44.70	57.20	50	14	62.50	69.50
63S	52	64.50	63	15	72.50	80.50
63	57	67	63	15	77	86.50
75S	62.30	77.60	75	15	86.50	96.10
75	69	79	75	15	92	103.50

## A1 / A2 INDUSTRIAL CABLE GLAND

- Size** : 16 mm to 110 mm S & L  
**Standard** : EN 50262 : 1999  
**Application** : Outdoor or Indoor for use with all types of Rubber or Plastic, Un-armoured Cable  
**Function** : Provide Seal on Outer Sheath of Rubber or Plastic, Un-armoured Cable.  
**Material** : Brass BS 2874 CZ121 Pb3  
**Optional Threads** : METRIC, NPT, BSP, PG or as specified  
**Finish** : Brass Finish, Nickel Finish, Chrome Finish or as specified  
**Operating Temp.** : Standard seals -200 to +800 C  
**Accessories** : Matching Accessories available like PVC Shrouds, Lock Nuts, Earth Tag, Reducers, Adaptors, etc. as per the requirement

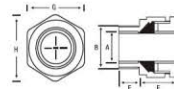

Size	Cable Dimensions Accomodate		Gland Dimensions			
	Under Armour Dia. A Max. mm	Overall Dia. B Max. mm	ISO Entry Thread		Hexagon Size	
			Dia.	Length	Across flat	Across corners
			D mm	E mm	G mm	H mm
16	9.50	13	16	15	20	22.30
20S	11.80	15.50	20	15	23	25
20	14.20	18.30	20	15	25	27
25S	18	22	25	15	30	32
25	20.20	28	25	15	35	39
32S	26.30	31.50	32	15	41	45
32	26.30	31.50	32	15	41	45
40S	33	38.60	40	15	48.50	54.30
40	33	38.60	40	15	48.50	54.30
50S	39	44	50	16.50	54	60
50	45	48.60	50	16.50	60	67
63S	50.50	56.50	63	15	70	77.50
63	56	60	63	15	74	83
75S	62.20	65.80	75	15	80	89.60
90	80	80	90	15	98	109.50
115	104.50	105	115	20	126	

## ETW INDUSTRIAL CABLE GLAND

- Size : 20 mm to 90 mm S & L
- Standard : EN 50262 : 1999
- Application : Outdoor or Indoor for use with all types of SWA Cable
- Function : Provide for Environmental Seal in the Cable Outer sheath. Also, provide mechanical cable retention & electrical continuity
- Material : Brass BS 2874 CZ121 Pb3
- Optional Threads : METRIC, NPT, BSP, PG or as specified
- Finish : Brass Finish, Nickel Finish, Chrome Finish or as specified
- Operating Temp. : Standard seals -200 to +800 C
- Accessories : Matching Accessories available like PVC Shrouds, Lock Nuts, Earth Tag, Reducers, Adaptors, etc. as per the requirement



Size	Cable Dimensions Accomodate		ISO Entry Thread		Gland Dimensions	
	Under Armour Dia. A Max. mm	Overall Dia. B Max. mm	Dia.	Length	Hexagon Size	
			D mm	E mm	Across flat G mm	Across corners H mm
	20S	12	17	20	15	24
20	14.20	20.50	20	15	27	31.20
25S	19	24	25	15	32	35.50
25	20.40	27.50	25	15	36	40
32	27	32.50	32	15	43	47.50
40	33	41.50	40	15	52	58
50	44.50	52.50	50	15	64.50	72.50
63	56.50	66.50	63	15	77.50	86

## CABLE GLAND ACCESSORIES



Lock Nut



Flameproof Stopping Plug



Flameproof Stopping Plug



Hex Adaptor



Reducer



Hex Stop Plug



PVC Shroud



Earthing Tag



Serrated-Washer

## CABLE CLEATS



Aluminium Cable Cleats Double Trefoil



Aluminium Cable Cleats Double Trefoil



Flameproof Stopping Plug

**EARTHING & LIGHTNING ACCESSORIES**



**Air Rod Terminal Base**



**U Bolt Rod Clamps Type E**



**Rod To Cable Clamps GUV**



**Rod to Tape Clamp Type A**

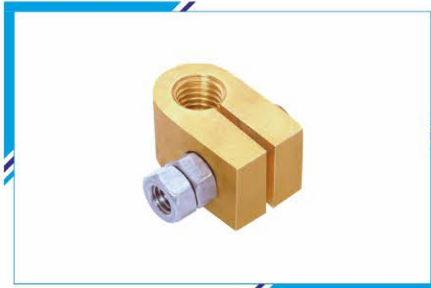

**Split Connector clamps**



**Heavy Duty Conductor Saddle**



**DC Date Clips**



**Square Tape Clamps**



**Plate Test Clamp**



**Coupling Dowel**



**Coupler**



**Split Bolt Connector**



**Rebar Clamp**



**Cable To Square Joint**



**Cable Tee Clamp**

## CABLE LUGS



Fork Type Insulated Lugs



Pin Type Insulated Lugs



Ring Type Insulated Lugs



Insulated Female Connectors



Crimping Type Copper Tubular Cable Lugs



Ring Terminals (Non Insulated)



Flameproof Stopping Plug



Flameproof Stopping Plug



Flameproof Stopping Plug



Mechanical Cable Lugs



Aluminium - Copper Bi-Metal Cable Lugs



Copper One Hole Offset Tongue



Flameproof Stopping Plug



Flameproof Stopping Plug



Flameproof Stopping Plug

### S.S. CABLE TIES



### ALUMINUM COMPONENTS

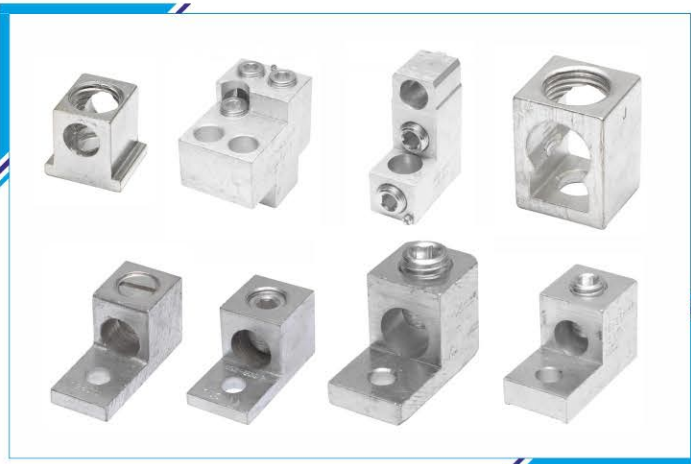

### SHEET CUTTING PARTS



### BRASS INSERTS

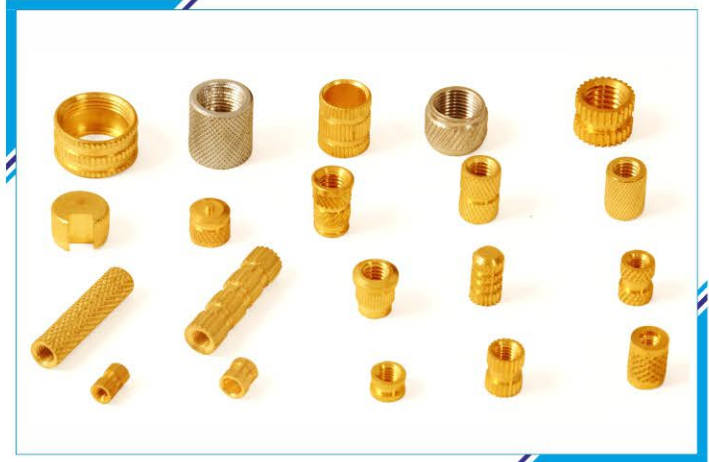

### BRASS & STEEL FASTENERS



### BRASS FORGING COMPONENTS



### BRASS TURNED COMPONENTS



### BRASS SANITARY PARTS



### STANDOFF INSULATORS



Conical



Hexagonal



Drum

### PORCELAIN CONNECTORS



### BUS BAR SUPPORTS - FINGER TYPE

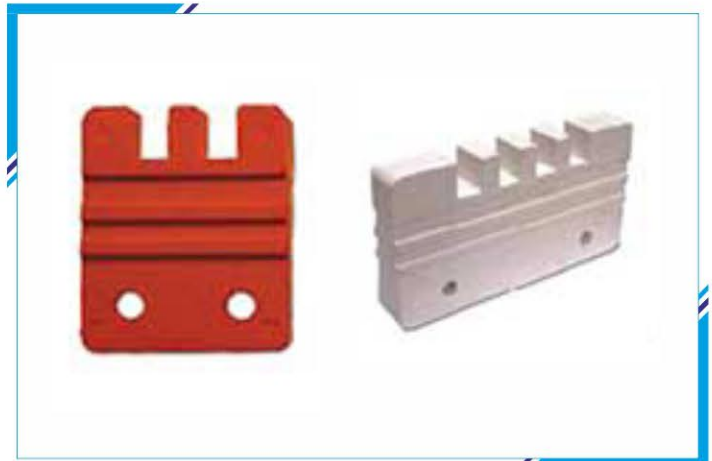

## BUS BAR SUPPORTS - FOUR POLE

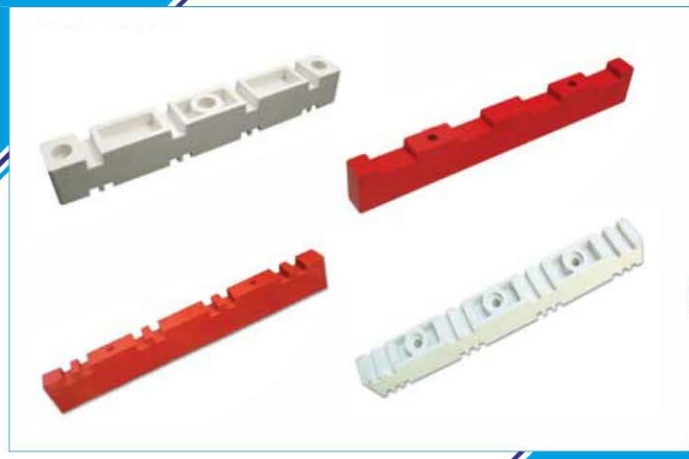

## CNC MACHINED COMPONENTS



## STAINLESS STEEL COMPONENTS



## MANUFACTURING FACILITIES

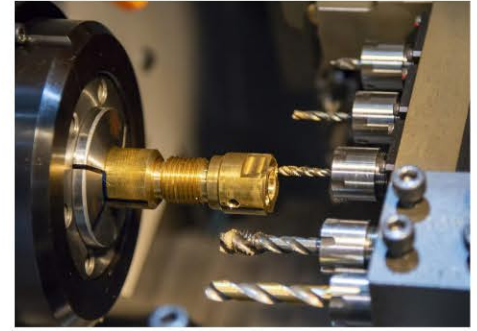

our commitment to excellence extends to our state-of-the-art infrastructure, which plays a pivotal role in delivering top-quality metal components and services. Our well-equipped facilities are designed to meet the highest industry standards and ensure the efficient production of a wide range of ferrous and non-ferrous metal components.

Our manufacturing facility is a testament to our dedication to precision and quality. With cutting-edge machinery and technology, we have the capability to produce customized metal components to exact specifications. Our team of skilled professionals operates in a safe and organized environment, ensuring the highest standards of production.

## Industries We Serve



Power Generation



Automobile Industries



Electrical Industries



Solar Energy Industries



Railway Industries



Aerospace Industries



Marine Industries



Telecommunication Industries

## COUNTRIES WE EXPORT



UK



Saudi Arabia



Europe



France



Thailand



UAE



Australia



USA



Hungary



Spain



Mexico



Germany



Italy



Poland



Malaysia



Switzerland



## HD INTERNATIONAL

📍 Shed No. 3343, "C" - Road, G.I.D.C., Phase - III,  
After Mahavir Circle, Jamnagar - 361 004.  
Gujarat INDIA

📞 +91 93282 81211 | +91 94281 27501

✉️ [Info@hdinternational.in](mailto:Info@hdinternational.in) 🌐 [www.hdinternational.in](http://www.hdinternational.in)

