

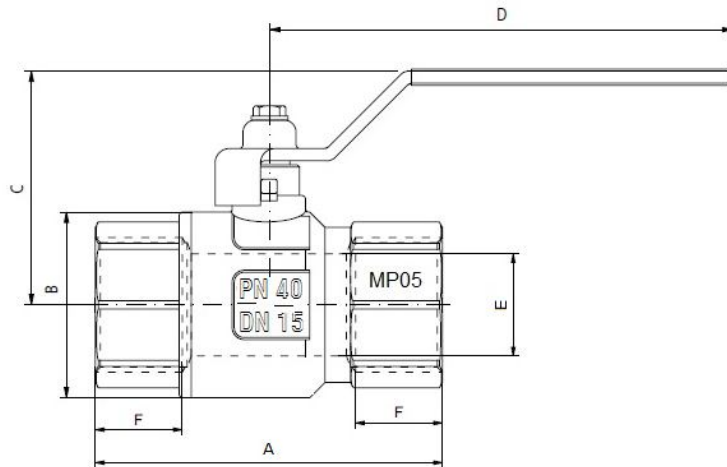

Patel Engineering Co.

GAS Ball Valve with Lever Handle (GBV-FF - L)



PART NO.	THREA D	A	B	C	D	E	F
GBV-FF-2L	¼	42	21	35	65	8	10.5
GBV-FF-3L	3/8	44	24	37	65	10	11
GBV-FF-4L	½	54	29	47	80	15	14.5

All threads are in BSP.

All dimensions are in mm.

Materials of Construction

- 1) Body : Nickel Plated Forged Brass
- 2) Handle : Nickel Plated Steel with Yellow Color PVC Sleeve
- 3) Ball : Hard Chrome Plated forged Brass
- 4) Stem : Hot forged Brass
- 5) Seal (Seat): Teflon (P.T.F.E.)
- 6) Seal (Stem): Teflon (P.T. F. E.)
- 7) Screw : Nickel Plated Mild Steel

Technical Features:

- 1) Application : Air / Water / Oil / Gas /Fuel ...etc
- 2) Working Pressure : 40 KG / 600 LBS
- 3) Working Temperatures: -30°C to 180°C
- 4) Types : Full Bore
- 5) Available Sizes : 1/4", 3/8" & 1/2"
- 6) Standard : Manufacturing As Per EN 331

QUALITY ASSURANCE PROVISIONS

Quality assurance provisions shall be in accordance with the Material Requisition and with the following additional requirements:

- All Valves are to be thoroughly tested before dispatch. Valves supplied shall be issued with a copy of Pneumatic test certificates, foundry or mill certificates and Fire safe certificates.
- The foundry and mill certificates are to be issued detailing heat numbers, chemical and mechanical properties; the COMPANY reserves the right to request an independent Inspection authority to test conformity.

Patel Engineering Co.

22, Jai Ganesh Varadhasta, Near Dr. Ambedkar Statue, Pimpri Chowk
Pune - 411018, Maharashtra, India

Telephone : +91 – 20 – 27426770 & +91 – 922 633 7770

Fax : +91 – 20 – 27426770

Contact Person : Sandip Patel

Mobile No. : +91 – 901 103 7770

Email : pec.sandip@gmail.com / patel.eng@rediffmail.com

Website : www.pateleng.in