

Dust Filter Panels

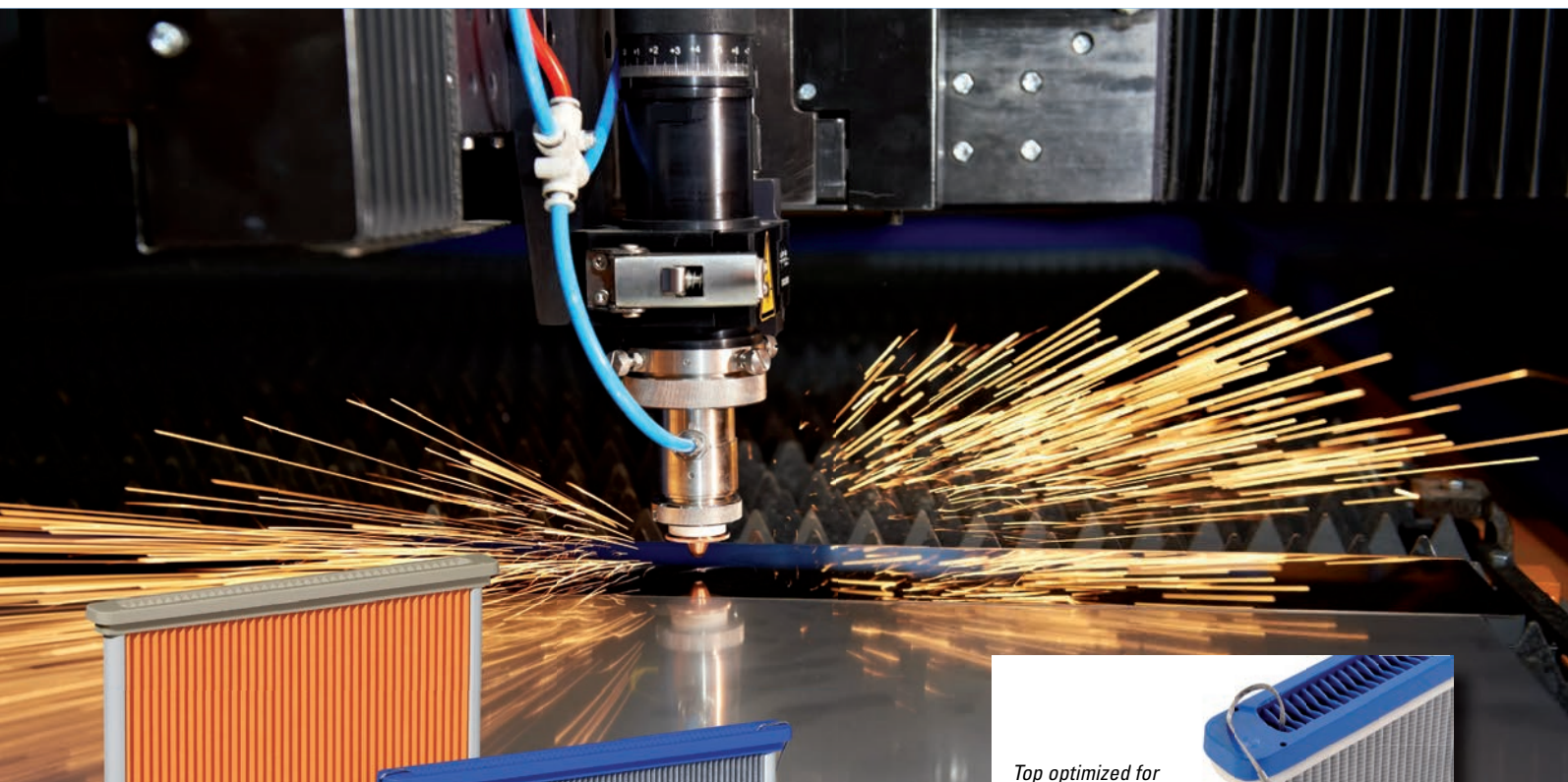

*Top optimized for
most efficient cleaning*



APPLICATIONS

- Separation of oil and emulsion mist
- Chemical industry
- Minimal lubrication
- Separation of welding fume
- Laser and plasma cutting
- Pharmaceutical industry

ADVANTAGES

- Capable of bearing high dust loads
- Venturi-shaped openings for efficient cleaning
- High mechanical loading capacity due to robust design
- Long lifetime

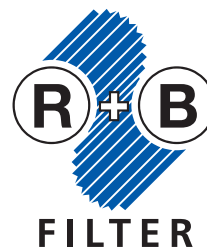

Dust Filter Panels

FILTER MEDIA

Adjusted to application:
Non wovens or needle felts made of polyester and other nonstandard media

Possible Equipments:

- Antistatic
- Oil and water repellent
- PTFE finish
- Microporous finish
- ePTFE membrane

Certified in accordance with DIN EN 60335-2-69 appendix AA, Suitable for the filtration of health hazardous dusts

FEATURES

- Maximum operating temperature 80 °C
- Metal parts galvanized steel
- Cleanable by compressed air

SPECIAL TYPES

- Temperature resistant up to 120 °C
- Suitable for ATEX applications of all zones
- Certified for use in food production in accordance with DIN EN 1935, FDA CFR 21
- Metal parts of stainless steel
- Other individual solutions

ACCESSORIES

- Venturi nozzle 310-002-000008
- Gaskets
- Solenoid valves
- Valve control systems

SERVICE

We advise at the selection of the filter element and the best matching filter medium for the application as well as the design of dust collectors.

clean side installation

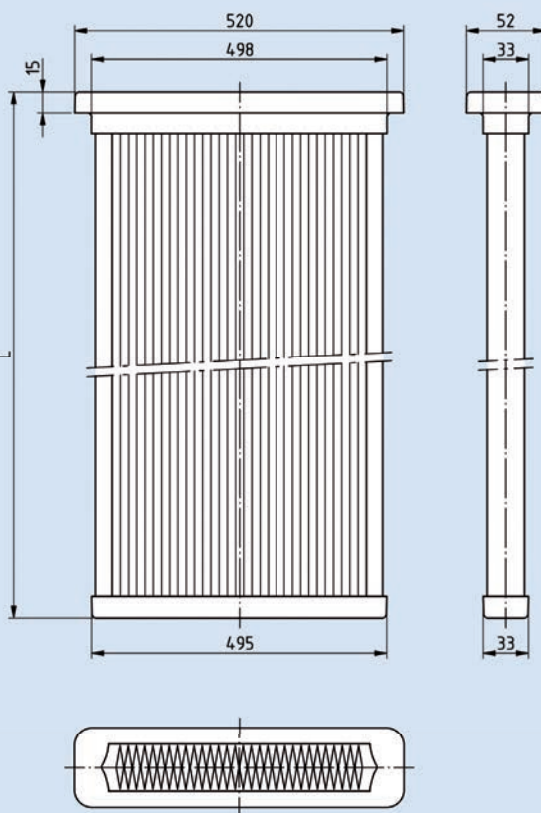

[mm]	Length L [mm]	Filter area [m ²]
520-498	605	1,4
520-498	605	2,1
520-498	985	2,4
520-498	985	3,6
520-498	1205	2,8
520-498	1205	4,2

Technical changes reserved 04 / 16

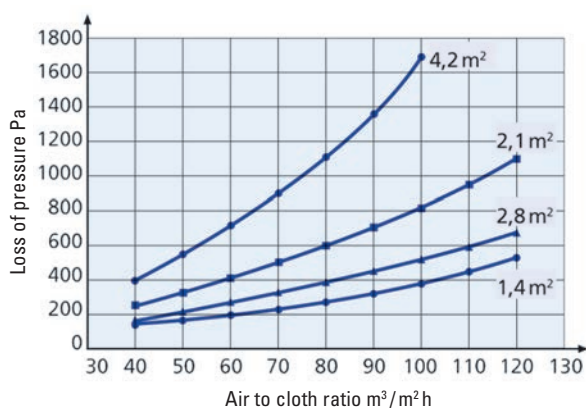

p = 5 bar, Cycle time = 100 s, Pulse time = 30 ms, k_{Raw} = 4 g/m³

FILTER RESISTANCE CHARACTERISTIC LINES

Pressure loss of the filter panels as a function of air to cloth ratio

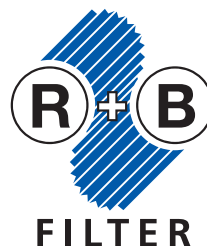

R + B Filter GmbH
Bössingerstrasse 34
74243 Langenbrettach-Langenbeutingen
Germany
Phone: +49 (0) 79 46 91 27-0
Fax: +49 (0) 79 46 91 27-39
E-Mail: info@rb-filter.de
www.rb-filter.com

