

The proven bonded anchor for non-cracked concrete



High-bay warehouses



Collision protection

VERSIONS

- zinc-plated steel
- stainless steel
- highly corrosion-resistant steel
- hot-dip galvanised steel

BUILDING MATERIALS

Approved for:

- Concrete C20/25 to C50/60, non-cracked

Also suitable for:

- Concrete C12/15, non-cracked
- Natural stone with dense structure

APPROVALS



2

ADVANTAGES

- The pre-portioned resin capsule is especially economical for individual applications and overhead installations.
- The choice between standard and intensive cleaning allows for individual adaptation either to achieve rapid progress or to obtain the maximum load level.
- The wide range of approved steel types allows for use in all corrosion resistance classes and offers the best possible application safety.
- The extensive range of RG M from M8-M30 opens up a wide range of applications and therefore offers great flexibility.
- The larger anchorage depths of the RG M E variants allow for an even greater load level. Thus fewer fixing points are required.

APPLICATIONS

- Steelwork constructions
- Timber constructions
- Guard rails
- Staircases
- Column bases
- Machines
- Masts
- Ideal for:**
- Overhead installations
- Water-filled drill holes

FUNCTIONING

- The resin anchor R is suitable for pre-positioned installation when combined with the threaded rod RG M.
- The 2-component resin capsule R M contains quick-setting styrene-free vinyl ester resin and hardener.
- The threaded rod RG M is set using a hammer drill and the accompanying setting tool in rotating and hitting motions.
- During setting, the oblique edge of the RG M destroys the capsule, and mixes and activates the mortar.
- The mortar bonds the entire surface of the threaded rod with the drill hole wall and seals the drill hole.

INSTALLATION

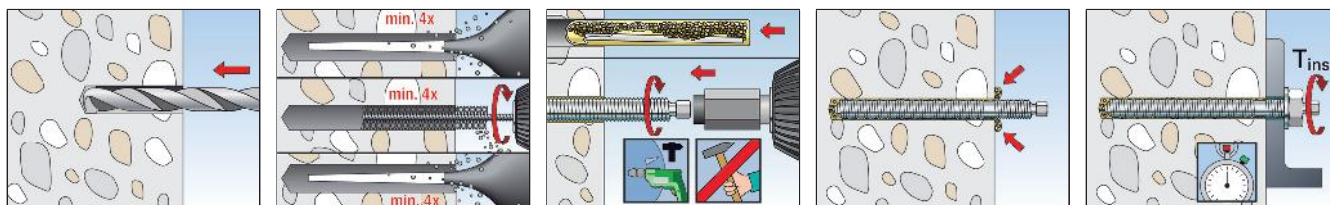

TECHNICAL DATA



Resin capsule R M

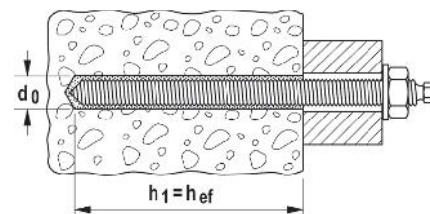

Item	Art.-No.	Approval ETA	Drill hole diameter d_0 [mm]	Min. drill hole depth h_1 [mm]	Effect. anchoring depth h_{ef} [mm]	Fits	Sales unit [pcs]
R M 8	050270 ¹⁾	■	10	80	80	RG M 8	10
R M 10	050271 ¹⁾	■	12	90	90	RG M 10	10
R M 12	050272	■	14	110	110	RG M 12	10
R M 12 E	048501	■	14	150	150	RG M 12 E	10
R M 14	050278 ²⁾	■	16	120	120	RG M 14	10
R M 16	050273	■	18	125	125	RG M 16	10
R M 16 E	079838	■	18	190	190	RG M 16 E	10
R M 20	050274	■	25	170	170	RG M 20	10
R M 20 E	079840	■	25	240	240	RG M 20 E	5
R M 22	512763	—	30	190	190	RG M 22	5
R M 24	050275	■	28	210	210	RG M 24	5
R M 24 E	079842	■	28	290	290	RG M 24 E	5
R M 27	079843	■	32	250	250	RG M 27	5
R M 30	050276	■	35	280	280	RG M 30	5

1) No ETA-approval in combination with internal-threaded anchor RG MI.

2) No ETA-approval in combination with threaded rod RG M.

CURING TIME

Temperature at anchoring base	Curing time
- 5°C - ± 0°C	240 min.
± 0°C - +10°C	45 min.
+10°C - +20°C	20 min.
≥ +20°C	10 min.

Please note: The curing times apply for dry anchoring bases, in damp anchoring bases they should be doubled.