



Mfg. Of : Industrial VALVE'S & Pipe Fitting

'AAI MA' Engineering Company

(AN ISO 9001 : 2015 Certified Company)

Good Quality

Good Service

Good Price



MATERIAL SPECIFICATION
S.S. 304, 316, 316 L, Duplex 2205,
Super Duplex

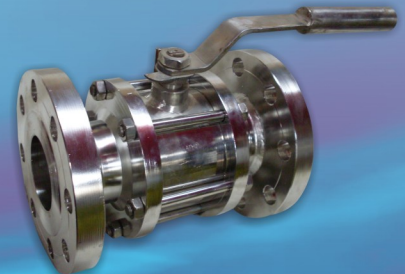



'AAI MA' Engineering Company

Our company is ISO-9001-2000 Certified. We have been in business for more than 15 years. Over the years, we have been highly successful in building healthy business relations with customers in various spheres due to our high quality standards.

Our constant endeavor to improve and enhance our products through research and development has lead to our recent achievement "AAI MA Engineering Company" a unique range of valves with an incomparable advantage for the end user.

This is our first step in the direction of being an environment friendly organisation. We help our customers by helping them save energy. Our speciality product range consists of Ball, Globe, Gate, Check, Butterfly valves and Strainers, Simplex & Duplex Filter.

"AAI MA " Valves and filters are appreciated for their quality, preferred for their reliability and chosen for their timely deliveries.

- ▶ Ball Valve
- ▶ Butterfly Valve
- ▶ Check Valve
- ▶ Control Valve
- ▶ Double Window Side Glass
- ▶ Gate Valve
- ▶ Globe Valve
- ▶ Knife Edge Gate Valve
- ▶ Pulg Valve
- ▶ P R V
- ▶ PTFE Lined Valve
- ▶ Flush Bottom Valve
- ▶ Sight Glass
- ▶ Safety Relies Valves

Material used in - Stainless Steel - AISI-304, 304 L, 316, 316 L, Stainless Steel Duplex 2205, Super Duplex 2507 Forge Steel, Cast Iron, Carbon Steel. Cast Steel, Investment Die-Casting - ASTM A 351 Gr. CF8/CF8M, CF3/CF3M



APPLICATION

"AAI MA " Valve are used in Chemical, Pharmaceuticals, Petrochemicals, Food & Beverages, Fertilizers, Refrigeration, Dairy Plant, Power Plant, Oil Refinery, Sugar Plant, Pulp & Paper Plant, Water Treatment Plant, Gas Plant, Steel Plant, Textiles Process House & Pipe Line Project etc.



AAIMA GATE VALVE

IC Screwed & Socket weld end gate valve in 150 & 300 class.



IC VALVES



BAR STOCK VALVES

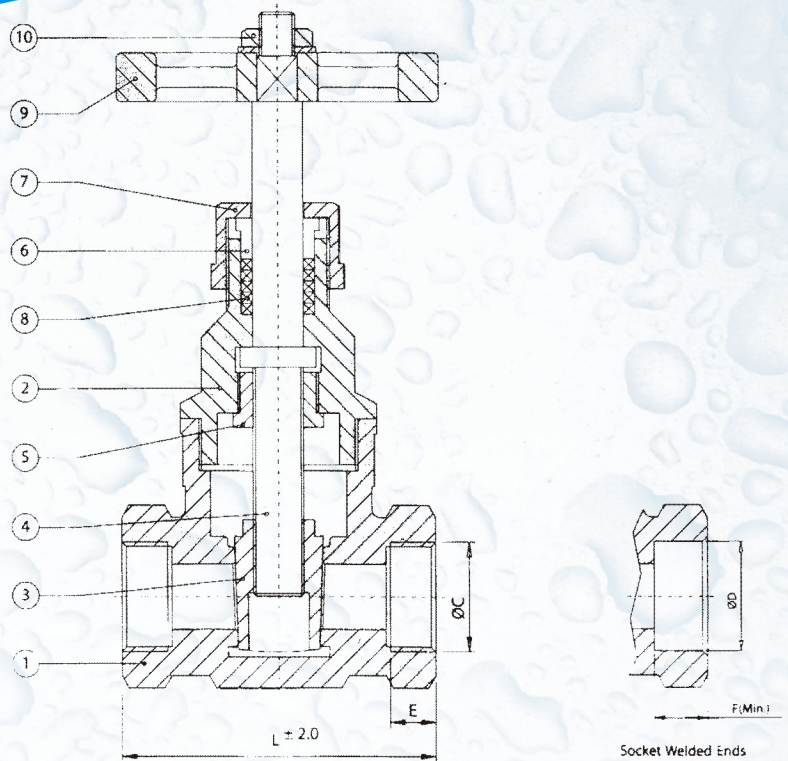

PARTS / MATERIALS LIST

Part No.	Nomenclature	MATERIAL
1	BODY.	ASTM A351 Gr. CF8/CF8M
2	BONNET.	ASTM A351 Gr. CF8/CF8M
3	WEDGE	ASTM A351 Gr. CF8/CF8M
4	STEM	AISI 304 / 316
5	STEM RETAINER	AISI 304 / 316
6	GLAND	AISI 304 / 316
7	GLAND NUT	AISI 304 / 316
8	STEM PACKING	PTFE / GRAFOIL
9	HAND WHEEL	CAST IRON / ALUMINIUM
10	HAND WHEEL NUT & WASHER	SS 304 / M.S. PLATED

All Dimensions are in M.M.

SIZE	L	SCR. ENDS		S.W. ENDS		F(Min.)
		Ø C	E	Ø D		
				Max.	Min.	
15	53	1/2"	13.56	22.22	21.72	9.65
20	63	3/4"	13.87	27.56	27.05	12.7
25	73	1"	17.35	34.29	33.78	12.7
40	80	1 1/2"	18.38	49.15	48.64	12.7
50	85	2"	19.23	61.62	61.11	15.75

TEST PRESSURE (PSIG / Kg / Cm²)

TESTING	BODY	SEAT
HYDRAULIC	425 PSIG	300 PSIG

THE DESIGN AND TECHNICAL DATA FURNISHED HERE ARE SUBJECT TO CHANGE DUE TO CONTINUOUS PRODUCT DEVELOPMENT.

Technical Data :

- Manufacturing Std. : Generally conforming to BS 5352
- End Connection : Screwed Ends to BSP/BSPT/NPT (F)
Victroluck end
Socket Weld Ends to ANSI B16.11
- Inspection & Testing Std. : API 598

I-FLOW VALVES



AAIMA GLOBE VALVE

IC Screwed & Socket weld end globe valve in 150 & 300 class.



IC VALVES



BAR STOCK VALVES

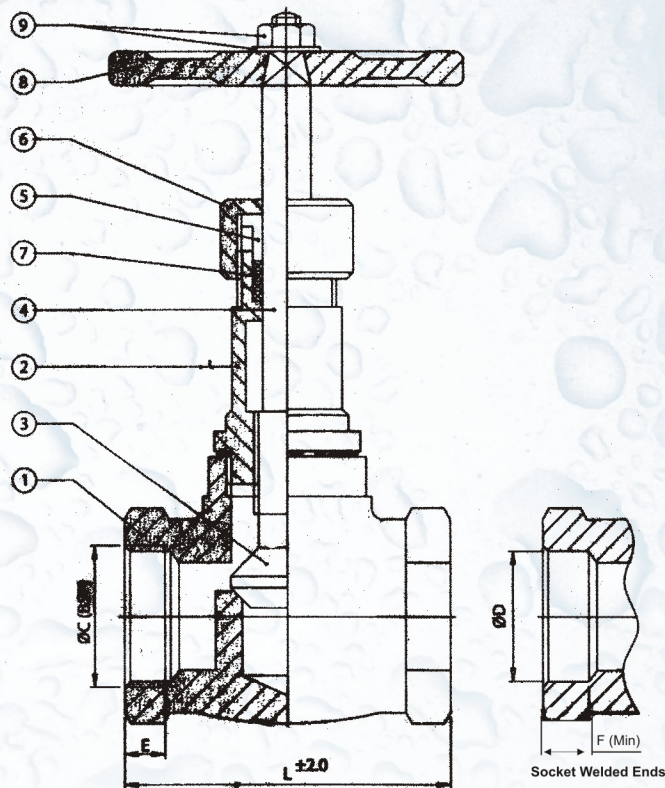

PARTS / MATERIALS LIST

Part No.	Nomenclature	MATERIAL
1	BODY.	ASTM A351 Gr. CF8/CF8M
2	BONNET.	ASTM A351 Gr. CF8/CF8M
3	VALVE (INTEGRAL WITH SPINDLE)	ASTM A351 Gr. CF8/CF8M
4	SPINDLE	AISI 304 / 316
5	GLAND	AISI 304 / 316
6	GLAND NUT	AISI 304 / 316
7	STEM PACKINGS	PTFE / GRAFOIL
8	HAND WHEEL	CAST IRON / ALUMINIUM
9	HAND WHEEL NUT & WASHER	SS 304 / M.S. PLATED

All Dimentions are in M.M.

SIZE	L	SCR. ENDS		S.W. ENDS		
		Ø C	E	Ø D		F (Min.)
				Max.	Min.	
15	60	1/2"	13.56	22.22	21.72	9.65
20	70	3/4"	13.87	27.56	27.05	12.7
25	80	1"	17.35	34.29	33.78	12.7
40	100	1 1/2"	18.38	49.15	48.64	12.7
50	120	2"	19.23	61.62	61.11	15.75

TEST PRESSURE (PSIG / Kg / Cm²)

TESTING	BODY	SEAT
HYDRAULIC	425 PSIG	300 PSIG

THE DESIGN AND TECHNICAL DATA FURNISHED HERE ARE SUBJECT TO CHANGE DUE TO CONTINUOUS PRODUCT DEVELOPMENT.

Technical Data :

- Manufacturing Std. : Generally conforming to BS 5352
- End Connection : Screwed Ends to BSP/BSPT/NPT (F)
Victrolick end
Socket Weld Ends to ANSI B16.11
- Inspection & Testing Std. : BS 6755 (Part-I)

I-FLOW VALVES



AAIMA BALL VALVE 3-PC F/E

IC Full bore, Screwed & Socket weld end ball valve in 150 & 300 class.

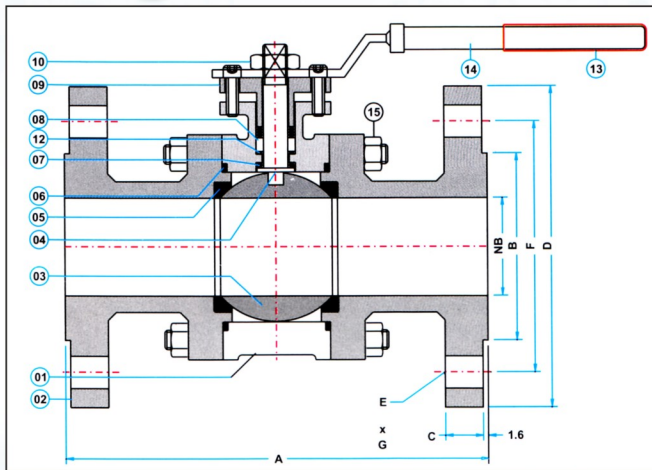

Technical Data :

Manufacturing Std : BS 5351

Inspection And Testing Std : BS 6755 Part 1

TEST PRESSURE

CLASS	HYDROSTATIC	SEAT TEST	AIR TEST
150#	31.5 Kg./cm ²	22 Kg/cm ²	7 Kg/cm ²
300#	79 Kg/cm ²	58 Kg/cm ²	7 Kg/cm ²
600#	157.5 Kg/cm ²	114 Kg/cm ²	7 Kg/cm ²

MATERIAL SPECIFICATION

Part No.	Qty.	DESCRIPTION	MATERIAL
1	1	BODY	ASTM A 351 GR. CF8/CF8M/WCB/C.I.
2	2	BODY CONNECTOR	ASTM A 351 GR. CF8/CF8M/WCB/C.I.
3	1	BALL	AISI 304/AISI 316
4	1	STEM	AISI 304/AISI 316
5	2	BALL SEATS	PTFE/GFT
6	2	BODY SEATS	PTFE/GFT
7	1	STEM SEAL	PTFE/GFT
8	5	GLAND PACKINGS	PTFE/GFT
9	1	GLAND	AISI 304/AISI 316
10	2	GLAND NUT	SS STEEL
11	1	WRENCH NUT	MS
12	1	EX: GLAND PACKINGS	GRAFOIL RING
13	1	WRENCH SLEEVE	P.V.C.
14	1	WRENCH	M.S. / SS
15	4/8	BODY STUDS & NUTS	SS 304/STEEL Cd. PLATED

ANSI 150#

SIZE NB	A	B	C	D	E	F	G
15	108	35	11	89	4	60	16
20	118	43	13	98	4	70	16
25	127	51	14	108	4	79	16
40	165	73	14	127	4	98	16
50	178	92	16	152	4	121	19
65	190	105	17	178	4	140	19
80	203	127	19	190	4	152	19
100	229	157	24	229	8	190	19
125	254	186	24	254	8	216	22
150	267	216	25	279	8	241	22
200	292	270	29	343	8	298	22

ANSI 300#

SIZE NB	A	B	C	D	E	F	G
15	140	35	14.2	95	4	66.6	16
20	152	43	15.8	117.5	4	82.5	19
25	165	51	17.5	124	4	59	19
40	191	73	21	156	4	114	22
50	216	92	22	165	8	127	22
65	241	105	25	190	8	149	22
80	282	127	29	209	8	168	22
100	305	157	32	254	8	200	22
125	381	186	35	279	8	235	22
150	403	216	37	318	12	270	22
200	419	270	41	381	12	330	25

ANSI 600#

SIZE NB	A	B	C	D	E	F	G
15	165	35	20.5	95	4	66.6	16
20	190	43	22.6	117.5	4	82.5	19
25	216	51	23.8	124	4	89	19
40	241	73	28.6	156	4	114.3	22
50	292	92	31.7	165	8	127	19
65	330	105	34.8	190	8	149	22
80	356	127	38.1	209	8	168	22
100	432	157	44.5	273	8	216	25.4
125	---	186	44.5	330	8	266.5	28.4
150	559	216	54.1	355.6	12	292.1	28.4
200	---	---	---	---	---	---	---

I-FLOW VALVES



AAIMA 3-PC DESIGN

Full bore, Screwed & Socket weld end ball valve in 150 & 300 class.

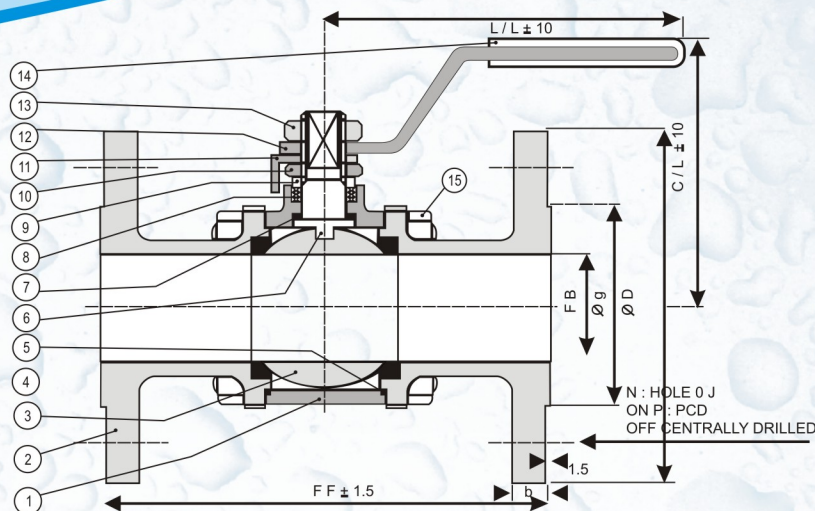

PARTS / MATERIALS LIST

Part No.	Qty.	NOMENCLATURE	MATERIAL
1	1	Body	ASTMA 351 Gr. CF8/CF8M CF3/CF3M
2	2	Body Connector	ASTMA 351 Gr. CF/8CF8M CF3/CF3M
3	1	Ball	-do-/AISI-304/316/304L/316L
4	1	Stem	AISI-304/316/304L/316L
5	2	Ball Seals	P.T.F.E.
6	2	Body Seals	P.T.F.E.
7	1	Stem Seals	P.T.F.E.
8	3	Gland Packings	P.T.F.E.
9	1	Gland	AISI-304/316/304L/316L
10	1	Gland Nut	SS-304/Steel
11	1	Stopper	SS-304/Steel Cd. Plated
12	1	Wrench	SS-304/Steel Cd. Plated
13	1	Wrench Nut	SS-304/Steel Cd. Plated
14	1	Wrench Sleeve	P.V.C.
15	4/8	Body Studs & Nuts	SS-304/Steel Cd. Plated

REPRESENTATIVE VALVE DIMENSIONS (Dimensions in mm)

SIZE	FB	F/F	70	L/L	Ø D	b	Ø g	P	N	Ø J
15	13	108	75	130	89	11.1	35	60.5	4	16
20	19	117	80	130	98.5	11.1	43	70	4	16
25	25	127	90	175	108	11.1	51	79.5	4	16
40	38	165	100	220	127	14.3	73	98.5	4	16
50	51	178	150	245	152.5	16	92	121	4	19
65	64	190	175	350	178	17.5	105	140	4	19
80	76	203	195	450	191	19	127	152.5	4	19
100	102	229		500	229	24	157	190.5	8	19

TEST PRESSURE (PSIG / Kg / Cm²)

CLASS	150	300
BODY	435/30.5	1100/77
SEAT	320/22.5	800/56
SEAT-AIR	100/7	

Product Range :
8 mm to 50 mm

- Construction : 3 pc. Full bore, blow-out proof stem, Floating ball, Soft seated, non fire safe design ball valve.
- Design & Mfg. std. : BS - 5351
- Inspection & Testing Std. : BS - 5146
- Face to Face : As per ANSI B-16.10
- End connection : Flanged as per ANSI B-16.5 RF

I-FLOW VALVES



AAIMA GLOBE VALVE

IC Screwed & Socket weld end globe valve in 150 & 300 class.

PARTS / MATERIALS LIST

Part No.	Nomenclature	MATERIAL
1	BODY	CAST IRON/WCB/CF8/CF8M
2	BONNET	CAST IRON/WCB/CF8/CF8M
3	PLUG	CA15/13% Cr. FACING ON WCB+STELLITED
4	SEAT RING 1	A 515-70/13 % Cr. STELLITED
5	BACK SEAT	T410/T304/T316
6	SPINDLE	T410/T304/T316
7	GLAND BUSH	T410/T304/T316
8	GLAND FLANGE	CARBON STEEL/WCB/S.S. 304
9	YOKE SLEEVE	ASTM 439 Gr. D2/AL-BRONZE
10	PLUG NUT	T410/T304/T316
11	CASING COVER	WCB/CF8/CF8M
12	GUIDE PLATE	CARBON STEEL
13	HAND WHEEL	MALLEABLE IRON/CAST IRON
14	HAND WHEEL NUT	CARBON STEEL
15	STUD & NUT	B7/2H/B16/7
16	EYE BOLT & NUT	B7/2H/B16/7
17	CASING STUD & NUT	B7/2H/B16/7
18	CROSS BOLT & NUT	B7/2H/B16/7
19	GASKET	SPW S.S. 304/316 WITH CAF
20	GLAND PACKING	GRAPHI.ASB.INHIB & INCONEL WIRE REIN./GRAPHOL
21	NAME PLATE	ALUMINIUM / SS
22	BEARING	STANDARD

Technical Data :

- Manufacturing Std. : BS 1873
- End Connection : Flanged as per ANSI B 16.5 RF/BS 1560
- Inspection & Testing Std. : API 589/BS 6755
- Fact to Face : AS per ANSI B 16.10

SERVICE RATING & TEST PRESSURE

CLASS	WORK PRESSURE	TEMP.	HYDRO TEST PRESS	
			BODY	SEAT
150#	150 PSIG	500% DF	425 PSIG	300 PSIG

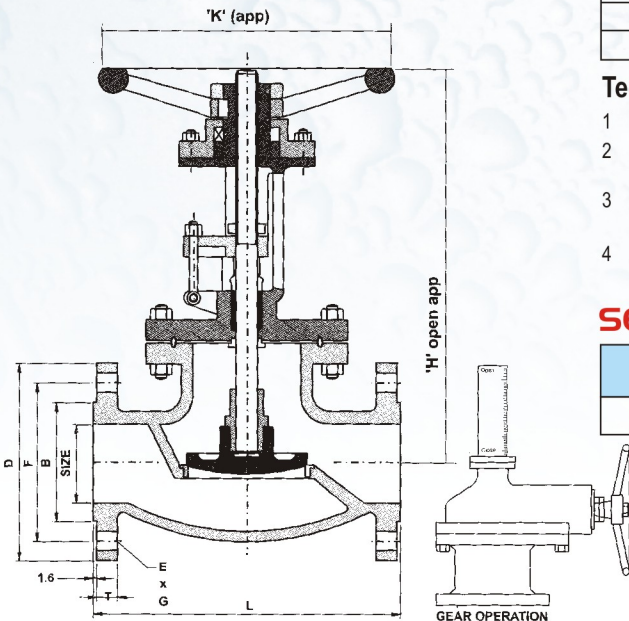

DIMENTION TABLE 150#

VALVE SIZE IN MM	50	65	80	100	125	150	200	250	300	350	400	450	500	550	600
L	8.0	8.5	9.5	11.5	14.0	16.0	19.5	24.5	27.5	31.0	36.0	38.5	38.5	42.0	51.0
	203	216	241	292	356	406	495	622	698	787	914	978	978	1067	1295
B	92	105	127	157	186	216	270	324	381	413	470	533	584	---	692
F	121	140	152	190	216	241	298	362	432	476	539.5	578	635	---	749.5
D	152	178	190	229	254	279	343	406	483	533	597	635	698	---	813
T	16	17	19	24	24	25	29	30.2	31.8	35	36.6	39.7	42.9	---	47.7
E	4	4	4	8	8	8	8	12	12	12	16	16	20	---	20
G	19	19	19	19	22	22	22	25	25	29	29	32	32	---	35
'H' (app)	320	330	380	480	525	575	650	780	935	1185	1250	1350	1410	1525	1650
'K' (app)	200	200	250	300	300	350	450	500	600	700	750	800	800	850	900
Wt. Kg app (F/E)	20	30	38	57	75	98	155	225	360	580	800	910	1100	1300	1450

I-FLOW VALVES



AAIMA GLOBE VALVE

IC Full bore, Screwed & Socket weld end globe valve in 150 & 300 class.



SERVICE RATING & TEST PRESSURE				
CLASS	WORKING PRESSURE	TEMP.	HYDRO TEST PRESS	
			BODY	SEAT
300#	300 PSIG	850%DF	1100 PSIG	800 PSIG
600#	600 PSIG	850%DF	2175 PSIG	1600 PSIG
900#	900 PSIG	850%DF	3250 PSIG	2380 PSIG
1500#	1500 PSIG	850%DF	5400 PSIG	3960 PSIG
2500#	2500 PSIG	850%DF	9275 PSIG	6780 PSIG

Technical Data :

Manufacturing Std : BS 1873

Testing and Inspection Std : API 589/BS 6755

Face to Face : As per ANSI B 16.10

End Connection : Flanged as per ANSI B 16.5 RF/BS 1560

DIMENTION TABLE 300#

VALVE SIZE IN MM	50	65	80	100	125	150	200	250	300	350	400	450	500	550	600
L	10.5	11.5	12.5	14.0	15.7	17.5	22.0	24.5	27.5	31.0	36.0	38.5	38.5	42.0	51.0
	267	292	318	356	400	444	559	622	698	787	914	978	978	1067	1295
B	92	105	127	157	186	216	270	324	381	413	470	533	584	---	692
F	127	149	168	200	235	270	330	387.5	432	476	539.5	578	635	---	749.5
D	165	190	209	254	279	318	381	---	483	533	597	635	698	---	813
T	22	25	29	32	35	37	41	---	31.8	35	36.6	39.7	42.9	---	47.7
E	8	8	8	8	8	12	12	---	12	12	16	16	20	---	20
G	22	22	22	22	22	22	25	---	25	29	29	32	32	---	35
'H' (app)	360	410	450	530	590	650	735	---	935	1185	1250	1350	1410	1525	1650
'K' (app)	200	250	300	350	400	450	600	---	600	700	750	800	800	850	900
Wt. Kg app (F/E)	30	45	60	95	125	150	235	---	360	580	800	910	1100	1300	1450

DIMENTION TABLE : GLOBE VALVE 600#

VALVE SIZE IN MM	50	65	80	100	125	150	200	250	300
L	11.5	13.0	14.0	17.0	20.0	22.0	26.0	31.0	33.0
	292	330	356	432	508	559	660	787	838
B	92	105	127	157	186	216	270	324	381
F	127	149	168	216	266.5	292.1	393.7	470	533.5
D	165	190	209	273	330	355.6	470	546	610
T	31.7	34.8	38.1	44.5	44.5	54.1	63.5	69.9	79.2
E	8	8	8	8	8	12	12	16	20
G	19	22	22	25.4	28.4	28.4	38	38	38
'H' (app)	400	425	490	635	685	740	975	1080	1230
'K' (app)	250	300	650	400	450	500	600	650	700
Wt. Kg app (F/E)	35	40	68	128	185	250	435	825	910

DIMENTION TABLE : BOLTED BONNET 1500#

VALVE SIZE IN MM	50	80	100	150	200
L	368	470	546	705	832
B	92	127	157	216	270
F	165	203	241.5	317.5	393.5
D	216	267	311	394	483
T	38.1	47.8	53.9	82.6	92
E	8	8	8	12	12
G	25	32	35	38	45
'H' (app)	548	750	865	1048	1188
'K' (app)	350	450	500	700	800
Wt. Kg app (F/E)	95	155	305	550	900

DIMENTION TABLE : BOLTED BONNET 900#

VALVE SIZE IN MM	50	80	100	150	200	250
L	368	381	457	610	737	838
B	92	127	157	216	270	324
F	165	190.5	235	317.5	393.7	470
D	216	241	292	381	470	546
T	38.1	38.1	44.5	55.6	63.5	69.9
E	8	8	8	12	12	16
G	25	25	32	32	38	38
'H' (app)	505	605	710	895	980	1150
'K' (app)	300	400	500	600	700	735
Wt. Kg app (F/E)	85	140	240	450	810	1150

DIMENTION TABLE : BOLTED BONNET 2500#

VALVE SIZE IN MM	50	80	100	150
L	451	578	673	914
B	92	127	157	216
F	171.5	228.5	273	368.5
D	235	305	256	483
T	50.8	66.5	76.2	108
E	8	8	8	8
G	29	35	41	54
'H' (app)	610	795	975	1080
'K' (app)	400	500	700	750
Wt. Kg app (F/E)	115	346	490	910

I-FLOW VALVES



AAIMA GATE VALVE

IC Full bore, Screwed & Socket weld end gate valve in 150 & 300 class.



PARTS / MATERIALS LIST

Part No.	DESCRIPTION	MATERIAL				
		WCB	WC6	A 352 LCB	CF8/CF8M	CF3/CF3M
1	BODY	WCB	WC6	A 352 LCB	CF8/CF8M	CF3/CF3M
2	BONNET	WCB	WC6	A 352 LCB	CF3/CF3M	CF3/CF3M
3	YOKE	WCB	WC6	A 352 LCB	CF3/CF3M	CF3/CF3M
4	WEDGE	CA15/13% Cr. FACING ON WCB+ STELLITED	Wc6+ STELLITED	LCB+ STELLITED	CF8/CF8M STELLITED	CF3/CF3M STELLITED
5	SEAT RING	A515-70/13%Cr. STELLITED	S.S.304 + STELLITED	S.S.304 + STELLITED	T304/T316L CF3/CF8M STELLITED	T304L/T316L CF3/CF8M STELLITED
6	BACK SEAT	AISI 410			INTEGRAL	INTEGRAL
7	SPINDLE	AISI 410			T304/T316	T304/T316
8	GLAND BUSH	AISI 410			T304/T316	T304/T316
9	GLAND FLANGE	WCB	WC6	LCB	S. S. 304	S. S. 304L
10	YOKE SLLEVE	Ni-Resisit/S.G. Iron				
11	HAND WHEEL	CARBON STEEL				
12	HAND WHEEL NUT	CARBON STEEL			S. S. 304	S.S.304L/316L
13	STUD & NUT	B7/2H	B16/7	B16/7	B7/2H	B7/2H
14	EYE BOLT & NUT	B7/2H			B8/8	B8/8M
15	CROSS BOLT & NUT	B7/2H			B8/8	B8/8M
16	GASKET	COMPRESSEED ASBESTOS FIBRE/S.S. 304 SPRIAL WOUND WITH CAF				
17	GLAND PACKING	METALLIC WIRE REINFORCED GRAPHITED ASBESTOS/GRAPHOIL				
18	GREASE NIPPLE	BRASS/STEEL				
19	NAME PLATE	ALUMINIUM / SS				
20	BEARING	STANDARD				

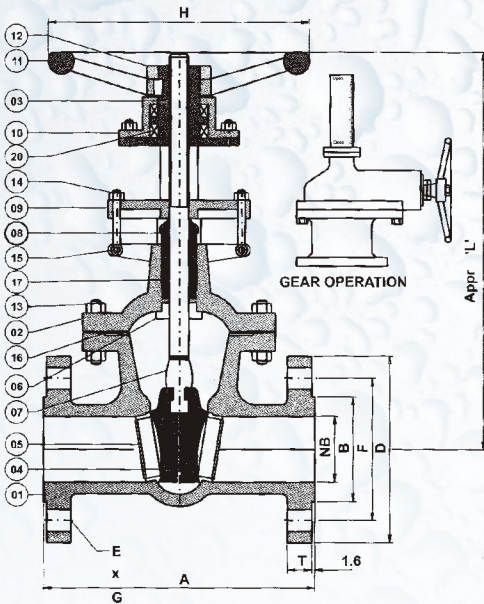

TEST PRESSURE				
CLASS	HYDROSTATIC		PENUMATIC TEST	WORKING
	BODY	SEAT & BACK SEAT		TEMP.
150	30 Kg/cm ²	22 Kg/cm ²	7 Kg/cm ²	500 F ^o Max.

DIMENTION TABLE 150#

SIZE	25	40	50	65	80	100	125	150	200	250	300	350	400	450	500	550	600	650	700	750
'A'	165	165	178	190.5	203	229	254	267	292	330	356	380	406.5	432	457	457	483	508	559	610
B	51	73	92	105	127	157	186	216	270	324	381	413	470	533	584	584	---	692	---	---
F	79.2	98.5	121	140	152	190	216	241	298	362	432	476	539.5	578	635	635	---	749.5	---	---
D	108	127	152	178	190	229	254	279	343	406	483	533	597	635	698	698	---	813	---	---
T	14	16	16	17	19	24	24	25	29	30.2	31.8	35	36.6	39.7	42.9	42.9	---	47.7	---	---
E	4	4	4	4	4	8	8	8	8	12	12	12	16	16	20	20	---	20	---	---
G	16	16	19	19	19	19	22	22	22	25	25	29	29	32	32	32	---	35	---	---
'H'	152	152	203	203	254	254	305	305	305	408	457	457	508	508	610	610	660	660	711	711
'L'	330	330	360	415	425	510	595	685	770	940	1030	1270	1450	1600	1810	1810	2725	2725	2800	3130
Wt. Kg.	---	---	20	28	33	55	70	90	130	225	330	450	530	625	825	825	1210	1210	1415	1620

DIMENTION TABLE - GATE VALVE 300#

VALVE SIZE IN MM	50	65	80	100	125	150	200	250	300	350	400	450	500	550	600
'A'	216	241	282.5	305	381	403	419	457	502	762	838	914	991	1092	1143
B	92	105	127	157	186	216	270	324	381	413	471	533	584	---	692
F	127	149	168	200	235	270	330	387.5	451	514.5	571.5	628.5	686	---	813
D	165	190	209	254	279	318	381	444	521	584	648	711	775	---	914
T	22	25	29	32	35	37	41	47.7	50.8	54	57.2	60.4	63.5	---	69.9
E	8	8	8	8	8	12	12	16	16	20	20	24	24	---	24
G	22	22	22	22	22	22	25	29	32	32	35	35	35	---	41
'L' (app)	410	450	485	615	725	835	1015	1230	1555	1720	1970	2160	2410	2550	2810
'H' (app)	200	250	250	300	350	350	450	500	500	600	600	680	760	760	760
Wt. Kg. (app) (F/E)	32	35	55	80	100	150	225	350	480	745	1060	1325	1725	1900	2570



AAIMA SWING CHECK VALVE

IC Full bore, Screwed & Socket weld end swing check valve in 150 & 300 class.

PARTS / MATERIALS LIST

Part No.	DESCRIPTION	MATERIAL		
1	BODY	WCB	WC6	CF8/CF8M
2	DISC	CA15/13% Cr. FACING ON WCB	CA 15/13% Cr.	CF8/CF8M
3	SEAT RING	A 515-70/13% Cr +STELLITED	SS 304+ STELLITED	T304/T316+ STELLITED
4	TOP COVER	WCB B7/2H	WC6	CF8/CF8M
5	STUD & NUT	B7/2H	B16/7	B8/8
6	GASKET	B8/8		
7	BRACKET STUD & NUT	SPW S.S. 304/16 WITH CAF		
8	WASHER	T 410	T304	T316
9	DISC NUT	Gr. 8		
10	HINGE PIN	T 410	T304	T316
11	NAME PLATE	ALUMINIUM / SS		
12	HINGE	WCB/Gr. 70	WC6/CF8	CF8/CF8M
13	LIFTING EYE BOLT	ASTM A 105		

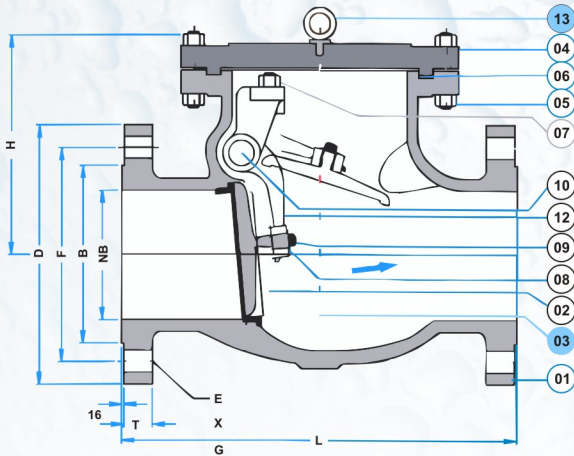

TEST PRESSURE				
CLASS	HYDROSTATIC		PENUMATIC TEST	WORKING
	BODY	SEAT & BACK SEAT		TEMP.
150	30 Kg/cm ²	22 Kg/cm ²	7 Kg/cm ²	500 F ^o Max.
300	1100 PSIG	800 PSIG	7 Kg/cm ²	850 F ^o Max.

Technical Data :

Manufacturing Std. : BS 1868

Testing and Inspection Std : API 6D

End Connection : Flanged as per ANSI B 16.5 RF

- Seat Weld 8 and above
- Lifting Eye Bolt 6 NB and above
- Disc Stelling Optional

DIMENTION TABLE - SWING CHECK VALVE 150#

SIZE	50	65	80	100	125	150	200	250	300	350	400	450	500	550	600	650	700	750
L	203	206	241	292	330	356	495	622	698	787	864	978	978	1067	1295	1295	1488	1524
B	92	105	127	157	186	216	270	324	381	413	470	533	584	---	692	---	---	---
F	121	140	152	190	216	241	298	362	432	476	539.5	578	635	---	749.5	---	---	---
D	152	178	190	229	254	279	343	406	483	533	597	635	698	---	813	---	---	---
T	16	17	19	24	24	25	29	30.2	31.8	35	36.6	39.7	42.9	---	47.7	---	---	---
E	4	4	4	8	8	8	8	12	12	12	16	16	20	---	20	---	---	---
G	19	19	19	19	22	22	22	25	25	29	29	32	32	---	35	---	---	---
'H' (app)	145	165	170	205	225	255	300	340	480	590	595	545	600	695	750	775	800	825
Wt. Kg. app (F/E)	18	25	32	52	56	92	136	220	345	485	570	770	1055	1255	1325	1500	1650	1865

DIMENTION TABLE - SWING CHECK VALVE 300#

VALVE SIZE IN MM	50	65	80	100	125	150	200	250	300	350	400	450	500
L	267	292	318	356	400	444	533	622	711	838	864	978	1016
B	92	105	127	157	186	216	270	324	381	413	470	533	584
F	127	149	168	200	235	270	330	387.5	451	514.5	571.5	628.5	686
D	165	190	209	254	279	318	381	444	521	584	648	711	775
T	22	25	29	32	35	37	41	47.7	50.8	54	57.2	60.4	63.5
E	8	8	8	8	8	12	12	16	16	20	20	24	24
G	22	22	22	22	22	22	25	29	32	32	35	35	35
'H' (app)	155	215	185	220	245	275	300	375	430	520	560	686	610
Wt. Kg app (F/E)	25	40	60	80	105	130	215	345	470	685	998	1050	1220

I-FLOW VALVES



AAIMA SWING CHECK VALVE

IC Full bore, Screwed & Socket weld end swing check valve in 150 & 300 class.



TEST PRESSURE				
CLASS	HYDROSTATIC		PENUMATIC TEST	WORKING
	BODY	SEAT & BACK SEAT		TEMP.
600	2175 PSIG	1600 PSIG	7 Kg/cm ²	500 F ^o Max.
900	3250 PSIG	3280 PSIG	7 Kg/cm ²	500 F ^o Max.
1500	6400 PSIG	3960 PSIG	7 Kg/cm ²	500 F ^o Max.
2500	9275 PSIG	6780 PSIG	7 Kg/cm ²	500 F ^o Max.

Technical Data :

Manufacturing Std. : BS 1868

Testing and Inspection Std : API 6D

End Connection : Flanged as per ANSI B 16.5 RF

- Seat Weld 8 and above
- Lifting Eye Bolt 6 NB and above
- Disc Stellite Optional

DIMENTION TABLE - SWING CHECK VALVE 600#

SIZE	50	65	80	100	125	150	200	250	300	350	400
L	292	330	356	432	508	559	660	787	838	889	991
B	92	105	127	157	186	216	270	324	381	413	470
F	127	149	168	216	266.5	292.1	393.7	470	533.5	527	603
D	165	190	209	273	330	355.6	471	546	610	603	686
T	31.7	34.8	38.1	44.5	44.5	54.1	63.5	69.9	79.2	69.9	76.2
E	8	8	8	8	8	12	12	16	20	20	20
G	19	22	22	25.4	28.4	28.4	38	38	38	38	41
'H' (app)	160	260	230	280	290	330	360	475	555	580	665
Wt. Kg. app (F/E)	29	55	65	115	145	250	405	620	815	970	1215

DIMENTION TABLE - SWING CHECK VALVE 900#

SIZE	50	80	100	150	200	250	300	350	400
L	368	381	457	610	737	838	965	1029	1130
B	92	127	157	216	270	324	381	413	470
F	165	190.5	235	317.5	393.7	470	533.5	559	616
D	216	241	292	381	470	546	610	641	705
T	38.1	38.1	44.5	55.6	63.5	69.9	79.2	85.9	88.9
E	8	8	8	12	12	16	20	20	20
G	25	25	32	32	38	38	38	41	45
'H' (app)	220	280	350	450	525	600	675	750	825

DIMENTION TABLE - SWING CHECK VALVE 1500#

SIZE	50	80	100	150	200	250	300
L	368	381	546	705	832	991	1130
B	92	127	157	216	270	324	381
F	165	190.5	241.5	317.5	393.5	482.5	571.5
D	216	241	311	394	483	584	673
T	38.1	38.1	53.9	82.6	92	108	124
E	8	8	8	12	12	12	16
G	25	25	35	38	45	51	54
'H' (app)	220	280	370	450	600	660	750

DIMENTION TABLE - SWING CHECK VALVE 2500#

SIZE	50	80	100	150	200
L	451	578	673	914	1022
B	92	127	157	216	270
F	171.5	228.5	273	368.5	438
D	235	305	256	483	552
T	50.8	66.5	76.2	108	127
E	8	8	8	8	12
G	29	35	41	54	54
'H' (app)	305	390	415	565	640

I-FLOW VALVES



AAIMA S.S. BAR STOCK GLOBE VALVE

BAR STOCK Screwed & Socket weld end Victolik end

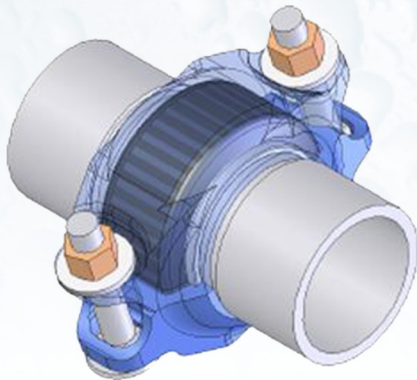
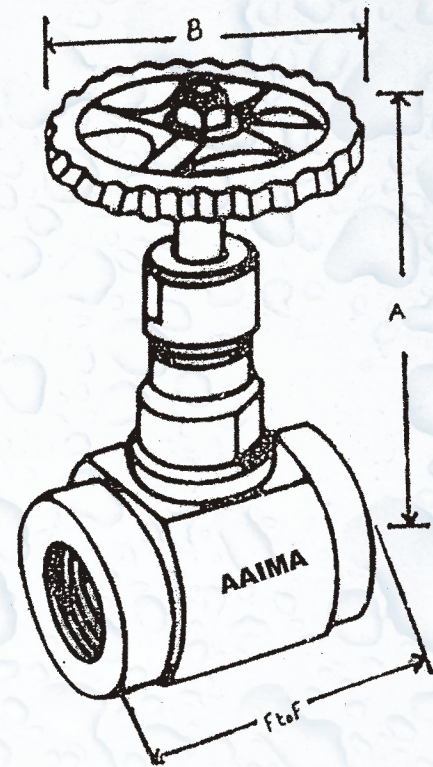

2x fillet 0.010" min - 0.015" max
(0.25 mm min - 0.38 mm max)

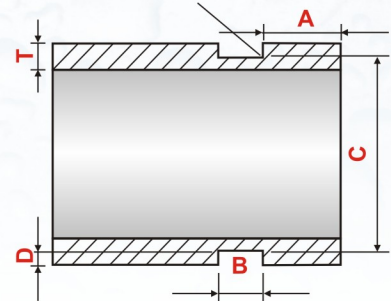

Technical Data :

Material of Construction : SS-2205 (Duplex)/304/316 OR AS PER YOUR REQUIREMENT GUARANTEED MATERIAL

Pressure Testing : SEAT - 450 PSI
BODY - 550 PSI

Ends Connection : SCREWED END / SOCKET WELD / TABLE
E' & F' ASA 150 IS REQUIRED
VICTOLIK

SIZE in Each	1/4 "	3/8"	1/2"	3/4"	1"	1.1/4"	1.1/2"	2"	2.1/2"	3"	4"
F to F S/E	60	63	70	80	90	100	120	135	150	180	
A	-	95	105	125	135	155	165	185	235	-	
B	-	65	68	75	83	96	120	140	140	-	
F to F Flange	-	90	95	100	115	120	130	150	165	175	
Victolik	-	95	95	110	130	130	150	195	210	-	



AAIMA GROOVED & VICTOLIK COUPLING

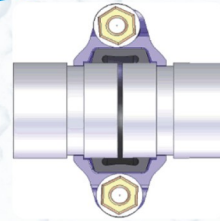

IMPORTANT

2x fillet 0.010" min - 0.015" max
(0.25 mm min - 0.38 mm max)

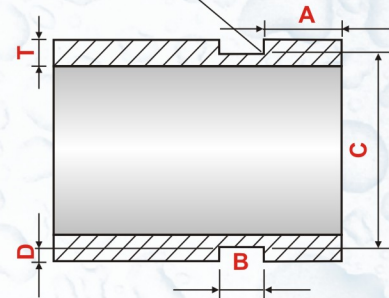

Standard Cut-Groove Specification

Standard Cut Groove Pipe Specification For Flexible Couplings

Nominal Size	Tolerance for Outer Diameter of Pipe			Gasket Seat "A"	Groove Width "B"	Groove Dia C		Groove Depth "D" (Info)	Min. Wall Thickness "T"
	Basic OD inches	Tol (+) inches	Tol (-) inches			Basic inches	Tol (+0.00) inches		
3/4	1.050	0.010	0.010	0.625	0.313	0.938	-0.015	0.056	0.113
1	1.315	0.013	0.013	0.625	0.313	1.190	-0.015	0.063	0.133
1-1/4	1.660	0.016	0.016	0.625	0.313	1.535	-0.015	0.063	0.140
1-1/2	1.900	0.019	0.019	0.625	0.313	1.775	-0.015	0.063	0.145
2	2.375	0.024	0.024	0.625	0.313	2.250	-0.015	0.063	0.154
2-1/2	2.875	0.029	0.029	0.625	0.313	2.72	-0.018	0.078	0.188
3	3.500	0.035	0.031	0.625	0.313	3.344	-0.018	0.078	0.188
4	4.500	0.045	0.031	0.625	0.375	4.334	-0.020	0.083	0.203
6	6.625	0.062	0.031	0.625	0.375	6.455	-0.022	0.085	0.219
8	8.625	0.062	0.031	0.750	0.438	8.441	-0.022	0.092	0.238
10	10.750	0.062	0.031	0.750	0.500	10.562	-0.027	0.094	0.250
12	12.750	0.062	0.031	0.750	0.500	12.531	-0.030	0.109	0.279
16	16.000	0.062	0.031	0.938	0.500	15.781	-0.030	0.109	0.312

Standard Cut Groove Pipe Specification For Flexible Couplings

Nominal Size	Tolerance for Outer Diameter of Pipe			Gasket Seat "A"	Groove Width "B"	Groove Dia C		Groove Depth "D" (Info)	Min. Wall Thickness "T"
	Basic OD mm	Tol (+) mm	Tol (-) mm			Basic mm	Tol (+0.00) mm		
3/4	26.70	0.25	0.25	15.88	7.95	23.83	-0.38	1.42	2.87
1	33.40	0.33	0.33	15.88	7.95	30.28	-0.38	1.60	3.38
1-1/4	42.20	0.41	0.41	15.88	7.95	38.99	-0.38	1.60	3.56
1-1/2	48.30	0.48	0.48	15.88	7.95	45.09	-0.38	1.60	3.68
2	60.30	0.61	0.61	15.88	7.95	57.15	-0.38	1.60	3.91
2-1/2	73.00	0.74	0.74	15.88	7.95	69.09	-0.46	1.98	4.78
3	88.90	0.89	0.79	15.88	7.95	84.94	-0.46	1.98	4.78
4	114.30	1.14	0.79	15.88	9.53	110.08	-0.51	2.11	5.16
6	168.30	1.60	0.79	15.88	9.53	163.96	-0.56	2.16	5.56
8	219.10	1.60	0.79	19.05	11.13	214.40	-0.64	2.34	6.05
10	273.00	1.60	0.79	19.05	12.70	268.28	-0.69	2.39	6.35
12	328.90	1.60	0.79	19.05	12.70	318.29	-0.76	2.77	7.09
16	406.40	1.60	0.79	23.83	12.70	400.84	-0.76	2.77	7.93

Column Notes :

Gasket Seat "A" : must be smooth and free of indentations, roll marks, scratches, imperfections and projections from the end of the pipe to the groove in order to provide a proper sealing surface. Dimension 'A' to be measured from square-cut end of pipe. Beveled end pipe not recommended.

Groove Width "B" : The bottom of the groove to be free of dirt, chips etc. that may interfere with coupling assembly. See radius notes on drawing above.

Groove Depth "D" : Must be of uniform depth for the entire pipe circumference and must be maintained within the 'C' dimension tolerance listed.

Min. Wall Thickness "T" : For information only. Actual dimensions must be per groove diameter 'C'.

Notes :

1. Pipe ends to be square cut and shall be neat and free from imperfections that may affect durability, operability and safety.
2. Metal shall be free from fins, burrs and sharp / rough edges, flame cutting is not permitted.
3. Break all corners 0.01 - 0.03 in. chamfer unless otherwise specified.
4. In the event of a conflict between these notes and references cited in the drawings, except for detail specifications, these notes shall take precedence.



AAIMA DOUBLE FLANGE ROTARY BUTTERFLY VALVE

LUG TYPES



MATERIAL SPECIFICATION

Part No.	DESCRIPTION	MATERIAL
1	BODY	ASTM A 216 Gr WCB/ A 351 Gr CF8M
2	DISC	ASTM A 216 Gr WCB Or A 105/ A 351 Gr CF8M or F316
3	SEAL RING	UNS S3 1803 (DUPLEX)+GRAPHITE
4	SHAFT	ASTM A 182 F6A/A 479 TYPE XM19 (UNS S20910)
5	PACKING	GRAPHITE
6	BOTTOM FLANGE	ASTM A 516 / A 240 TYPE 316
7	THRUST BEARING	AISI 316 OR AISI 410 / UNS S20910
8	BEARING	AISI 304 / AISI 316 HARD FACED
9	BRACKET	CARBON STEEL

Technical Data :

Manufacturing Std. : ISO 5752/BS 5155/API 609 with wafer construction

Testing and Inspection Std : API 598/BS 5155

Leak Rate : Bubble Tight shut off ANSI Class VI or better.

Top Flange : Crilling as per ISO 5211

Mounting Flanges : ANSI Class 150, DIN PN 10, PN 16,
BS 4504 T10/16, IS 6392T11/17, BS 10TD,E,F,JIS 5K, 10K

Material : IS 210, DIN, ASTM

DIMENSION TABLE - ANSI

SIZE NB	A	B	C	D	WEIGHT	
					VALVE	GEAR OPERATOR
80	340	125	298	114	22	29
100	370	141	328	127	28	35
150	410	165	368	140	40	47
200	475	214	424	152	61	72
250	515	243	464	165	83	94
300	592	286	539	178	127	140
350	627	312	574	190	166	179
400	670	350	600	216	198	228
450	705	383	635	222	229	259
500	765	407	695	229	308	338
600	845	484	750	267	433	479
700	1080	525	106	292	767	922
750	1118	615	1044	318	990	1145
800	1143	640	1069	318	1165	1320
900	1305	672	1231	330	1495	1760
1000	1315	741	1241	410	2035	2300
1050	1385	755	1311	410	2155	2420
1200	1652	866	1460	470	3045	3690
1350	1765	985	1573	530	4300	4945
1500	1892	1132	1693	600	5740	6535

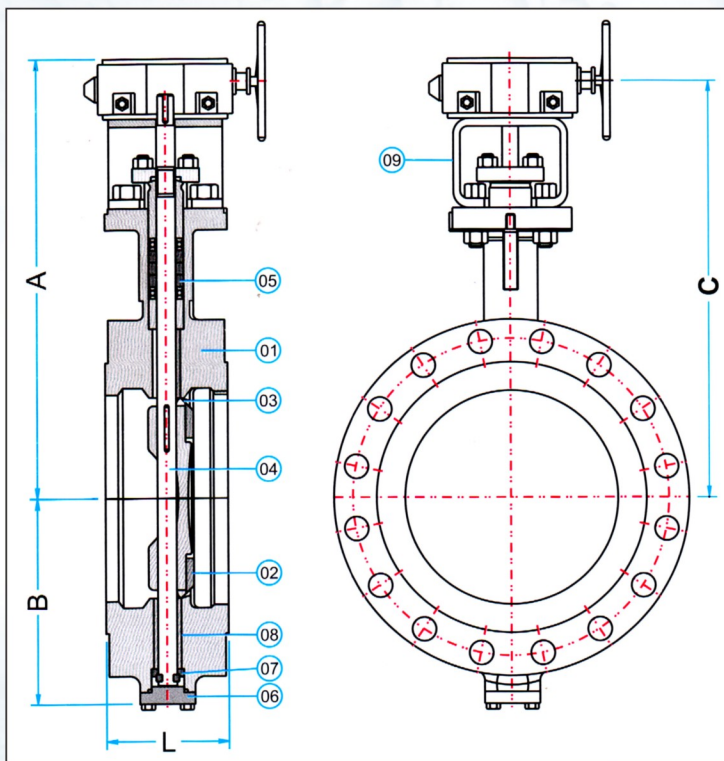

VALVE SPECIFICATIONS

PRESSURE	PN6, PN 10, PN 16
TEMPERATURE	-20°C to 180°C
OPERATING	BI-DIRECTIONAL
PAINTING	EPOXY COATING



AAIMA 1-PC DESIGN

Full bore, Screwed & Socket weld end ball valve in 150 & 300 class.

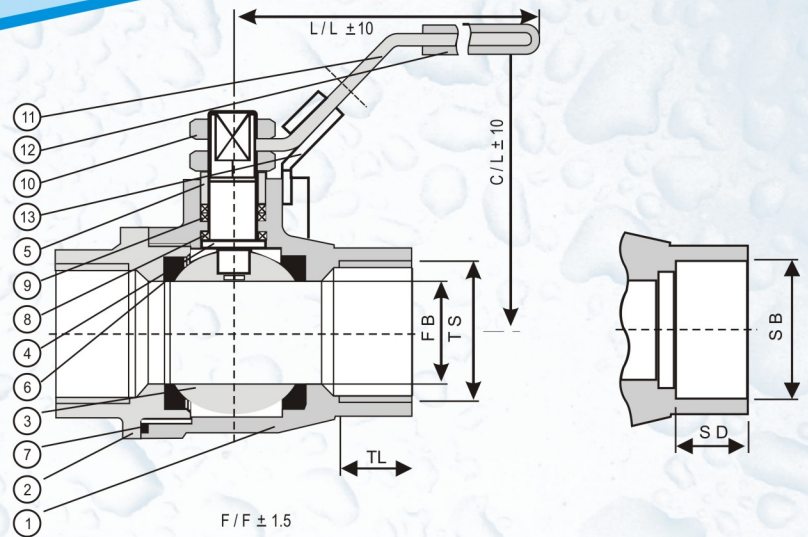

PARTS / MATERIALS LIST

Part No.	Qty.	NOMENCLATURE	MATERIAL
1	1	Body	ASTMA 351 Gr. CF8/CF8M CF3/CF3M
2	1	Body Connector	ASTMA 351 Gr. CF/8CF8M CF3/CF3M
3	1	Ball	-do-/AISI-304/316/304L/316L
4	1	Stem	AISI-304/316/304L/316L
5	1	Gland	AISI-304/316/304L/316L
6	2	Ball Seals	P.T.F.E.
7	1	Body Seals	P.T.F.E.
8	1	Stem Packing	P.T.F.E.
9	2	Gland Packings	P.T.F.E.
10	1	Stem Nut	SS-304/Steel
11	1	Wrench	SS-304/Steel Cd. Plated
12	1	Wrench Sleeve	P.V.C.
13	1	Locking Clip	SS-304/Steel

Product Range :
8 mm to 50 mm

- | | | | |
|---|------------------------------|---|--|
| 1 | Construction | : | 1 pc. Full bore, blow-out proof stem, Floating ball, Soft seated, non fire safe design ball valve. |
| 2 | Design & Mfg. std. | : | BS - 5351 |
| 3 | Inspection & Testing Std. | : | BS - 5146 |
| 4 | Face to Face | : | As Shwon |
| 5 | End connection
a. Screwed | : | B.S.P.-parallel Thd's
B.S.P.T. Taper Thd's
N.P.T. - Taper Thd's |
| 6 | Socket Weld | : | As per ANSI B 16,11 |

OPTIONS :

1. Other material on request
2. 300 class Valves on request
3. Hollow Ball on request
4. Pneumatic operation on request.

REPRESENTATIVE VALVE DIMENSIONS (Dimensions in mm)

SIZE	FB	F/F	C/L	L/L	TS	TL	SB	SD
8	10	52	45	110	1/4"	10.21	14.4	10
10	10	52	45	110	3/8"	10.36	17.8	10
15	13	65	50	110	1/2"	13.56	21.8	10
20	19	70	65	130	3/4"	13.87	27.4	13
25	24	85	75	155	1"	17.35	34.1	13
32	31	92	90	170	1 1/4"	17.95	42.6	13
40	37	100	95	170	1 1/2"	18.38	49	13
50	50	120	100	170	2"	19.23	61	16

TEST PRESSURE (PSIG / Kg / Cm²)

TEST PRESSURE		
TESTING	BODY	SEAT
HYDRAULIC	435 PSIG	320 PSIG
PNEUMATIC	-----	100 PSIG

I-FLOW VALVES



AAIMA BUTTERFLY VALVE



PARTS / MATERIALS LIST

Part No.	DESCRIPTION	MATERIAL
1	BODY	C.I., C.S., S.G., IRON, CF8/CF8M
2	DISC	C.I., C.S., S.G. IRON, CF8/CF8M DISC ENCAPSULATION WITH VITON NITRILE, EPDM, NEOPRENE AND HYPALON AVAILABLE EPOXY COATED, NYLON-II COATED
3	SEAT	NITRILE, EPDM, VITON, SILICONE, HYPALON, NEOPRENE, PTFE
4	SHAFT	AISI 304/316/410/420
5	BEARING	GM + STEEL + PTFE
6	O-RING	NITRILE, EPDM, VITON, SILICONE
7	TAPER PIN	AISI 304/316
8	PLUG	STEEL
9	BUSH	POLYACETAL/PTFE

DIMENSION TABLE - BUTTERFLY VALVE

DN (MM)	A	B	C	D	WEIGHT
40	40	33	33	103	3
50	50	43	43	113	4
65	65	46	46	121	4.5
80	80	46	46	128	5
100	100	52	52	146	6
125	125	56	56	158	8
150	150	56	56	174	11
200	200	60	60	198	14
250	250	68	68	245	24
300	300	78	78	270	29
350	336	78	78	312	38
400	386	102	102	360	64
450	336	114	114	390	75
550	486	127	127	410	97
600	586	154	154	490	135
650	636	165	165	525	160
700	686	165	165	550	215
750	736	178	178	575	258
800	786	190	190	600	270
850	836	190	190	625	295
900	886	203	203	700	382
1000	988	216	216	750	485
1050	1036	216	216	775	507
1100	1086	254	254	800	618
1200	1186	254	254	850	697

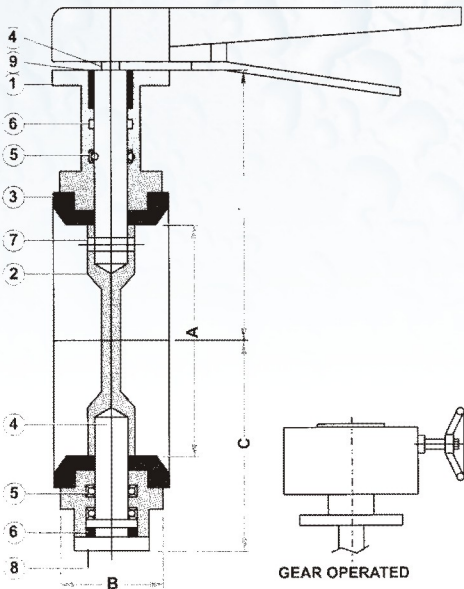

Technical Data :

Manufacturing Std.	: ISO 5752/BS 5155/API 609 with wafer construction
Testing & Inspection Std.	: API 598/Bs 5155
Leak Rate	: Bubble Tight shut off ANSI Class VI or better.
Top Flange	: Crilling as per ISO 5211
Mounting Flanges	: ANSI Class 150, DIN PN 10, PN 16, BS 4504 T 10/16, IS 6392T11/17, BS 10TD, E,F,JIS 5 K, 10K
Material	: IS 210, DIN, ASTM

VALVE SPECIFICATION

HYDROSTATIC	PN6, PN 10, PN 16
TEMPERATURE	-20°C TO 180°C
OPERATING	BI-DIRECTIONAL
PAINTING	EPOXY COATING



AAIMA WAFER CHACK VALVE



MATERIAL SPECIFICATION

Part No.	DESCRIPTION	MATERIAL
1	BODY	CAST IRON (IS 210 FG 200)
		CAST STEEL (ASTM A 216 GR WCB)
		STAINLESS STEEL (ASTM A 351 CF8/CF 8M)
2	CLAPPER	CAST IRON (IS 210 FG 200)
		CAST STEEL (ASTM A 351 CF8/CF 8M)
3	CLAPPER PIN	AISI 304 / 316
4	CLAPPER SEAL	NIRTIILE, EPDM, VITON, SILICON, PTFE
5	BODY SEAL	NIRTIILE, EPDM, VITON, SILICON, PTFE
6	LIFTING EYE	M.S.

Technical Data :

Manufacturing Std. : API 600

Testing and Inspection Std : API 598

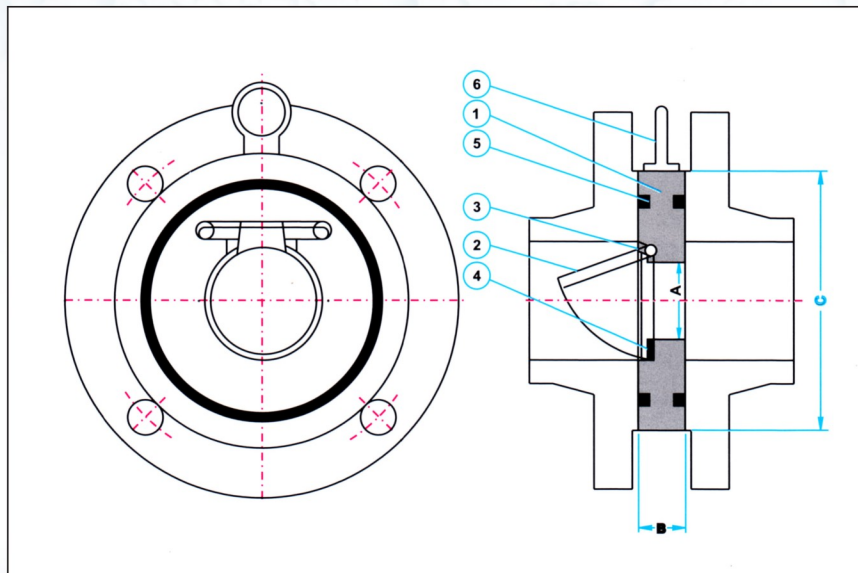

DIMENSION TABLE

NB	50	65	80	100	125	150	200	250	300	350	400	450	500	600	1000
A	30	40	52	71	93	114	157	195	230	270	310	360	406	490	910
B	19	19	19	19	19	19	28	28	38	41	51	51	60	70	180
C	109	129	144	164	194	220	275	330	380	440	541	541	596	698	1200



AAIMA FILTER

filter 150 & 300 class.



SELF CLEANING FILTER - I MATERIAL SPECIFICATION

Part No.	Qty.	DESCRIPTION	MATERIAL
1	01	BODY	C.I / C.S. / AISI 304 / 316
2	01	BOUL	C.S. / AISI 304/316
3	---	SCREPAR	C.S. / AISI 304/316
4	01	SCREEN	C.I / C.S. / AISI 304 / 316
5	01	SPINDLE	AISI 304/306
6	01	DRAIN	C.S. / AISI 304/316
7	01	VENT	C.S. / AISI 304/316
8	01	HANDLE	C.S. / AISI 304/316

Technical Data :

STD. Specification Required With Enquiry.

1. Intel Outlet Size & Rating
2. Fluid To Be Handled
3. Viscosity of fluid.
4. Fluid temp.
5. Degree of Filtration
6. Working Pressure
7. Allowable Pressure drop
8. Material of Construction
9. Qty. of Strainer required.

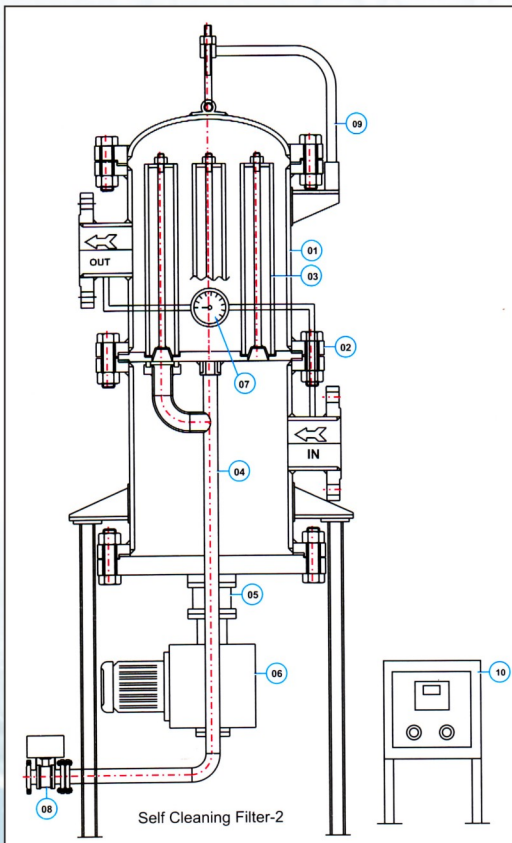
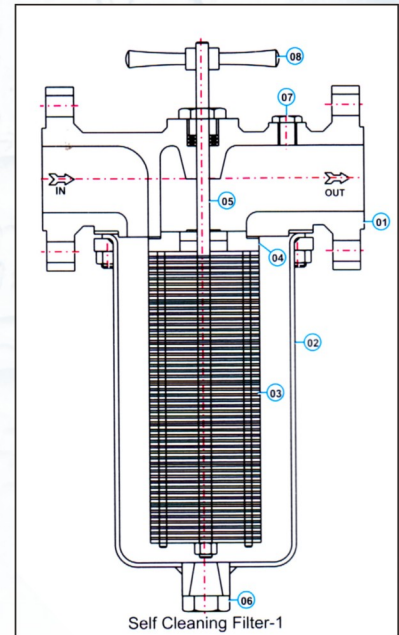

SELF CLEANING FILTER - 2 MATERIAL SPECIFICATION

Part No.	Qty.	DESCRIPTION	MATERIAL
1	02	SHELL	C.S. / AISI 304 / 316
2	08	FLANGE	C.S. / AISI 304 / 316
3	---	WQEDGE WIRE CYLINDER	C.S. / AISI 304 / 316
4	01	SHAFT	C.S. / AISI 304 / 316
5	01	MECHANICAL SEAL	STAINLESS STEEL
6	01	ELECTRIC MOTOR	C.I. / C.S.
7	01	DIFFE. GAUGE	STD
8	01	BACK WASH VALVE	C.I. / C.S. / AISI 304 / 316
9	01	DEVIT	C.S. / AISI 304 / 316
10	01	ELECTRIC BOARD	STD

I-FLOW VALVES



AAIMA FILTER

filter 150 & 300 class.

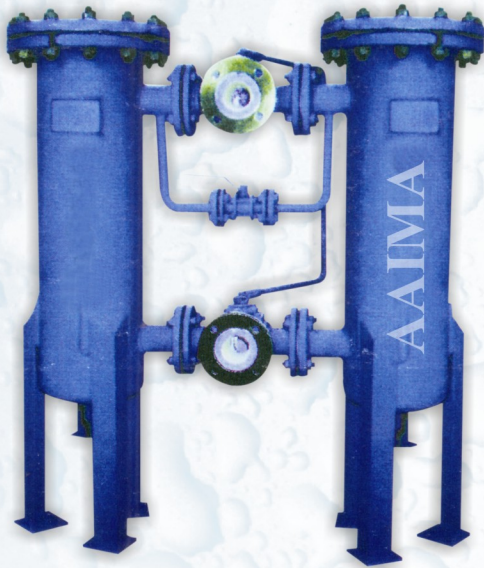

SIMPLEX BASKET / CARTRIDGE FILTER MATERIAL SPECIFICATION

Part No.	Qty.	DESCRIPTION	MATERIAL
1	01	SHELL	IS 2062 GR.A / AISI 304/316
2	01	SHELL FLANGE	IS 2062 GR.A / AISI 304/316
3	01	COVER FLANGE	IS 2062 GR.A / AISI 304/316
4	02	IN/OUT NOZZLE	IS 1239 3589, / SA 106 GR.B / AISI 304/316
5	02	IN/OUT FLANGE	IS 2062 GR.A / SA 105 / AISI 304/316
6	01	DISHEND	IS 2062 GR.A / AISI 304/316
7	01	P.SHEET	AISI 304/316
8	01	WIRE MESH	AISI 304/316
9	01	SUPPORT PLATE	IS 2062 GR.A / AISI 304/316
10	01	ELEMENT TOP COVER	IS 2062 GR.A / AISI 304/316
11	01	ELEMENT BOTTOM	IS 2062 GR.A / AISI 304/316
12	16	FASTENERS	SA 193 GR. b7-2H / AISI 304/316
13	02	DRAIN CPLG+PLUG	IS 2062 GR.A / AISI 304/316
14	02	VENT CPLG+PLUG	IS 2062 GR.A / AISI 304/316
15	06	LAG	IS 2062 GR.A / AISI 304/316
16	06	BASE PAD	IS 2062 GR.A / AISI 304/316
17	04	HANDLE	IS 2062 GR.A / AISI 304/316

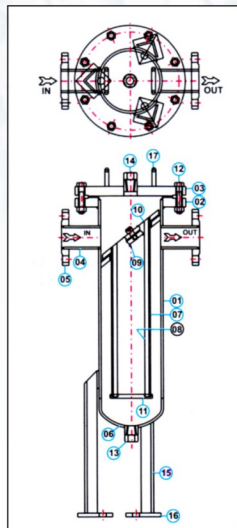

DUPLEX BASKET FILTER MATERIAL SPECIFICATION

Part No.	Qty.	DESCRIPTION	MATERIAL
1	02	SHELL	IS 2062 GR.A / AISI 304/316
2	02	SHELL FLANGE	IS 2062 GR.A / AISI 304/316
3	02	COVER FLANGE	IS 2062 GR.A / AISI 304/316
4	04	IN/OUT NOZZLE	IS 1239 3589, / SA 106 Gr.B / AISI 304/316
5	04	IN/OUT FLANGE	IS 2062 Gr.A / SA 105 / AISI 304/316
6	02	DISHEND	IS 2062 Gr.A / AISI 304/316
7	02	P.SHEET	AISI 304/316
8	02	WIRE MESH	AISI 304/316
9	02	SUPPORT PLATE	IS 2062 Gr.A / AISI 304/316
10	02	ELEMENT TOP COVER	IS 2062 Gr.A / AISI 304/316
11	02	ELEMENT BOTTOM	IS 2062 Gr.A / AISI 304/316
12	02	TIE ROD	IS 2062 Gr.A / AISI 304/316
13	16	FASTENERS	SA 193 Gr. b7-2H / AISI 304/316
14	16	FASTENERS	SA 193 Gr. b7-2H / AISI 304/316
15	02	3-WAY BALL VALVE	WCB/Cast Iron / AISI 304/316
16	02	DRAIN CPLG+PLUG	IS 2062 Gr.A / AISI 304/316
17	02	VENT CPLG+PLUG	IS 2062 Gr.A / AISI 304/316
18	06	LAG	IS 2062 Gr.A / AISI 304/316
19	06	BASE PAD	IS 2062 Gr.A / AISI 304/316
20	04	HANDLE	IS 2062 Gr.A / AISI 304/316

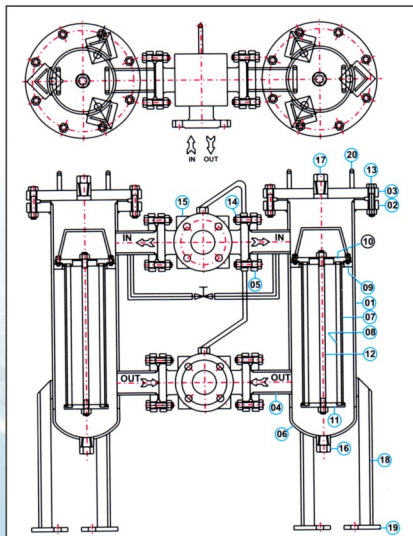

Technical Data :

STD. Specification Required With Enquiry.

1. Intel Outlet Size & Rating
2. Fluid To Be Handled
3. Viscosity of fluid.
4. Fluid temp.
5. Degree of Filtration
6. Working Pressure
7. Allowable Pressure drop
8. Material of Construction
9. Qty. of Strainer required.

DESIGN : ASME Sec VII. Dev.1

I-FLOW VALVES

I-FLOW VALVES

Good Quality

Good Service

Good Price

MANUFACTURES OF

Victrlick Coupling (SS / CI) Flow Control Valve, Gate Valve,
Globe Valves, Butterfly Valve, Ball Valves, Victrlick Valves & Multipot Valves, Flanges-Gasket
All Type of Industrial Valves & Pipe Fittings, Flanges, Steel Fittings, Victrlick Coupling & Triclover Valve



'AAI MA' Engineering Company

(AN ISO 9001 : 2015 Certified Company)

20, Shayona Ind. Estate, Nr. Vadilal Ice Cream Factory, Dudheshwar Road, Tavdipura, Ahmedabad-380 004. (INDIA)
Tele / Fax : +91-79-25632507 Cell : 9898 00 2507 / 9722 00 2507 • E-mail : aaimacompany@yahoo.com / aaimavalves@yahoo.in