



MKPS-TE

IGBT,GTO缓冲吸收



应用 / Application

- IGBT缓冲吸收;
- 广泛应用于电力电子设备中开关器件关断时的尖峰电压, 尖峰电流吸收保护。
- IGBT Snubber;
- Widely used in power electronic equipment when the peak voltage, peak current absorption protection.

产品特点 / Introduction

- 迈拉胶带封装, 阻燃环氧树脂注塑;
- 镀锡铜线引出, 方便安装;
- 无感式结构, ESL低、ESR小, 高脉冲电流, 高DV/DT承受能力; 耐压高, 损耗小, 温升低, 寿命长等特点。
- Mylar tape, Sealed with epoxy resin;
- Tin plated copper wire lead, convenient installation;
- Non inductive structure, ESL low, ESR small, high pulse current, high DV/DT bearing capacity, high pressure, low loss, low temperature rise, long life and so on.

典型应用电路 / Typical Circuit

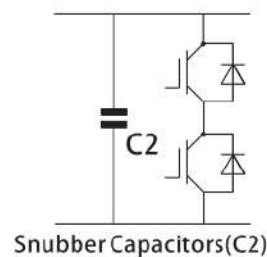

外形图 / Outline Drawing

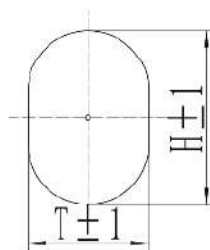
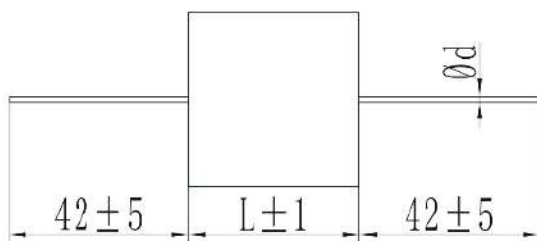

扁形
Sector

技术参数 / Technical Data

执行标准 Implemented standard	GB/T 17702、IEC61071
气候等级 Climatic category	40/105/56
额定电压 (Un) Rated Voltage	630V.DC~4000V.DC
容量范围 (Cn) Capacitance range	0.0068 μ F~10 μ F
容量偏差 Capacitance tolerance	$\pm 5\%$ (J)、 $\pm 10\%$ (K)
耐电压 Withstand voltage	
极间 between terminals	1.5Un(VDC)/10S
绝缘电阻 Insulation resistance	RixCn ≥ 50005 (100VDC, 60S@20°C)



MKPS-TE

IGBT,GTO缓冲吸收

常用规格 / Dimension

Un630V.DC;Urms400V.AC;Us 945V									
Cn (μ F)	L (mm \pm 1)	T (mm \pm 1)	H (mm \pm 1)	φ d (mm)	ESL (nH)	dv/dt (V/ μ S)	IpK(A)	Irms(A)	Part number
0.22	32	9.5	17.5	0.8	23	300	66	5.3	STE0224J00630*****
0.33	32	12	20	1	22	200	66	6.5	STE0334J00630*****
0.47	32	14.5	22.5	1	21	220	103.4	8.3	STE0474J00630*****
0.68	32	18	26	1	20	180	122.4	9.5	STE0684J00630*****
1	37	11	19	1	28	150	150	7.6	STE0105J00630*****
1.5	37	13.5	21.5	1	27	150	225	9.5	STE0155J00630*****
2	37	16	24	1.2	24	130	260	10.2	STE0205J00630*****
2.5	37	18	26	1.2	25	120	300	10.5	STE0255J00630*****
3	37	20	28	1.2	30	110	330	10.8	STE0305J00630*****
3.3	37	21	29	1.2	30	110	363	11.2	STE0335J00630*****
4	57	27	36.5	1.2	32	220	880	12.8	STE0405J00630*****
4.7	57	28	40.5	1.2	32	200	940	13.8	STE0475J00630*****
5.6	57	31	33.5	1.2	32	185	1036	13.5	STE0565J00630*****
6.8	37	29	41.5	1.2	28	100	680	13.8	STE0685J00630*****
6.8	57	34	46.5	1.2	30	180	1224	14.2	STE0685J00630*****
Un 1000V.DC;Urms 500V.AC;Us 1500V									
Cn (μ F)	L (mm \pm 1)	T (mm \pm 1)	H (mm \pm 1)	φ d (mm)	ESL (nH)	dv/dt (V/ μ S)	IpK(A)	Irms(A)	Part number
0.15	32	10	17.5	0.8	20	1100	165	5.5	STE0154J01000*****
0.22	32	12	20	1	21	1000	220	7.3	STE0224J01000*****
0.33	32	15.5	23	1	21	1000	330	8.7	STE0334J01000*****
0.47	32	18.5	26	1.2	23	1000	470	10.5	STE0474J01000*****
0.47	44	14	22	1.2	24	900	423	9.5	STE0474J01000*****
0.68	32	20	32.5	1.2	25	900	612	10.8	STE0684J01000*****
0.68	44	17	25	1.2	26	800	544	10.2	STE0684J01000*****
1	44	21.5	29.5	1.2	27	900	900	11	STE0105J01000*****
1.5	44	26	35.5	1.2	29	900	1350	12	STE0155J01000*****
1.5	57	21	29	1.2	30	700	1050	12.2	STE0155J01000*****
2	44	28	40.5	1.2	30	800	1600	13.2	STE0205J01000*****
2	57	24	33.5	1.2	32	600	1200	12.8	STE0205J01000*****
2.2	44	30	42.5	1.2	32	600	1320	13.8	STE0225J01000*****
2.2	57	25	34.5	1.2	32	500	1100	13.5	STE0225J01000*****
2.5	57	25	38	1.2	33	500	1250	14.2	STE0255J01000*****
3	57	28	40.5	1.2	34	480	1440	15.6	STE0305J01000*****
3.3	57	29.5	42	1.2	35	450	1485	16.5	STE0335J01000*****
3.5	57	30.5	43	1.2	35	450	1575	17.2	STE0355J01000*****
4.7	57	35	50.5	1.2	36	420	1974	17.8	STE0475J01000*****
5.6	57	38.5	65	1.2	38	400	2240	18.2	STE0565J01000*****
Un 1200V.DC;Urms 550V.AC;Us 1800V									
Cn (μ F)	L (mm \pm 1)	T (mm \pm 1)	H (mm \pm 1)	φ d (mm)	ESL (nH)	dv/dt (V/ μ S)	IpK(A)	Irms(A)	Part number
0.1	32	8.5	16	0.8	20	1300	130	6	STE0104J01200*****
0.15	32	10	17.5	1	20	1200	180	7.5	STE0154J01200*****
0.22	32	13	21	1	22	1200	264	8.3	STE0224J01200*****
0.33	32	16	24	1	23	1200	396	9	STE0334J01200*****
0.47	32	17.5	30	1.2	23	1200	564	9.5	STE0474J01200*****
0.47	44	15	23	1.2	26	1100	517	9.8	STE0474J01200*****
0.68	32	21.5	34	1.2	25	1100	517	10	STE0684J01200*****
0.68	44	18.5	26.5	1.2	27	1000	680	11.7	STE0684J01200*****
1	44	23	31	1.2	28	1000	1000	12.4	STE0105J01200*****
1.5	44	26.5	39	1.2	30	950	1425	13.5	STE0155J01200*****
1.5	57	22.5	30.5	1.2	29	900	1350	12.6	STE0155J01200*****
2	44	29	45	1.2	30	800	1600	14.2	STE0205J01200*****



MKPS-TE

IGBT,GTO缓冲吸收

常用规格 / Dimension

Un 1200V.DC;Urms 550V.AC;Us 1800V

Cn (μ F)	L (mm \pm 1)	T (mm \pm 1)	H (mm \pm 1)	φ d (mm)	ESL (nH)	dv/dt (V/ μ S)	IpK(A)	Irms(A)	Part number
2	57	26.5	34.5	1.2	30	750	1500	13.8	STE0205J01200****
2.2	44	31	47	1.2	32	800	1760	14.5	STE0225J01200****
2.2	57	27.5	35.5	1.2	35	700	1540	14.5	STE0225J01200****
3	57	29	44.5	1.2	37	500	1500	17.2	STE0305J01200****
3.3	57	30.5	46	1.2	38	450	1485	17.8	STE0335J01200****
4.7	57	38	53.5	1.2	38	420	1974	18.2	STE0475J01200****

Un 1700V.DC;Urms 575V.AC;Us 2550V

Cn (μ F)	L (mm \pm 1)	T (mm \pm 1)	H (mm \pm 1)	φ d (mm)	ESL (nH)	dv/dt (V/ μ S)	IpK(A)	Irms(A)	Part number
0.1	32	9.5	17.5	0.8	25	1300	130	7.5	STE0104J01700****
0.15	32	12	20	1	24	1200	180	8.5	STE0154J01700****
0.22	32	15	23	1	24	1200	264	9.3	STE0224J01700****
0.33	32	18.5	26.5	1	22	1200	396	9.9	STE0334J01700****
0.33	44	13.5	21.5	1.2	29	1100	363	10.2	STE0334J01700****
0.47	44	16	24	1.2	28	1000	470	11.2	STE0474J01700****
0.68	44	20	28	1.2	27	1000	680	11.7	STE0684J01700****
1	44	24	33.5	1.2	26	900	900	12.4	STE0105J01700****
1	57	19.5	27.5	1.2	33	850	850	10.8	STE0105J01700****
1.5	44	28	40.5	1.2	25	800	1200	13.5	STE0155J01700****
1.5	57	24	32	1.2	33	750	1125	13.5	STE0155J01700****
2	44	31.5	47	1.2	24	750	1500	14.2	STE0205J01700****
2	57	27.5	37	1.2	32	650	1300	12.8	STE0205J01700****
2.2	44	33.5	49	1.2	34	700	1540	15.6	STE0225J01700****
2.2	57	29	40	1.2	32	600	1320	14.5	STE0225J01700****
3	57	31	46.5	1.2	30	560	1680	17.2	STE0305J01700****
3.3	57	33	48.5	1.2	29	500	1650	17.6	STE0335J01700****
4	57	37	52.5	1.2	28	450	1800	18.2	STE0405J01700****

Un 2000V.DC;Urms 700V.AC;Us 3000V

Cn (μ F)	L (mm \pm 1)	T (mm \pm 1)	H (mm \pm 1)	φ d (mm)	ESL (nH)	dv/dt (V/ μ S)	IpK(A)	Irms(A)	Part number
0.068	32	9	17	1	23	1500	102	6.9	STE0683J02000****
0.1	32	11.5	19.5	1	22	1500	150	8.2	STE0104J02000****
0.1	37	10.5	18.5	1	26	1450	145	8	STE0104J02000****
0.22	32	17.5	25.5	1.2	21	1400	308	9.1	STE0224J02000****
0.22	37	16	24	1.2	25	1300	286	9	STE0224J02000****
0.33	37	20	28	1.2	24	1250	412.5	9.5	STE0334J02000****
0.33	44	18	26	1.2	30	1200	396	10.2	STE0334J02000****
0.47	44	19.5	32	1.2	29	1100	517	12.4	STE0474J02000****
0.68	44	24	36.5	1.2	28	1000	680	14.2	STE0684J02000****
0.68	57	18.5	31	1.2	27	900	612	14.2	STE0684J02000****
1	57	23.5	36	1.2	31	950	950	14.5	STE0105J02000****
1.5	57	29.5	42	1.2	31	850	1275	14.5	STE0155J02000****
2	57	33	48.5	1.2	31	750	1500	16.5	STE0205J02000****
2.2	57	35	50.5	1.2	30	700	1540	17.8	STE0225J02000****

Un 3000V.DC;Urms 750V.AC;Us 4500V

Cn (μ F)	L (mm \pm 1)	T (mm \pm 1)	H (mm \pm 1)	φ d (mm)	ESL (nH)	dv/dt (V/ μ S)	IpK(A)	Irms(A)	Part number
0.047	44	13.5	21.5	1	20	2000	94	8.5	STE0683J03000****
0.068	44	17	25	1	20	1800	122.4	10.5	STE0683J03000****
0.1	44	20.5	28.5	1.2	20	1500	150	12.4	STE0104J03000****
0.15	44	26	34	1.2	22	1350	202.5	13.8	STE0154J03000****
0.22	44	29	41.5	1.2	22	1200	264	14.5	STE0224J03000****