

*The Ultimate Solution*



Manufacturers :

**PARAS VALVES Pvt. Ltd.**

(AN ISO 9001:2008 Certified Co.)

49, Aman Nagar, Industrial Area,

JALANDHAR - 144 004 India.

Ph. : 0181-2292364, 65, 66

Fax : 0091-181-2292367

E mail : paras.valves@gmail.com



An ISO 9001: 2008  
Certified Company



Catalogue



*The Ultimate Solution*

© 2011 Creator 998862007



KRANTI

VALVES

INDEX

INDEX

page

Certifications

..... 1

Director's Messages

..... 2-3-4

Company Profile

.....5

Process

..... 6-7

C.I. Globe Valve  
(Straight & Angle Type)

..... 8

C.I. Horizontal Lift Check Valve  
(Straight & Angle Type)

..... 9

C.I. Accessible Feed Check Valve  
C.I. Swing Check Valve

..... 10

C.I. "Y" Type Strainer  
(Screwed & Flanged)

..... 11

C.S. Globe Steam Stop Valve  
(Straight & Angle Type)

..... 12

C.S. Horizontal Lift Check Valve  
(Straight & Angle Type)

..... 13

C.S. Parallel Slide Blowoff Valve  
C.S. Sleeve Packed Water level Gauge

..... 14

S.S. Thermodynamic Steam Trap  
C.S. Ball Valve (Screwed)

..... 15

C.I. Sluice Valve  
C.I. Non return Valve

..... 17

C.I. Butterfly Valve  
C.I. Dual Plate Check Valve

..... 18

C.I. Ball Valve (Screwed & Flanged)

..... 19

C.I. "Y" Type Strainer (Screwed & Flanged)

..... 20

C.I. Single & Double Air Valve

..... 21

Kinetic Air Valve & P.R.V.

..... 22

KRANTI

VALVES

CERTIFICATIONS

Quality Policy

"We are committed to provide a better quality product which suits the customer requirements & keep on improving resource utilization to best of our efforts "

ISO Certification

for more reliability...

ISO 9001:2008

Certificate of Registration

This is to Certify that Compliance of Quality Management System of

Paras Valves Pvt. Ltd.

49, Aman Nagar, Industrial Area,  
Jalandhar- 144 004, Punjab- India

has been Assessed and Found to Conform the Requirements of

ISO 9001:2008

For the scope of activities:

Manufacture of Valves & Cocks, Procurement & Supply of  
Electromagnetic Flow Meter, Ultrasonic Flow Meters  
and Oil Meters.

CERTIFICATE NO. :IN 1168  
CERTIFICATE DATE :10-12-2010  
SURVEILLANCE AUDIT  
THIS CERTIFICATE IS VALID IF THE ANNUAL SURVEILLANCE MARK IS PRESENT  
on behalf of QCL  
Head of Certification  
ACCREDITATION NO: AUS.IN.3  
VALID UPTO: 09-12-2013  
QUALITY CERTIFICATIONS LABS  
Accredited by: Quality Certification & Registration Labs pty. ltd Australia  
Validation of the certificate can be verified from [www.qclindia.com](http://www.qclindia.com) & [www.qcl.org.au](http://www.qcl.org.au)  
The registration does not assure the quality of yields under the firm's production

KRANTI Guarantee

Kranti Valves are fully guaranteed against any defect in manufacturing or in materials. All these products are manufactured under the very strict quality control & inspected by the experienced staff before dispatch.

ISO Certifications

1





Its my privilege and pleasure in releasing the first edition of Catalogue comprising of valves for information and ready reference to our stockist and clients. The journey of our company has tremendous contribution of our expert technical and professional team. Whose hardwork and devotion took the company to the new heights

My blessings and best wishes shall remain with all who so ever are associated with 'Kranti'.

Looking Forward as always...

Subash Sharma (Mg. Director)



"Kranti" brings to you an extra ordinary array of valves in Cast iron, Cast Steel & Stainless Steel of unsurpassed quality. Valves are manufactured to the highest standards at the ISO 9001 Certified plant.

"Kranti" valves are conforming to National & International standards, having more than three decades of experience in manufacturing with advance technology, assures reliability in quality. We also commit to high quality & consistency in our products and after sales services.

The Company aims to lead the Indian general flow control valves industries by becoming the most nessasiate manufacturer.

Ashok Sharma (Director)



Total Quality Commitment.

“KRANTI” has always remained totally committed to offering products & services that not only meet, but exceed customer expectations. All “KRANTI” valves are designed and manufactured with an emphasis simple maintenance ease of operation and our valve long and reliable service life, Our objective is to deliver long term quality valve to our customers. Our goal is Total quality and on-time delivery and our method in total commitment.

WHEN YOU ARE LOOKING FOR A EXCELLENT QUALITY VALVE THAT HARD TO FIND., JUST CALL “KRANTI” ...

Paras Sharma (C.E.O)



WELCOME TO THE WORLD OF “KRANTI” VALVES...

The success story begin with the foundation of “Aman Engineering Works” in 1980. Our core business has been manufacturing of ‘Kranti’ Brand Water meters, which have product designing, developing in house facility with advance technology, machining methods and strict quality control management system.

In the year 2005, “Paras Valves Pvt. Ltd.” was introduced with a vision to manufacture Quality valves with the same idiology as its parent company. It took up six long years to follow our vision. We take into consideration the market, costomer’s requirements to develop our valves which meets National and International Standards, in addition the company has passed ISO 9001:2008 Quality Management System Certification.

Our main moto is to provide quality valves to the costomer’s satisfaction and our approach will always be to improve the quality of our products.

Company Profile



Computer Aided Designing



Raw Materials



Chemical Lab.



Induction



Pouring of Metal



Shot Blasting



Machining of Valves



CNC Turning Center



Assembling of Valves



Testing



Paint Shop







PV-101

CAST IRON GLOBE STEAM STOP VALVE

STRAIGHT PATTERN (Flanged)



**SALIENT FEATURES :** Outside Screw, Yoke type & Rising stem with backseat arrangement, S.S 410 Renewable Working Parts, Handwheel operated, Straight Pattern. Design Standard BS5152,/ DIN 86251 Flanged ends as per DIN 2533 R.F for PN-16 Sizes upto 150mm & DIN2532 RF PN-10 for 200mm.



TEST PRESSURE

(Hydraulic) Seat : 16Kg/cm<sup>2</sup> Shell 24Kg/cm<sup>2</sup>  
(Steam) Seat : 13Kg/cm<sup>2</sup> Max. Working Temp. 220°

Sizes		L	Dimensions		
mm	Inch.		H	T	W
15	½	130	165	14	100
20	¾	150	165	16	100
25	1	160	175	16	100
32	1¼	180	190	18	125
40	1½	200	240	18	160
50	2	230	285	20	160
65	2½	290	305	20	200
80	3	310	345	22	200
100	4	350	385	24	250
125	5	400	410	26	250
150	6	480	470	26	315
200	8	600	540	26	400

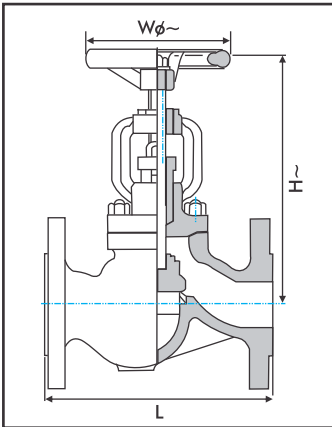

Parts Name	Material	Specifications
Body, Bonnet, Disc & Gland	Cast Iron	IBR 86-93 Gr. A
Handwheel	Cast Iron	IS 210 Gr. FG 200
Stud, Nut & Washer	Carbon Steel	IS 1367
Stem, Disc Ring, Check Nut & Body Seat Ring	Stainless Steel	AISI 410
Yoke Bush	Aluminum Bronze/ S.S	BS 1400 AB 1/ AISI 410
Gasket	Steam Jointing Sheet	IS 2712 Gr. W/3
Gland Packing	Braided Graphited	IS 4687



PV-102

CAST IRON GLOBE STEAM STOP VALVE

RIGHT ANGLE PATTERN (Flanged)



**SALIENT FEATURES :** Outside Screw, Yoke type & Rising stem with backseat arrangement, S.S 410 Renewable Working Parts, Handwheel operated, Right Angle Pattern. Design Standard BS5152,/ DIN 86251, Flanged ends as per DIN 2533 R.F for PN-16 sizes upto 150mm & DIN2532 RF PN-10 for 200mm.



TEST PRESSURE

(Hydraulic) Seat : 16Kg/cm<sup>2</sup> Shell 24Kg/cm<sup>2</sup>  
(Steam) Seat : 13Kg/cm<sup>2</sup> Max. Working Temp. 220°

Sizes		L	Dimensions		
mm	Inch.		H	T	W
25	1	100	160	16	100
32	1¼	105	170	18	125
40	1½	115	220	18	160
50	2	125	260	20	160
65	2½	145	280	20	200
80	3	155	300	22	200
100	4	175	350	24	250
125	5	200	400	26	250
150	6	225	430	26	315

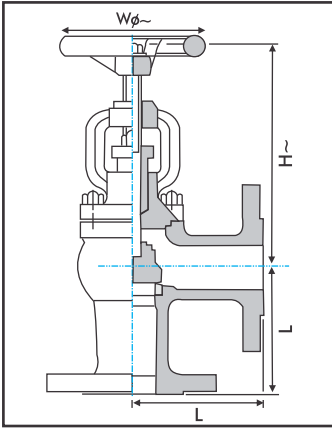

Parts Name	Material	Specifications
Body, Bonnet, Disc & Gland	Cast Iron	IBR 86-93 Gr. A
Handwheel	Cast Iron	IS 210 Gr. FG 200
Stud, Nut & Washer	Carbon Steel	IS 1367
Stem, Disc Ring, Check Nut & Body Seat Ring	Stainless Steel	AISI 410
Yoke Bush	Aluminum Bronze/ S.S	BS 1400 AB 1/ AISI 410
Gasket	Steam Jointing Sheet	IS 2712 Gr. W/3
Gland Packing	Braided Graphited	IS 4687

8



PV-103

CAST IRON HORIZONTAL LIFT CHECK VALVE

STRAIGHT PATTERN (Flanged)



**SALIENT FEATURES :** Bolted Cover, S.S 410 Renewable Working Parts, Straight Pattern. Design Standard BS5153, Flanged ends as per DIN 2533 R.F for PN-16 sizes upto 150mm & DIN2532 RF PN-10 for 200mm.



TEST PRESSURE

(Hydraulic) Seat : 16Kg/cm<sup>2</sup> Shell 24Kg/cm<sup>2</sup>  
(Steam) Seat : 13Kg/cm<sup>2</sup> Max. Working Temp. 220°

Sizes		L	Dimensions		
mm	Inch.		H	T	
15	½	130	75	14	
20	¾	150	75	16	
25	1	160	84	16	
32	1¼	180	98	18	
40	1½	200	106	18	
50	2	230	114	20	
65	2½	290	128	20	
80	3	310	166	22	
100	4	350	172	24	
125	5	400	205	26	
150	6	480	220	26	
200	8	600	250	26	

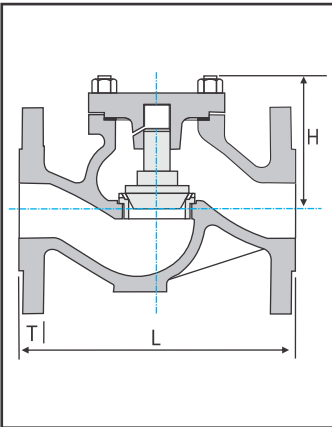

Parts Name	Material	Specifications
Body, Bonnet & Disc	Cast Iron	IBR 86-93 Gr. A
Studs & Nuts	Carbon Steel	IS 1367
Washer	Carbon Steel	IS 1367
Disc Ring & Body Seat Ring	Stainless Steel	AISI 410
Gasket	Steam Jointing Sheet	IS 2712 Gr. W/3



PV-104

CAST IRON LIFT CHECK VALVE

RIGHT ANGLE PATTERN (Flanged)



**SALIENT FEATURES :** Bolted Cover, S.S 410 Renewable Working Parts, Right Angle Pattern. Design Standard BS5153, Flanged ends as per DIN 2533 R.F for PN-16 sizes upto 150mm & DIN2532 RF PN-10 for 200mm.



TEST PRESSURE

(Hydraulic) Seat : 16Kg/cm<sup>2</sup> Shell 24Kg/cm<sup>2</sup>  
(Steam) Seat : 13Kg/cm<sup>2</sup> Max. Working Temp. 220°

Sizes		L	Dimensions		
mm	Inch.		H	T	
25	1	100	62	16	
32	1¼	105	70	18	
40	1½	115	75	18	
50	2	125	80	20	
65	2½	145	100	20	
80	3	155	110	22	
100	4	175	120	24	
125	5	200	130	26	
150	6	225	150	26	

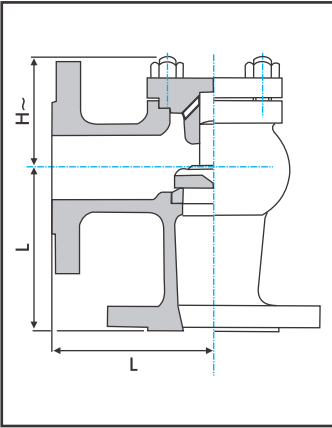

Parts Name	Material	Specifications
Body, Bonnet & Disc	Cast Iron	IBR 86-93 Gr. A
Studs & Nuts	Carbon Steel	IS 1367
Washer	Carbon Steel	IS 1367
Disc Ring & Body Seat Ring	Stainless Steel	AISI 410
Gasket	Steam Jointing Sheet	IS 2712 Gr. W/3

9





PV-105

CAST IRON ACCESSIBLE FEED CHECK VALVE  
STRAIGHT INLET (Flanged)

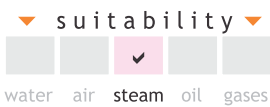

**SALIENT FEATURES :** Bolted Bonnet, Yoke type & Rising stem with backseat arrangement, S.S 410 Renewable Working Parts, Handwheel operated with Straight Inlet. Flanged Ends to BS 10 Table 'F'.



**TEST PRESSURE**  
(Hydraulic) Seat : 16Kg/cm<sup>2</sup> Shell 24Kg/cm<sup>2</sup>  
(Steam) Seat : 10.55Kg/cm<sup>2</sup> Max. Working Temp. 220°

Sizes		Dimensions				
mm	Inch.	L	H	H1	T	
25	1	95	220	160	12.7	
32	1¼	105	240	205	15.9	
40	1½	110	260	220	15.9	
50	2	120	280	250	19.1	
65	2½	130	300	260	22.2	

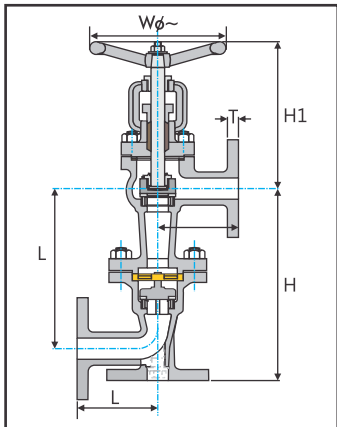

Parts Name	Material	Specifications
Body, Bonnet, Disc, Check valve	Cast Iron	IBR 86-93 Gr. A
Disc, Straight Inlet & Gland		
Handwheel	Cast Iron	IS 210 Gr. FG 200
Stud, Nut & Washer	Carbon Steel	IS 1367
Stem, Disc Ring, Check Nut & Body Seat Ring	Stainless Steel	AISI 410
Yoke Bush & Stopper	Bronze/ S.S	IS 318/ AISI 410
Gasket	Steam Jointing Sheet	IS 2712 Gr. W/3
Gland Packing	Braided Graphited	IS 4687



PV-106

CAST IRON SWING CHECK VALVE  
(Flanged)



**SALIENT FEATURES :** Bolted Cover S.S 410 Renewable Working Parts. Design Standard BS 5153 Flanged Ends to ANSIB 16.1 Class 125 Flat Face.



**TEST PRESSURE**  
(Hydraulic) Seat : 16Kg/cm<sup>2</sup> Shell 24Kg/cm<sup>2</sup>  
(Steam) Seat : 10.55Kg/cm<sup>2</sup> Max. Working Temp. 220°

Sizes		Dimensions				
mm	Inch.	L	H	T		
40	1½	165	120	16		
50	2	203	120	19.1		
65	2½	216	155	19.1		
80	3	241	172	19.1		
100	4	292	200	22.2		
125	5	330	230	25.4		
150	6	356	250	25.4		
200	8	495	265	29		

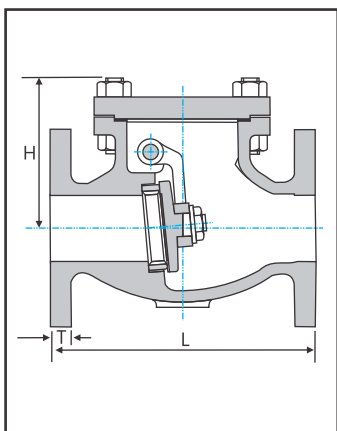

Parts Name	Material	Specifications
Body, Cover, Disc & Hing	Cast Iron	IBR 86-93 Gr. A
Locking Screw	Stainless Steel	AISI 304
Stud, Nut & Washer	Carbon Steel	IS 1367
Body Ring, Seat Ring, Hing Pin & Nut	Stainless Steel	AISI 410
Gasket	Steam Jointing Sheet	IS 2712 Gr. W/3

10



PV-107

CAST IRON 'Y' TYPE STRAINER  
(Screwed)



**SALIENT FEATURES :** Screwed Female Ends to BS 21, Screwed in Bonnet wirh S.S. (AISI 304) perforated screen sheet having smooth contours to reduce the friction losses.



**TEST PRESSURE**  
(Hydraulic) Seat : 16Kg/cm<sup>2</sup> Shell 21Kg/cm<sup>2</sup>  
(Steam) Max. BOP : 10.55Kg/cm<sup>2</sup> Max. Working Temp. 220°

Sizes		Dimensions				
mm	Inch.	L	H			
15	½	76	60			
20	¾	98	76			
25	1	133	100			
32	1¼	150	110			
40	1½	178	132			
50	2	222	152			

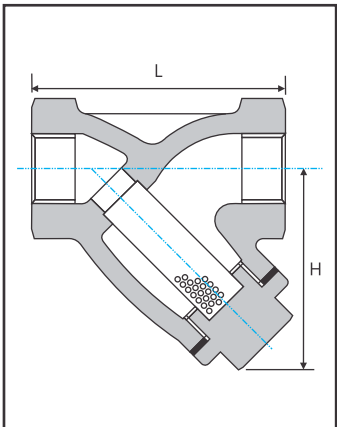

Parts Name	Material	Specifications
Body & Cover	Cast Iron	IBR 86-93 Gr. A
Strainer	Stainless Steel	AISI 304
Gasket	Steam Jointing Sheet	IS 2712 Gr. W/3



PV-108

CAST IRON 'Y' TYPE STAINER  
(Flanged)



**SALIENT FEATURES :** Flanged Ends to BS10 Table 'F' Screwed in bonnet, with S.S (AISI 304) perforated screen sheet having smooth contours to reduce the friction losses.



**TEST PRESSURE**  
(Hydraulic) Seat : 16Kg/cm<sup>2</sup> Shell 21Kg/cm<sup>2</sup>  
(Steam) Max. BOP : 10.55Kg/cm<sup>2</sup> Max. Working Temp. 220°

Sizes		Dimensions				
mm	Inch.	L	H	T		
25	1	162	120	12.7		
40	1½	206	160	16.0		
50	2	210	215	19.1		
65	2½	248	250	19.1		
80	3	270	260	19.1		
100	4	381	310	22.2		
125	5	416	420	25.4		
150	6	451	455	25.4		

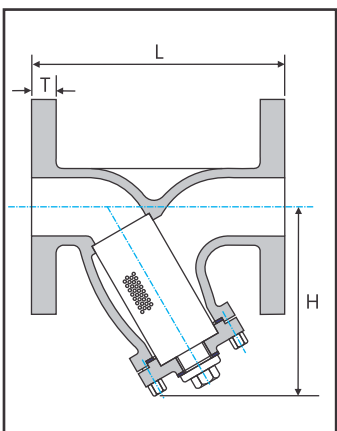

Parts Name	Material	Specifications
Body & Cover	Cast Iron	IBR 86-93 Gr. A
Strainer	Stainless Steel	AISI 304
Gasket	Steam Jointing Sheet	IS 2712 Gr. W/3
Drain Plug	Carbon Steel	IS 1367

11





PV-201

CAST STEEL GLOBE STEAM STOP VALVE PN-40  
STRAIGHT PATTERN (Flanged)

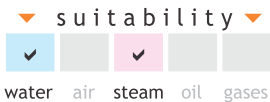

**SALIENT FEATURES :** Bolted Bonnet, Outside Screw, Yoke type & Rising stem with backseat arrangement, S.S 410 Renewable Working Parts, Handwheel operated, Straight Pattern. Design Standard BS 5160, DIN 2401 Flanged ends as per DIN 2545 R.F./ BS 4504 Part-1.



**TEST PRESSURE**

(Hydraulic) Seat : 40 Bar. Shell : 76 Bar  
(Steam) Seat : 40 Bar Max. Working Temp. 425°

Sizes		Dimensions				
mm	Inch.	L	H	T	W	
15	½	130	215	16	125	
20	¾	150	224	18	125	
25	1	160	284	18	160	
32	1¼	180	297	18	160	
40	1½	200	322	18	200	
50	2	230	348	20	200	
65	2½	290	412	22	250	
80	3	310	458	24	250	
100	4	350	529	24	315	
125	5	400	599	26	315	
150	6	480	690	28	400	
200	8	600	832	34	450	

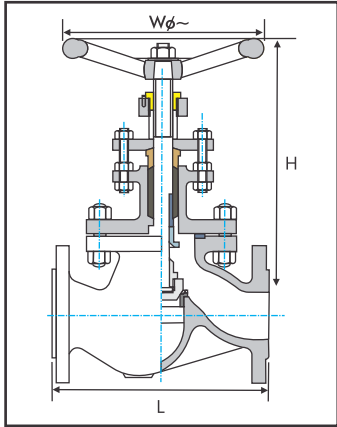

Parts Name	Material	Specifications
Body, Bonnet, Disc & Gland flange	Cast Steel	ASTM A 216 Gr. WCB
Handwheel	Cast Iron	IS 210 Gr. FG 200
Stud	Alloy Steel	ASTM A 193 Gr.B7
Nut	Alloy Steel	ASTM A 194 Gr.2H
Stem, Disc Ring, Check Nut, Gland & Body Seat Ring	Stainless Steel	AISI 410
Yoke Bush	Aluminum Bronze	BS 1400 AB 1
Gasket	Spiralwound Gasket S.S 304 Graphite Filled	BS 3381
Gland Packing	Braided Graphite	IS 4687



PV-202

CAST STEEL GLOBE STEAM STOP VALVE PN-40  
RIGHT ANGLE PATTERN (Flanged)



**SALIENT FEATURES :** Bolted Bonnet, Outside Screw, Yoke type & Rising stem with backseat arrangement, S.S 410 Renewable Working Parts, Handwheel operated, Ringht Angle Pattern. Design Standard BS 5160, DIN 2401 Flanged ends as per DIN 2545 R.F./ BS 4504 Part-1.



**TEST PRESSURE**

(Hydraulic) Seat : 40 Bar. Shell : 76 Bar  
(Steam) Seat : 40 Bar Max. Working Temp. 425°

Sizes		Dimensions				
mm	Inch.	L	H	T	W	
25	1	100	160	16	160	
32	1¼	105	170	18	160	
40	1½	115	220	18	200	
50	2	125	260	20	200	
65	2½	145	280	20	250	
80	3	155	300	22	250	
100	4	175	350	24	315	
125	5	200	400	26	315	
150	6	225	430	26	400	

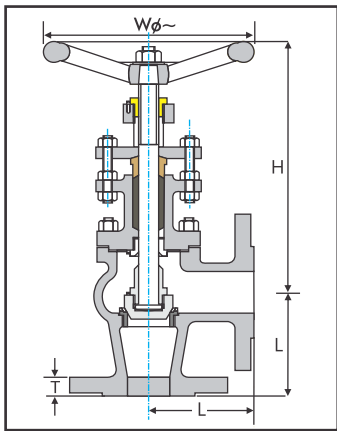

Parts Name	Material	Specifications
Body, Bonnet, Disc & Gland flange	Cast Steel	ASTM A 216 Gr. WCB
Handwheel	Cast Iron	IS 210 Gr. FG 200
Stud	Alloy Steel	ASTM A 193 Gr.B7
Nut	Alloy Steel	ASTM A 194 Gr.2H
Stem, Disc Ring, Check Nut, Gland & Body Seat Ring	Stainless Steel	AISI 410
Yoke Bush	Aluminum Bronze	BS 1400 AB 1
Gasket	Spiralwound Gasket S.S 304 Graphite Filled	BS 3381
Gland Packing	Braided Graphite	IS 4687

12



PV-203

CAST STEEL HORIZONTAL LIFT CHECK VALVE PN-40  
STRAIGHT PATTERN (Flanged)



**SALIENT FEATURES :** Bolted Cover, S.S. 410 Renewable Working Parts, Straight Pattern. Design Standard BS 5160/ DIN 2401, Flanged ends as per DIN 2545 R.F./ BS 4504 Part-1.



**TEST PRESSURE**

(Hydraulic) Seat : 40 Bar. Shell : 76 Bar  
(Steam) Seat : 40 Bar Max. Working Temp. 425°

Sizes		Dimensions				
mm	Inch.	L	H	T		
15	½	130	75	16		
20	¾	150	80	18		
25	1	160	88	18		
32	1¼	180	96	18		
40	1½	200	100	18		
50	2	230	116	20		
65	2½	290	140	22		
80	3	310	152	24		
100	4	350	178	24		
125	5	400	200	26		
150	6	480	265	28		
200	8	600	290	34		

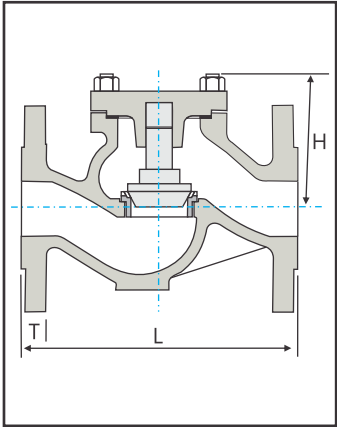

Parts Name	Material	Specifications
Body, Cover & Disc	Cast Steel	ASTM A 216 Gr. WCB
Studs	Alloy Steel	ASTM A 193 Gr. B7
Nuts	Alloy Steel	ASTM A 194 Gr. 2H
Disc Ring & Body Seat Ring	Steam Jointing Sheet	AISI 410
Gasket	Spiralwound Gasket S.S 304 Graphite Filled	BS 3381



PV-204

CAST STEEL LIFT CHECK VALVE PN-40  
RIGHT ANGLE PATTERN (Flanged)



**SALIENT FEATURES :** Bolted Cover, S.S. 410 Renewable Working Parts, Straight Pattern. Design Standard BS 5160/ DIN 2401 Flanged ends as per DIN 2545 R.F./ BS 4504 Part-1.



**TEST PRESSURE**

(Hydraulic) Seat : 40 Bar. Shell : 76 Bar  
(Steam) Seat : 40 Bar Max. Working Temp. 425°

Sizes		Dimensions				
mm	Inch.	L	H	T		
25	1	80	62	18		
32	1¼	90	70	18		
40	1½	100	75	18		
50	2	115	80	18		
65	2½	145	100	20		
80	3	155	110	22		
100	4	175	120	24		
125	5	200	130	26		
150	6	225	150	28		

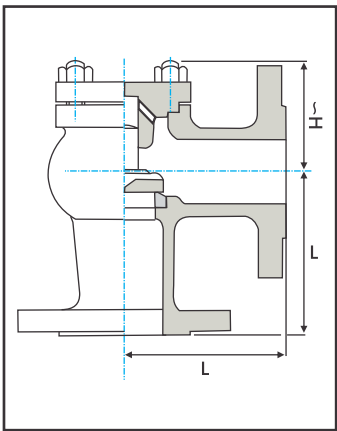

Parts Name	Material	Specifications
Body, Cover & Disc	Cast Steel	ASTM A 216 Gr. WCB
Studs	Alloy Steel	ASTM A 193 Gr. B7
Nuts	Alloy Steel	ASTM A 194 Gr. 2H
Disc Ring & Body Seat Ring	Steam Jointing Sheet	AISI 410
Gasket	Spiralwound Gasket S.S 304 Graphite Filled	BS 3381

13





PV-205

CAST STEEL PARALLEL BLOW OFF VALVE  
(Flanged)



**SALIENT FEATURES :** Bolted Bonnet, Rack & Pinion operated by key, Renewable Monel /S.S. bodyring & Discs. Flanged ends to BS 10 Table 'J' (F/F).



**TEST PRESSURE**

(Hydraulic) Seat : 21.1 Bar. Shell : 49.3 Kg/cm<sup>2</sup>  
(Steam) Max BOP : 24.6 Kg/cm<sup>2</sup> Max. Working Temp. 400°

Sizes	mm	Inch.	L	Dimensions	
				H	T
25	1		178	190	19.1
32	1¼		241	214	19.1
40	1½		267	235	22.2
50	2		305	264	25.4

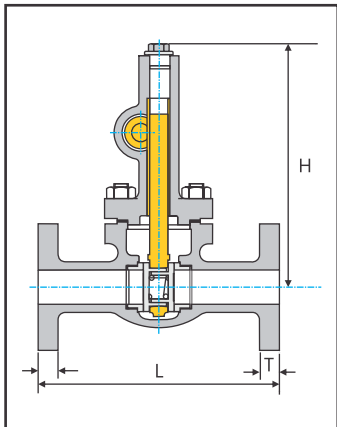

Parts Name	Material	Specifications
Body & Bonnet	Cast Steel	ASTM A 216 Gr. WCB
Discs & Body Seat Rings	Stainless Steel	AISI 410
Stuffing Box	Bronze	IS 318 LTB 2
Gland & Rack	Bronze	IS 318 LTB2
Stud & Nuts	Carbon Steel	IS 1367
Gasket	Steam jointing Sheet	IS 2712 Gr. W/3
Gland Packing	Braided Graphite	IS 4687
Spring	Stainless Steel	AISI 304
Box Key	Carbon Steel	IS 1367
Pinion	Carbon Steel	IS 1367



PV-206

CAST STEEL SLEEVE PACKED WATER LEVEL GAUGE  
(Flanged)



**SALIENT FEATURES :**  
With automatic shut off device in water arm, Replaceable moulded graphite sleeve. Flanged end to BS 10 Table 'J'.



**TEST PRESSURE**

(Hydraulic)  
Shell : 49.3 Kg/cm<sup>2</sup>

(Steam)  
Max. BOP : 24.6 Kg/cm<sup>2</sup>

Max. Working Temp. 400°

Sizes	mm	Inch.	L	Dimensions	
				T	
20	3/4		100	16	

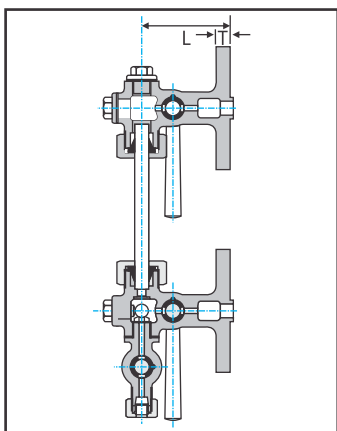

Parts Name	Material	Specifications
Upper & Lower Arms	Cast Steel	ASTM A 216 Gr. WCB
Drain Valve	Cast Steel	IBR 73-80
Bonnet, Plug & Stem	Stainless Steel	AISI 410
Ball	Stainless Steel	AISI 304
Cone	Rubber	IS 5192
Nut	Carbon Steel	IS 1367
Name Plate	Aluminum/ Brass	IS 410/ BS En 10154
Glass Tube	Toughened Glass	BS 3463
Lever	S.G. Iron	ASTM A 536
Sleeve	Moulded Graphite	----

14



PV-301

STAINLESS STEEL THERMODYNAMIC STEAM TRAP  
(Screwed)



**SALIENT FEATURES :** Mirror Finish Moving Disc, Inbuilt Integral Strainer, Perforated 0.5mm screen sheet. Screwed Female BSP taper threads to BS 21.



**TEST PRESSURE**

(Hydraulic) Shell : 63.3 Kg/cm<sup>2</sup>  
(Steam) Max BOP : 31.6 Kg/cm<sup>2</sup> Max. Working Temp. 400°

Sizes	mm	Inch.	L	Dimensions	
				H	B (BSPT)
15	½		78	50	½"
20	¾		78	50	¾"
25	1		87	50	1"

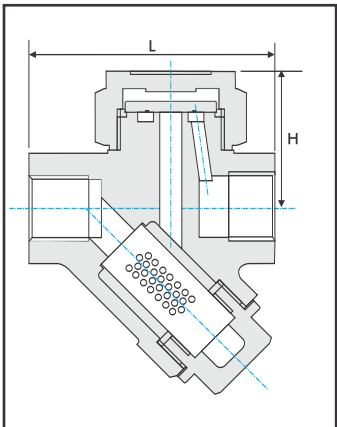

Parts Name	Material	Specifications
Disc	Stainless Steel	AISI 410
Plug	Stainless Steel	AISI 420
Body & Bonnet	Stainless Steel	AISI 420
Strainer	Steam Jointing Sheet	AISI 304
Name Plate	Aluminium	BS EN 10154



PV-302

CAST STEEL BALL VALVE Class-150  
THREE PIECE DESIGN (Screwed)

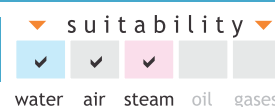

**SALIENT FEATURES :** Bolted Connector, S.S. 304 Ball & Stem. Screwed Female Ends BSP taper Threads to BS 21, Design Standard BS 5351 Full bore Three Piece Design.



**TEST PRESSURE**

(Hydraulic) Seat : 40 Bar. Shell : 76 Bar  
(Steam) Seat : 40 Bar Max. Working Temp. 425°

Sizes	mm	Inch.	A	Dimensions	
				H	L/L
15	½		70	40	110
20	¾		75	40	110
25	1		95	56	145
32	1¼		105	65	145
40	1½		115	78	185
50	2		125	78	185

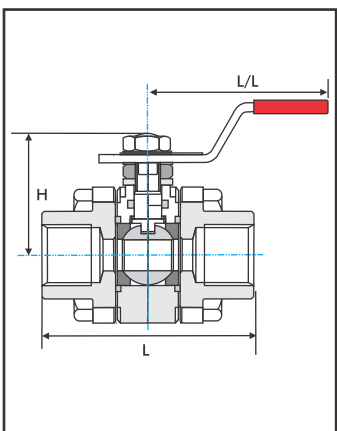

Parts Name	Material	Specifications
Body & Connector	Cast Steel	ASTM A 216 Gr. WCB
Ball & Stem	Stainless Steel	AISI 304/ 316
Rings & Gasket	PTFE	BS EN 12086-1
Thrust Washer	PTFE	BS EN 12086-1
Packing Ring	PTFE	BS EN 12086-1
Studs	Alloy Steel	ASTM A 193 Gr. B7
Nut	Alloy Steel	ASTM A 194 Gr. 2H
Lever	Carbon Steel	IS 2062

15





Water LINE SERIES

Quality & Performance Together



PV-401

CAST IRON SLUICE VALVE  
(Flanged)



suitability



**SALIENT FEATURES :** Bolted Bonnet, Non Rising S.S. 410 Stem with Bronze Working parts. Conforming to IS 14846 PN1.6, PD type Flanged ends as per IS 1538



Sizes		Dimensions			
mm	Inch.	L	H	T	
50	2	178	350	16	
65	2½	190	365	16.5	
80	3	203	375	21	
100	4	229	445	22	
125	5	254	500	22.5	
150	6	267	535	23	
200	8	292	650	24.5	
250	10	330	790	26	
300	12	356	850	27.5	

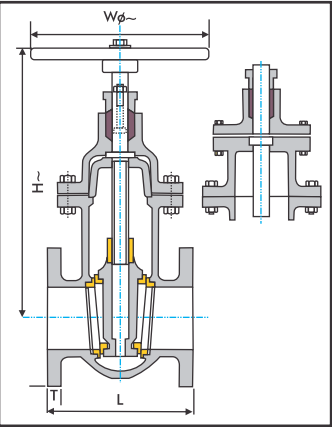

Parts Name	Material	Specifications
Body, Bonnet, Gland & Thrust Plate	Cast Iron	IS 210 FG 200
Wedge & Stuffing Box	Cast Iron	IS 210 FG 200
Handwheel	Cast Iron	IS 210 FG 200
Stem	Stainless Steel	IS 7604
Bolts & Nuts	Carbon Steel	IS 1363
Wedge Nut & Wedge Ring	Bronze	IS 318 Gr. LTB 2
Body Seat Ring	Bronze	IS 318 Gr. LTB 2
Gland packing	Jute/ Hemp	IS 5414
Gasket	Rubber	IS 638 Type B

**TEST PRESSURE**  
(Hydraulic) Seat : 1.6 Mpa. Shell : 2.4 Mpa.



PV-402

CAST IRON NON RETURN VALVE SWING TYPE  
(Flanged)



suitability



**SALIENT FEATURES :** Bolted Cover, Swing type Non Return valve with Bronze body face ring & Rubber Disc. Conforming to IS 5312 Part-1 Flanged ends as per IS 1538.



Sizes		Dimensions			
mm	Inch.	L	H	T	
50	2	203	135	16	
65	2½	216	150	16.5	
80	3	241	168	21	
100	4	292	190	22	
125	5	330	222	22.5	
150	6	356	245	23	
200	8	495	295	24.5	

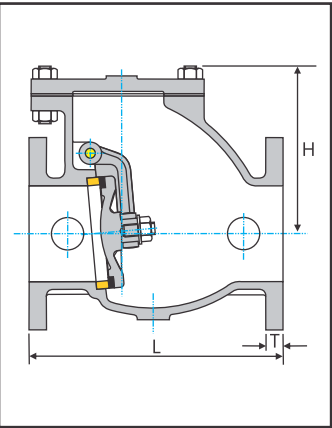

Parts Name	Material	Specifications
Body, Cover & Hinge	Cast Iron	IS 210 FG 200
Body Seat Ring	Bronze	IS 318 Gr. LTB 2
Disc	Cast Iron	IS 210 FG 200
Disc Face Ring	Rubber	IS 638 Type B
Hinge Pin	Stainless Steel	IS 7604
Washer	Carbon Steel	IS 1363
Side Plug	Stainless Steel	IS 7604
Gasket	Rubber	IS 638 Type B
Stud & Nuts	Carbon Steel	IS 1363

**TEST PRESSURE**  
(Hydraulic) Seat : 1.6 Mpa. Shell : 2.4 Mpa.





PV-403

CAST IRON BUTTERFLY VALVE  
WAFER TYPE



**SALIENT FEATURES :** Wafer Type, lever /Gear operated. Compatible to insertion between Flanges of BS 10 Table 'D, E, F', ASA Class-150, 300, IS 6392 Table 17. Conforming to IS 13095.



**TEST PRESSURE**  
(Hydraulic) Seat : 1.6 Mpa. Shell : 2.4 Mpa.  
(Air) Seat : 7Kg/cm<sup>2</sup>

Sizes mm	Inch.	L	Dimensions		
			H	H1	L/L
40	1½	33	57	95	180
50	2	43	65	105	180
65	2½	46	70	115	265
80	3	46	81	125	265
100	4	52	101	146	265
125	5	56	118	164	265
150	6	56	129	179	265
200	8	60	155	215	Gear Operated
250	10	68	200	250	
300	12	78	215	275	

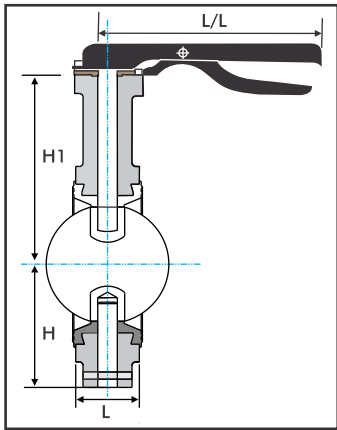

Parts Name	Material	Specifications
Body	Cast Iron	IS 210 FG 200
Bush	PTFE	BS EN 12086
Disc	S.G. Iron	ASTM A 536
Liner	EPDM	IS 5192-1
Lock Plate	Carbon Steel	IS 2062
Bolts & Nuts	Carbon Steel	IS 1367
Lever & Lever Lock Screw	Carbon Steel	BS 960
Upper & Lower Stem	Stainless Steel	IS 7604
Dowel Pin	Carbon Steel	BS 1574



PV-404

CAST IRON DUAL PLATE CHECK VALVE



**SALIENT FEATURES :** Wafer Type Non Return Valve. Compatible to insertion between Flanges of BS 10, Table 'D, E, F', ASA Class-150, DIN PN-16 with S.G. Iron/ S.S. 304 Flaps.



**TEST PRESSURE**  
(Hydraulic) Seat : 16 Kg/cm<sup>2</sup> Shell : 24 Kg/cm<sup>2</sup>

Sizes mm	Inch.	L	Dimensions		
			D	C	
50	2	55	101	50	
65	2½	55	120	65	
80	3	60	130	80	
100	4	65	170	100	
125	5	72	190	125	
150	6	95	215	150	
200	8	110	275	200	
250	10	185	335	250	
300	12	190	405	300	

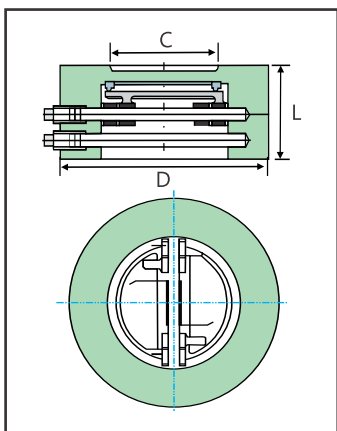

Parts Name	Material	Specifications
Body	Cast Iron	IS 210 FG 200
Pin	Stainless Steel	IS 7604
Washer	Stainless Steel	IS 7604
Spring	Stainless Steel	IS 7604
Flap	S.G. Iron/ Stainless Steel	ASTM A536/ ASTM A 351
Hook	Carbon Steel	IS 1367

18



PV-405

CAST IRON BALL VALVE  
(Screwed)



**SALIENT FEATURES :** Screwed in Bonnet, 2 Piece Design, Lever Operated with PVC Sleeve. Screwed female ends to IS 554, Conforming to IS 9890.



Sizes mm	Inch.	L	Dimensions		
			H	L/L	B(BSP)
15	½	83	53	110	½"
20	¾	90	60	125	¾"
25	1	97	65	125	1"
32	1¼	103	80	180	1¼"
40	1½	115	85	220	1½"
50	2	142	100	220	2"
65	2½	160	125	270	2½"
80	3	179	135	320	3"
100	4	217	155	320	4"

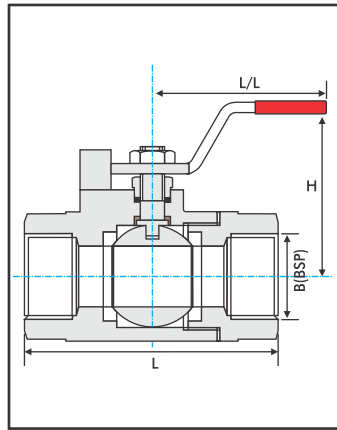

Parts Name	Material	Specifications
Body	Cast Iron	IS 210 FG 200
Connector	Cast Iron	IS 210 FG 200
Stem	Stainless Steel	IS 7604
Gland Nut	Carbon Steel	IS 1367
Gland Packing	PTFE	BS EN 12086-1
Ball	Stainless Steel	IS 7604
Teflon Ring	PTFE	BS EN 12086-1
Nuts	Carbon Steel	IS 1363
Lever	Carbon Steel	IS 1367

**TEST PRESSURE**  
(Hydraulic) Seat : 1.6 Mpa. Shell : 2.4 Mpa.  
(Air) Seat : 7Kg/cm<sup>2</sup>



PV-406

CAST IRON BALL VALVE  
(Flanged)



**SALIENT FEATURES :** Bolted End Conector, 3 Piece Design, Lever Operated with PVC Sleeve. Flanged ends as per IS 1538, Conforming to IS 9890.



Sizes mm	Inch.	L	Dimensions		
			H	L/L	T
15	½	178	53	110	12.7
20	¾	190	60	125	12.7
25	1	203	65	125	12.7
32	1¼	229	80	180	16
40	1½	254	85	220	16
50	2	267	100	220	19
65	2½	292	125	270	19
80	3	330	135	320	19
100	4	356	155	320	22.2

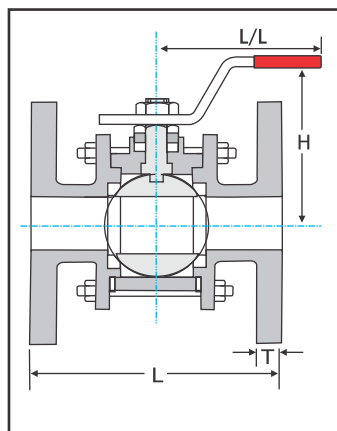

Parts Name	Material	Specifications
Body	Cast Iron	IS 210 FG 200
Connector	Cast Iron	IS 210 FG 200
Stem	Stainless Steel	IS 7604
Gland Nut	Carbon Steel	IS 1367
Gland Packing	PTFE	BS EN 12086-1
Ball	Stainless Steel	IS 7604
Teflon Ring	PTFE	BS EN 12086-1
Nuts	Carbon Steel	IS 1363
Lever	Carbon Steel	IS 1367

**TEST PRESSURE**  
(Hydraulic) Seat : 1.6 Mpa. Shell : 2.4 Mpa.  
(Air) Seat : 7Kg/cm<sup>2</sup>

19





PV-407

CAST IRON ‘Y’ TYPE STRAINER  
(Screwed)



**SALIENT FEATURES** : Screwed Female Ends to BS 21, Screwed in Bonnet with S.S. (AISI 304) perforated screen sheet having smooth contours to reduce the friction losses.



**TEST PRESSURE**  
(Hydraulic) 21.1Kg/cm<sup>2</sup>

Sizes		L	Dimensions		
mm	Inch.		H	B(BSP)	
15	½	70	55	½"	
20	¾	90	60	¾"	
25	1	105	77	1"	
32	1¼	125	93	1¼"	
40	1½	160	114	1½"	
50	2	188	130	2"	
65	2½	210	140	2½"	

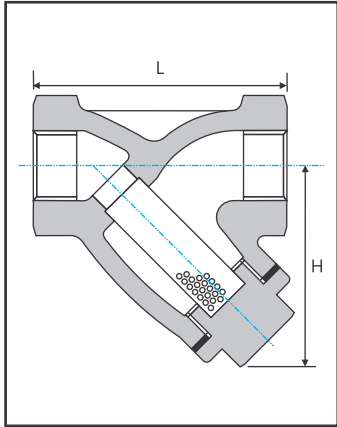

Parts Name	Material	Specifications
Body & Cover	Cast Iron	IS 210 FG 200
Strainer	Stainless Steel	IS 7604
Gasket	Steam Jointing Sheet	IS 2712 Gr. W/3



PV-408

CAST IRON ‘Y’ TYPE STRAINER  
(Flanged)



**SALIENT FEATURES** : Flanged Ends to BS10 Table ‘F’ Screwed in bonnet, with S.S (AISI 304) perforated screen sheet having smooth contours to reduce the friction losses.



**TEST PRESSURE**  
(Hydraulic) 21.1Kg/cm<sup>2</sup>

Sizes		L	Dimensions		
mm	Inch.		H	T	
40	1½	165	123	16	
50	2	200	150	19	
65	2½	212	180	19	
80	3	260	230	19	
100	4	298	275	22.2	
125	5	350	310	25.4	
150	6	385	360	25.4	
200	8	520	440	28.6	
250	10	625	520	28.6	
300	12	750	570	32	

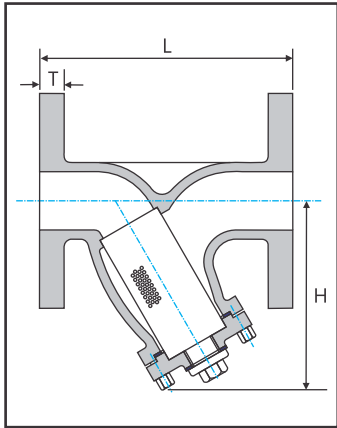

Parts Name	Material	Specifications
Body & Cover	Cast Iron	IS 210 FG 200
Strainer	Stainless Steel	IS 7604
Gasket	Steam Jointing Sheet	IS 2712 Gr. W/3
Bolts & Nuts	Carbon Steel	IS 1363

20



PV-409

CAST IRON SINGLE AIR VALVE  
(Screwed)



**SALIENT FEATURES** : Bolted Cover for automatic releasing air that may accumulate under pressure in a pipe line at the time of initial charging under normal working condition. Screwed Male end, as per IS 14845.



**TEST PRESSURE**  
(Hydraulic) : 16Kg/cm<sup>2</sup>

Sizes		H	Dimensions		
mm	Inch.		B	B(BSP)	
15	½	196	½"		
20	¾	196	¾"		
25	1	255	1"		
32	1¼	290	1¼"		
40	1½	290	1½"		
50	2	310	2"		

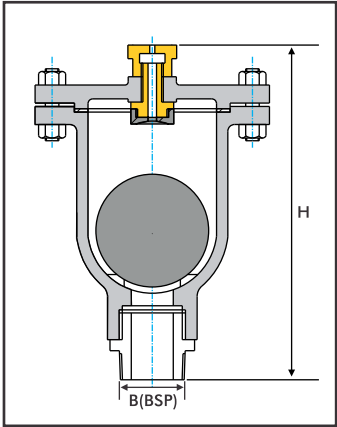

Parts Name	Material	Specifications
Body	Cast Iron	IS 210 FG 200
Cover	Cast Iron	IS 210 FG 200
Cowl	Cast Iron	IS 210 FG 200
Float	Timber Core with Rubber Coating	—
Small Orifice	Stainless Steel Rubber Coated	IS 7604
Bolts & Nuts	Carbon Steel	IS 1363
Hex. Nipple	Carbon Steel	IS 1367



PV-410

CAST IRON DOUBLE AIR VALVE  
(Flanged)



**SALIENT FEATURES** : The Valve is a combination of Small and Large Orifice, the function of the small orifice is that of a single air valve & the large orifice serves for automatically releasing/ admitting air when a pipe line is being charged or emptying water. Valve as per IS 14845, Flanged end to IS 1538.



**TEST PRESSURE**  
(Hydraulic) : 16Kg/cm<sup>2</sup>

Sizes		A	Dimensions		
mm	Inch.		B	T	H
40	1½	442	210	16	196
50	2	442	210	16	196
80	3	504	236	21	255
100	4	634	280	22	290
150	6	862	430	24	290
200	8	988	506	24.5	310

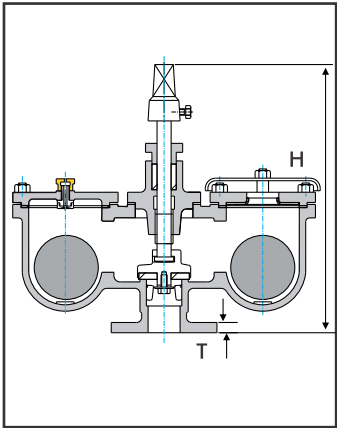

Parts Name	Material	Specifications
Body	Cast Iron	IS 210 FG 200
Cover	Cast Iron	IS 210 FG 200
Cowl	Cast Iron	IS 210 FG 200
Floats	Timber Core with Rubber Coating	—
Small Orifice	Stainless Steel Rubber Coated	IS 7604 & IS 938 Type B
large Orifice	Cast Iron Rubber Coated	IS 210 FG 200 & IS 938 Type B
Bolts & Nuts	Carbon Steel	IS 1363

21





PV-411

CAST IRON KINETIC AIR VALVE  
(Flanged)



**SALIENT FEATURES :** This valve is the same of Double air valve and is suitable for high head pipe lines where high rates of air discharged & ventilation is required.



**TEST PRESSURE**  
(Hydraulic) : 16Kg/cm<sup>2</sup>

Sizes		Dimensions			
mm	Inch.	A	B	T	H
25	1	150	260	16	210
40	1½	196	324	16	260
50	2	211	352	16	280
80	3	236	373	21	305
100	4	280	424	22	360
150	6	450	674	24	487
200	8	506	739	24.5	700

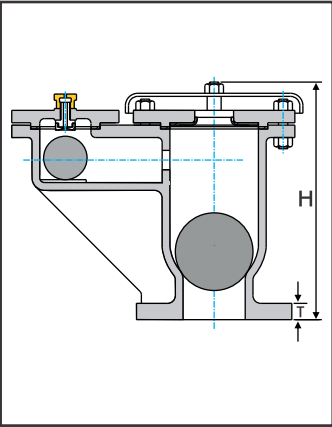

Parts Name	Material	Specifications
Body	Cast Iron	IS 210 FG 200
Cover	Cast Iron	IS 210 FG 200
Cowl	Cast Iron	IS 210 FG 200
Floats	Timber Core with Rubber Coating	—
Small Orifice	Stainless Steel Rubber Coated	IS 7604 & IS 938 Type B
large Orifice	Cast Iron Rubber Coated	IS 210 FG 200 & IS 938 Type B
Bolts & Nuts	Carbon Steel	IS 1363



PV-412

BRASS COMPACT TYPE P.R.V.  
(Screwed)



**SALIENT FEATURES :** Screwed in Bonnet, Piston Type with a provision of installing pressure gauge at down stream side, Screwed female ends to BS 21.



**TEST PRESSURE**  
(Hydraulic) 21.1Kg/cm<sup>2</sup>

Sizes		Dimensions			
mm	Inch.	L	H	H1	
15	½	85	50	72	
20	¾	85	50	72	
25	1	95	65	95	

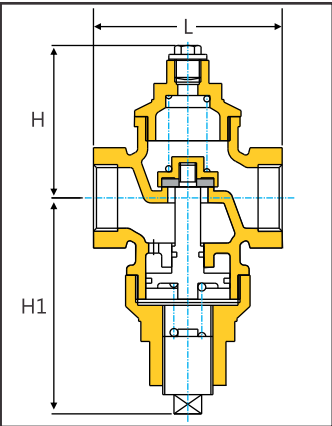

Parts Name	Material	Specifications
Body	Brass	IS 1363
Upper & Lower Bonnet	Brass	IS 1363
Piston	Brass	IS 1363
'O' Ring	Rubber	IS 5192
Disc Holder	Brass	IS 1363
Adjusting Screw	Brass	IS 1363
Disc	Rubber	IS 5192
Spring Main & Lower	Spring Steel	EN 47 Gr. B
Lower Cap	Plastic	IS 5225

22



ENJOYING PATRONAGE

'KRANTI' Valves, known for its exclusive quality, enjoy wide approvals from several Government Departments, A few of them are listed below :

- ▶ Municipal Corporation of Greater Mumbai.
- ▶ Maharashtra Industrial Development Corporation.
- ▶ Maharashtra Jeevan Pradhikaran.  
(Civil & Mechanical)  
\*Some other approvals are under process.

NOTES :

1. Flanged valves are generally supplied undrilled, unless & until specified by the buyer.
2. 'KRANTI' valves carry warranty for 18 months from the date of supply or 12 months from the date of installation, whichever ends earlier.
3. Threads to NPT/ API or any other standard can also be provided on Customer's demand.
4. Valves with Customer's Specifications/ Drawings can also be supplied.
5. Maximum working temperature for Cast Iron 220°C, Cast Steel 400°C & Stainless Steel 400°C.
6. Valves are recommended only for those Gases & Fluids, which do not react with the material of construction of those specific valves.
7. Cast Steel valves can also be provided with Stellite seating at a nominal extra price.
8. In the rare event, there can be a variation in standards/ properties of the materials used as stated, without compromising anywhere on quality and functioning of the product.
9. While Placing order please mention product code nos. and Drilling particulars.
10. All dimensions are in mm sizes.
11. Owing to our ever continuous product development, dimensions and materials are subject to change without any prior notice, please note.

PRESSURE TEMPERATURE RATING

Nominal Pressure	Standard Nos.	Max. Permissible Gauge Working Pressure at Temperature °C.						
		10-120	200	250	300	350	400	425
40	BS-5160 (Bar)	40	40	38	33	28	23	20
	DIN-2401 (Kg/cm <sup>2</sup> g)	40	35	32	28	24	21	—



put a stop..  
to the drop...

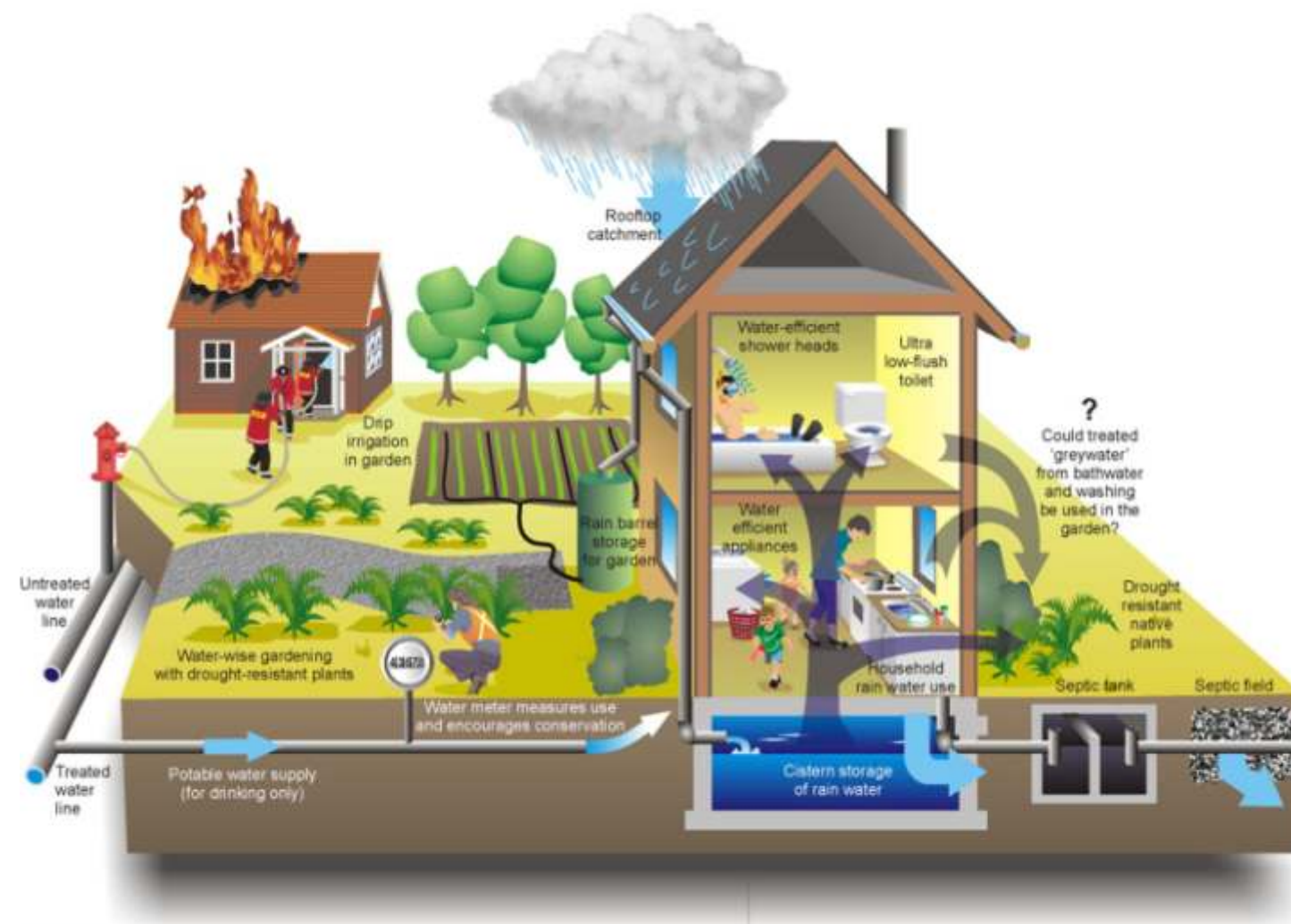

How to save water

NOTES.

