

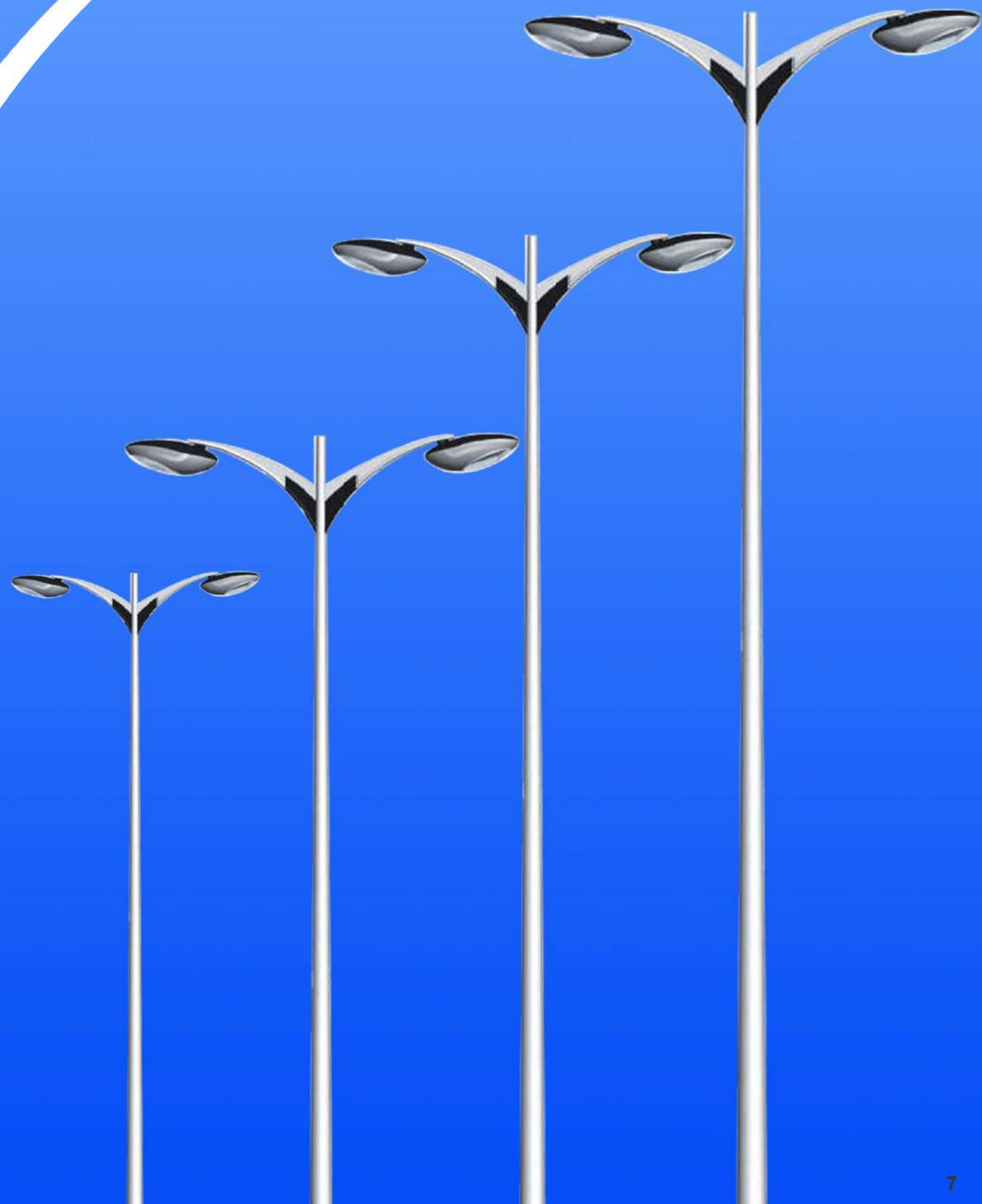

JINDAL POWER CORPORATION

AN ISO 9001 : 2015, 14001:2015, 18001:2007 CERTIFIED COMPANY

LIGHTING AND POWER DISTRIBUTION



About the Company

Jindal Power Corporation originates from its parent company Jindal Sons established in July 1982 with the specific understanding to meet the demands of the growing market in the field of town lighting, electrical power distribution and control systems. It has faced major competitions in its domestic and industrial field leading to a sparkling success by supporting its customers with precise studied prices, fast service and most of all, providing its customers with grand trust, now providing one stop solution to all turnkey projects covering the electrification field including construction & designing and setting up of electrical projects right from the base.

The members of the Company's senior management team have an average experience of approximately 40 years in diverse areas of the energy market including development, engineering, construction, finance, operations, asset management, and energy trading and contracting. Power Equations is headquartered in Kanpur Uttar Pradesh and has professional staff.

Quality management & assurance:

We at Jindal believe in developing systems & procedure that makes it a world class organization. It is one of those few organizations in India who have an ISO certified Integrated management system ISO 9001:2015, 14001:2015, OHSAS-18001:2007 quality management system standards.

Corporate Profile

We offer following service as a corporate.

- ✓ Designing the poles as per customized requirement
- ✓ Designing the lighting system.
- ✓ Turnkey solution (Installation, commissioning & testing).
- ✓ Supply of lamps & Luminaries, cables & conductors & Transformer etc.
- ✓ Designing the mast/pole structure, foundation etc.
- ✓ The only company in India into designing of GRP/ FRP lighting poles as per customized load requirement.



GALVANIZED OCTAGONAL & CONICAL POLES

JINDAL presents wide range of octagonal & conical poles, for primary use as street lighting poles. Products are fabricated using premium quality raw material and are customized to client's specification. The Poles are manufactured from tapered polygonal or circular sections, which are slipped together at site and so maintenance of close tolerances and straightness are trust areas. They come ready as flange-plated, galvanized and custom designed. Use of high-strength sheet steel and can produce single piece poles up to a length of 14 meters. We use automatic sigma machines for welding pole. Galvanized through single dip process at the company's in house sophisticated galvanizing facilities, and guarantees great corrosion resistance. X-ray, ultrasound, and surface crack inspections ensure top material quality and help maximize the life of poles and masts.



Design

The octagonal & conical poles are designed to withstand maximum wind speed as specified in IS 875. The top loading area and the weight of fixtures are considered while calculating the maximum deflection of the pole and to meet the requirement of BS: 5649 Part VI 1982.

Door Opening

The Octagonal & Conical Poles have a door of maximum 500 mm length at the elevation of 500 mm from the Base plate. The door is vandal resistance and weather proof to ensure safety of internal conations. The door is flush with the exterior surface and suitable locking arrangement.

Welding

Welding is carried out confirming to approved procedures duly qualified by third party inspection agency (SAW).

Pole Section & Galvanization

The Octagonal & Conical Poles are in single section (up to 14 meters) without any circumferential weld joint. The poles are hot dip galvanized as per IS 2629/ IS 2633/ IS 4759 standards with average coating thickness of 70 micron.



Fixing Type

The octagonal & Conical Poles are bolted on pre-cast foundation with a set of four foundation bolts for greater rigidity.

Top Mountings

Galvanized mounting bracket are supplied along with the Octagonal Poles for installation of the luminaries.

Manufacturing

The pole manufacturing & galvanizing units are ISO 9001:2015, 14001:2015, OHSAS-18001:2007 certified to ensure consistent quality.

Special Feature

- Material for pole section : Hot Rolled MS Plate/Strip as per 5986/ BSEN 10025/ Equivalent, Minimum Yield Strength is 355 MPa & Minimum Ultimate Strength is 510 MPa with maximum Sulphur and Phosphorous percentage of 0.05
- Foundation bolt : High Tensile Steel having TS600 strength
- Material for Base Plate : Hot Rolled MS plate as per IS 2062 Gr Fe 410
- Wire Rope : S/S wire rope having 7/19 construction with a grade of AISI 316
- Material Protection : hot dip galvanized as per IS 4759/ BSEN- 1461 on both internally & externally by seven tank process.

Pole Brackets

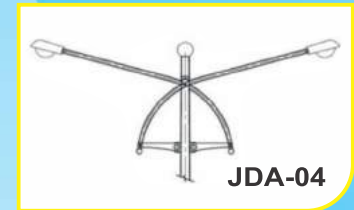
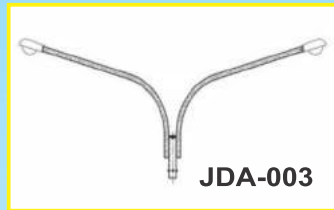
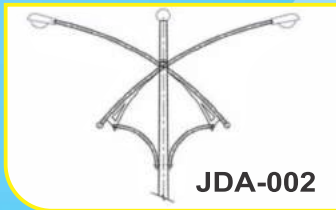
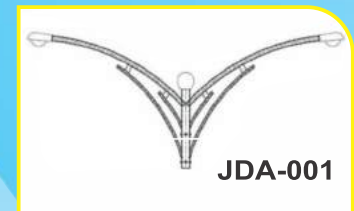
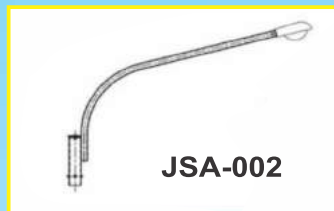
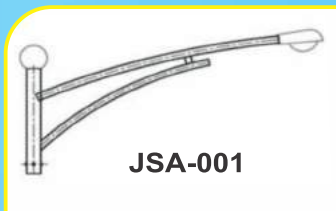

Dimensions of Standard Polyagonal Lighting Pole

Product ID	Product Name	Top Diameter	Bottom Diameter	Section	Section Length	Section Thickness	Base Plate	Foundation Bolts
JPC/OP/03	3Mtr Octagonal Pole	70mm	130mm	1	3000mm	3mm	200mmX12mm	M16X500 mm
JPC/OP/04	4Mtr Octagonal Pole	70mm	130mm	1	4000mm	3mm	200mmX12mm	M16X500 mm
JPC/OP/05	5Mtr Octagonal Pole	70mm	130mm	1	5000mm	3mm	200mmX12mm	M16X500 mm
JPC/OP/06	6Mtr Octagonal Pole	70mm	130mm	1	6000mm	3mm	200mmX12mm	M16X600 mm
JPC/OP/06/A	6Mtr Octagonal Pole	75mm	150mm	1	6000mm	4mm	240mmX12mm	M16X600 mm
JPC/OP/07	7Mtr Octagonal Pole	70mm	130mm	1	7000mm	3mm	200mmX12mm	M20X600 mm
JPC/OP/08	8Mtr Octagonal Pole	70mm	135mm	1	8000mm	3mm	225mmX16mm	M20X750 mm
JPC/OP/09	9Mtr Octagonal Pole	70mm	155mm	1	9000mm	3mm	260mmX16mm	M20X750 mm
JPC/OP/10	10Mtr Octagonal Pole	70mm	175mm	1	10000mm	3mm	275mmX16mm	M24X750 mm
JPC/OP/10/A	10Mtr Octagonal Pole	100mm	200mm	1	10000mm	4mm	300mmX20mm	M24X750 mm
JPC/OP/11	11Mtr Octagonal Pole	90mm	210mm	1	11000mm	3mm	300mmX20mm	M24X750 mm
JPC/OP/12	12Mtr Octagonal Pole	90mm	240mm	1	12000mm	3mm	320mmX20mm	M24X750 mm
JPC/OP/12/A	12Mtr Octagonal Pole	100mm	200mm	1	12000mm	4mm	340mmX20mm	M24X750 mm

Dimensions of Conical Poles

S.No.	Product Name	Top Diameter	Bottom Diameter	Section	Section Length	Section Thickness	Base Plate	Foundation Bolts
JPC/CP/05	5Mtr Conical Pole	85mm	145mm	1	5000mm	3mm	250mmX12mm	M16X600mm
JPC/CP/06	6Mtr Conical Pole	85mm	155mm	1	6000mm	3mm	250mmX16mm	M16X600mm
JPC/CP/07	7Mtr Conical Pole	85mm	165mm	1	7000mm	3mm	275mmX16mm	M20X600mm
JPC/CP/08	8Mtr Conical Pole	85mm	175mm	1	8000mm	3mm	300mmX16mm	M20X600mm
JPC/CP/09	9Mtr Conical Pole	90mm	190mm	1	9000mm	3mm	300mmX16mm	M24X750mm
JPC/CP/10	10Mtr Conical Pole	90mm	200mm	1	10000mm	4mm	320mmX20mm	M24X750mm
JPC/CP/11	11Mtr Conical Pole	90mm	210mm	1	11000mm	4mm	320mmX20mm	M24X750mm
JPC/CP/12	12Mtr Conical Pole	90mm	220mm	1	12000mm	4mm	350mmX20mm	M24X750mm

STEEL TUBULAR POLE



Jindal delivers all kind of poles from well equipped plants which features machinery like Hydraulic Swaging machines. Straightening and Welding Machines and has facilities to produce poles up to the length of 16 meters and thickness upto 8 mm. Customization is also done as per customer's specifications.

Swaged Poles include Light Poles in single hang and double hang. Street Light Poles, Traffic Light Poles etc. are made of ERW tubes of suitable length swaged and joined together.

ADVANTAGE

- Zero maintenance no pole fires, insect infestation or Pole rust.
- Weight 50-70% less than comparable concrete structures
- Custom designs- made to customer's exact specifications
- Lasts longer steel poles can last as long as 85 years with no shrinkage
- Full recyclable and non- toxic
- Custom finished to your specification
- Steel Pipes manufactured as per ASTM specification
- Capable of galvanizing all sizes of poles in Single Dip (Plant size: 14.1 m length x 1.1 mm width)



SWAGED TYPE STEEL TUBULAR POLES 410- SP- MPA

As per IS 2713

Designation (m)	Over all length (m)	Length of Section			Out side Diameter and Thickness of section			Approx. Weight of Pole (kg)
		Bottom (m)	Middle (m)	Top (m)	Bottom (m)	Middle (m)	Top (m)	
410 – SP1	7.00	4.00	1.50	1.50	114.3x3.65	88.9x3.25	76.1x3.25	62
410 – SP2	7.00	4.00	1.50	1.50	114.3x4.50	88.9x4.05	76.1x3.25	73
410 – SP3	7.00	4.00	1.50	1.50	114.3x5.40	88.9x4.85	76.1x3.25	85
410 – SP4	7.50	4.50	1.50	1.50	114.3x3.65	88.9x3.25	76.1x3.25	67
410 – SP5	7.50	4.50	1.50	1.50	114.3x4.50	88.9x4.05	76.1x3.25	79
410 – SP6	7.50	4.50	1.50	1.50	114.3x5.40	88.9x4.85	76.1x3.25	93
410 – SP7	7.50	4.50	1.50	1.50	139.7x4.50	114.3x3.65	88.9x3.25	97
410 – SP8	7.50	4.50	1.50	1.50	139.7x4.85	114.3x3.65	88.9x3.25	103
410 – SP9	7.50	4.50	1.50	1.50	139.7x5.40	114.3x3.65	88.9x3.25	110
410 – SP10	8.00	4.50	1.75	1.75	114.3x3.65	88.9x3.25	76.1x3.25	70
410 – SP11	8.00	4.50	1.75	1.75	114.3x4.50	88.9x4.05	76.1x3.25	83
410 – SP12	8.00	4.50	1.75	1.75	114.3x5.40	88.9x4.85	76.1x3.25	97
410 – SP13	8.00	4.50	1.75	1.75	139.7x4.50	114.3x3.65	88.9x3.25	101
410 – SP14	8.00	4.50	1.75	1.75	139.7x4.85	114.3x4.50	88.9x3.25	111
410 – SP15	8.00	4.50	1.75	1.75	139.7x5.40	114.3x4.50	88.9x3.25	119
410 – SP16	8.50	5.00	1.75	1.75	114.3x3.65	88.9x3.25	76.1x3.25	75
410 – SP17	8.50	5.00	1.75	1.75	114.3x4.50	88.9x4.05	76.1x3.25	89
410 – SP18	8.50	5.00	1.75	1.75	114.3x5.40	88.9x4.85	76.1x3.25	104
410 – SP19	8.50	5.00	1.75	1.75	139.7x4.50	114.3x3.65	88.9x3.25	109
410 – SP20	8.50	5.00	1.75	1.75	139.7x4.65	114.3x3.65	88.9x3.25	115
410 – SP21	8.50	5.00	1.75	1.75	165.1x5.40	114.3x4.50	88.9x3.25	129
410 – SP22	8.50	5.00	1.75	1.75	165.1x4.50	139.7x4.50	114.3x3.65	141
410 – SP23	8.50	5.00	1.75	1.75	165.1x4.85	139.7x4.50	114.3x3.65	148
410 – SP24	8.50	5.00	1.75	1.75	165.1x5.40	139.7x4.50	114.3x3.65	158
410 – SP25	9.00	5.00	2.00	2.00	114.3x3.65	88.9x3.25	76.1x3.25	78
410 – SP26	9.00	5.00	2.00	2.00	114.3x4.50	88.9x4.05	76.1x3.25	92
410 – SP27	9.00	5.00	2.00	2.00	114.3x5.40	88.9x4.85	76.1x3.25	108
410 – SP28	9.00	5.00	2.00	2.00	139.7x4.50	114.3x3.65	88.9x3.25	113
410 – SP29	9.00	5.00	2.00	2.00	139.7x4.85	114.3x4.50	88.9x3.25	125
410 – SP30	9.00	5.00	2.00	2.00	139.7x5.40	114.3x4.50	88.9x3.25	133
410 – SP31	9.00	5.00	2.00	2.00	165.1x4.50	139.7x4.50	114.3x3.65	147
410 – SP32	9.00	5.00	2.00	2.00	165.1x4.85	139.7x4.50	114.3x3.65	154
410 – SP33	9.00	5.00	2.00	2.00	165.1x5.40	139.7x4.50	114.3x3.65	164
410 – SP34	9.50	5.00	2.25	2.25	139.7x4.50	114.3x4.50	88.9x3.25	122
410 – SP35	9.50	5.00	2.25	2.25	139.7x4.85	114.3x4.50	88.9x3.25	129
410 – SP36	9.50	5.00	2.25	2.25	139.7x5.40	114.3x4.50	88.9x3.25	137
410 – SP37	9.50	5.00	2.25	2.25	165.1x4.50	139.7x4.50	114.3x3.65	153
410 – SP38	9.50	5.00	2.25	2.25	165.1x4.85	139.7x4.50	114.3x3.65	160
410 – SP39	9.50	5.00	2.25	2.25	165.1x5.40	139.7x4.50	114.3x3.65	170
410 – SP40	10.00	5.20	2.40	2.40	139.7x4.50	114.3x4.50	88.9x3.25	128
410 – SP41	10.00	5.20	2.40	2.40	139.7x4.85	114.3x4.50	88.9x3.25	135
410 – SP42	10.00	5.20	2.40	2.40	139.7x5.40	114.3x4.50	88.9x3.25	144
410 – SP43	10.00	5.20	2.40	2.40	165.1x4.50	139.7x4.50	114.3x3.65	160
410 – SP44	10.00	5.20	2.40	2.40	165.1x4.85	139.7x4.50	114.3x3.65	168
410 – SP45	10.00	5.20	2.40	2.40	165.1x5.40	139.7x4.50	114.3x3.65	178
410 – SP46	10.00	5.20	2.40	2.40	193.7x4.85	165.1x4.50	139.7x4.50	208
410 – SP47	10.00	5.20	2.40	2.40	193.7x5.40	165.1x4.50	139.7x4.50	221
410 – SP48	10.00	5.20	2.40	2.40	193.7x5.90	165.1x4.50	139.7x4.50	233
410 – SP49	11.00	5.60	2.70	2.70	139.7x4.50	114.3x4.50	88.9x3.25	140
410 – SP50	11.00	5.60	2.70	2.70	139.7x4.85	114.3x4.50	88.9x3.25	147
410 – SP51	11.00	5.60	2.70	2.70	139.7x5.40	114.3x4.50	88.9x3.25	164
410 – SP52	11.00	5.60	2.70	2.70	165.1x4.50	139.7x4.50	114.3x3.65	175
410 – SP53	11.00	5.60	2.70	2.70	165.1x4.85	139.7x4.50	114.3x3.65	183
410 – SP54	11.00	5.60	2.70	2.70	165.1x5.40	139.7x4.50	114.3x3.65	194
410 – SP55	11.00	5.60	2.70	2.70	193.7x4.85	165.1x4.50	139.7x4.50	227
410 – SP56	11.00	5.60	2.70	2.70	193.7x5.40	165.1x4.50	139.7x4.50	241
410 – SP57	11.00	5.60	2.70	2.70	193.7x5.90	165.1x4.85	139.7x4.50	256
410 – SP58	12.00	5.80	3.10	3.10	165.1x4.50	139.7x4.50	114.3x3.65	186
410 – SP59	12.00	5.80	3.10	3.10	165.1x4.85	139.7x4.50	114.3x3.65	197
410 – SP60	12.00	5.80	3.10	3.10	165.1x5.40	139.7x4.50	114.3x3.65	208
410 – SP61	12.00	5.80	3.10	3.10	193.7x4.85	165.1x4.50	139.7x4.50	245
410 – SP62	12.00	5.80	3.10	3.10	193.7x5.40	165.1x4.50	139.7x4.50	259
410 – SP63	12.00	5.80	3.10	3.10	193.7x5.90	165.1x4.85	139.7x4.50	277
410 – SP64	12.00	5.80	3.10	3.10	219.1x4.85	193.7x4.85	165.1x4.50	292
410 – SP65	12.00	5.80	3.10	3.10	219.1x5.60	193.7x4.85	165.1x4.50	313
410 – SP66	12.00	5.80	3.10	3.10	219.1x5.90	193.7x4.85	165.1x4.50	322
410 – SP67	13.00	5.80	3.60	3.60	193.7x4.85	165.1x4.50	139.7x 4.50	261
410 – SP68	13.00	5.80	3.60	3.60	193.7x5.40	165.1x4.85	139.7x 4.50	281
410 – SP69	13.00	5.80	3.60	3.60	193.7x5.90	165.1x5.40	139.7x 4.50	302
410 – SP70	13.00	5.80	3.60	3.60	219.1x4.85	193.7x4.85	165.1x4.50	312
410 – SP71	13.00	5.80	3.60	3.60	219.1x5.60	193.7x4.85	165.1x4.50	333
410 – SP72	13.00	5.80	3.60	3.60	219.1x5.90	193.7x4.85	165.1x4.50	343
410 – SP73	14.50	6.50	4.00	4.00	193.7x5.40	165.1x4.85	139.7x4.50	312
410 – SP74	14.50	6.50	4.00	4.00	193.7x5.90	165.1x5.40	139.7x4.50	336
410 – SP75	14.50	6.50	4.00	4.00	219.1x5.60	193.7x4.85	165.1x4.50	370
410 – SP76	14.50	6.50	4.00	4.00	219.1x5.90	193.7x4.85	165.1x4.50	380
410 – SP77	16.00	7.00	4.50	4.50	193.7x5.40	165.1x4.85	139.7x4.50	341
410 – SP78	16.00	7.00	4.50	4.50	193.7x5.90	165.1x5.40	139.7x4.50	367
410 – SP79	16.00	7.00	4.50	4.50	219.1x5.60	193.7x4.85	165.1x4.50	405
410 – SP80	16.00	7.00	4.50	4.50	219.1x5.90	193.7x4.85	165.1x4.50	416

HIGHMAST

High mast lighting is the most effective method of lighting large areas with the minimum number of obstructions. JINDAL is one of the largest supplier of high mast and polygonal poles, has achieved the distinction by continuous development, investment and better workmanship.



Why JINDAL High Masts?

- We provide flexible metallic conduits to protect the electrical wires from the luminaries to CG box connection.
- The material of construction of the pulleys is made of die-cast (LM-6) aluminum alloy.
- Buffer tubes are provided at the lantern are of better quality which prevent the scratching on the mast body during operation.
- Bolts, nuts, thimbles and other fitting accessories are made of Stainless steel material.
- The electrical items used in the feeder pillar are of high quality and the cable has also better insulation which makes our High Masts free of maintenance for long years.
- Unique double drum winch ensures smooth and maintenance less operation.
- The weather- proof cast aluminum junction boxes (IP- 55) shall be provided on the lantern Carriage assembly from which the inter- connections will be made to the designed number of floodlight fittings and lanterns on the carriage.
- We are equipped with the latest drafting and design software including for illumination of light.

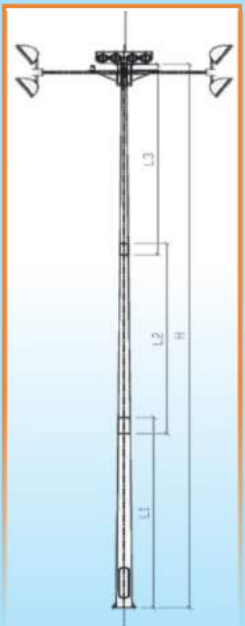

Application

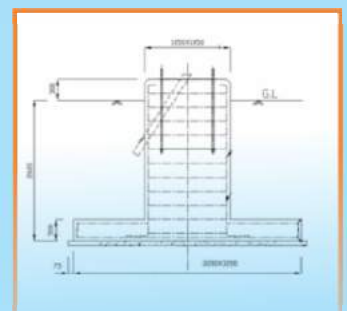
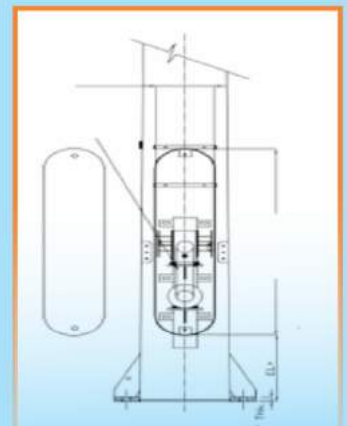
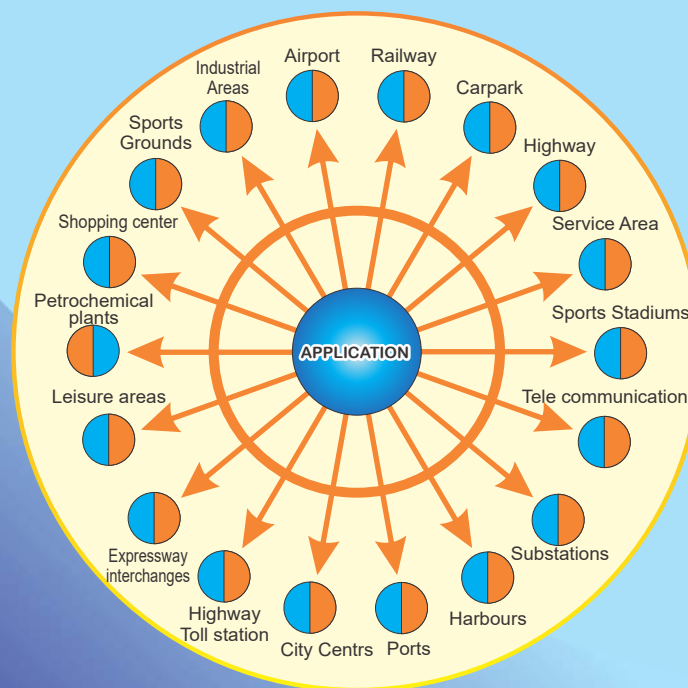

Custom made

JINDAL High Masts are manufactured at OEM factory. We are able to supply High Mast and Polygonal poles to suit standard in the world upto 40 meters.

Metal Protection

The entire mast shall be hot dip galvanized after fabrication, internally and externally in accordance with BSEN ISO 1461. Zinc tank of 14m is capable of single dip hot galvanizing which ultimately gives better finish.

Mast Structure

The mast shall be continuously tapered of polygonal cross section, presenting good visual appearance.

Mast Construction

Construction of the masts shall comply with BSEN 10 025 / IS 5986 Gr. Fe 510. Welding shall be in accordance with BSEN ISO 101 1/IS 10178. A door shall be provided in the base of the mast to permit clear access the lock base flange welded connection to the mast shall fully develops the strength of the section. The mast shall be delivered to site in section and joined with stressing equipment, thus forming a sleeve joint no site welding or bolted joints will be required.

Mechanical Arrangement

For installation and maintenance purpose it is possible to rise or lower the lantern carriage using a winch in the base of the mast. The steel wire rope supporting the lantern carriage shall be in tension at all times to prolong rope life and will not depend on latches for security.

Mast Head Assembly

The pulleys shall be of large diameter, appropriate for multi-core flexible cable. They shall be of non-corrosive material and run on self lubricating bearings with stainless steel spindles. Arrangements shall be provided to ensure that the electric cables and steel wire ropes are separated before passing over their respective pulleys to prevent ropes and cables leaving the pulleys' grooves. The complete chassis assembly shall be hot dip galvanized after fabrication. The pulley assembly shall be protected by a hot dip galvanized cover.

Lantern Carriages

The carriage shall be of durable steel tube designed to act as electric conduit. It shall be fitted with junction box mounting Stripes and be in two halves joined by bolted flanges to permit removal from the erected mast. The carriage shall incorporate buffer arrangements to prevent damage to the mast finish and luminaires and not require rollers or other moving parts.

Winches & Driving Tools

Winches shall be completely self-sustaining without the need for brakes, springs or clutches which require adjustment, or which can be affected by moisture or lubricant. The winches shall be self lubricating by means of an oil bath, and lubricant recommended by the supplier shall be used. Termination of the winch ropes shall not involve distortion or twisting of the ropes structure.

The winch shall be designed to be installed or removed through the door opening. Winch drums shall be grooved to ensure a tide rope lay. The capacity and gear ratio shall be clearly marked on each winch with an indelible label. The winch shall be capable of operation by hand or by means of a power tool. Each winch shall be supplied with a fitted waterproof cover. The power tool shall be a single speed reversible tool.



Steel Wire Ropes

Steel wire ropes shall be flexible 'marine grade' AIS SS 316 stainless steel of 7/19 construction. Thimbles and terminals shall be of compatible material. Steel wire ropes shall be factory cut terminated and pre-rigged for ease of installation.

Cable & Connections

Multi core flexible round/flat power cables shall be provided, terminating in the base compartment of the mast. At the mast head, cables shall be connected to a weatherproof junction box on the lantern ring equipped with suitable PVC glands. The equipment shall be suitably rated for the required duty.

Foundations & Earthing Terminal

Guaranteed performance, medium tensile, high yield, galvanized holding down bolts shall be supplied, complete with anchor plate for casting into the foundation.

Test Lead

A test lead or leads of multicore cable, equal to that within the mast fitted with a plug and socket, shall be provided to enable the lanterns and permanent supply cable to be tested when in the lowered position, using the base compartment socket supply.

Lightening Arrestor

A suitable lighting arrestor is provided on the top of the head frame cover at center position.

Aviation obstruction Lamp

An aviation obstruction light is provided - LED / GLS as per the client's requirements.

Feeder Pillar box

Feeder pillar boxes are made of powder-coated sheet metal. Panel consists of contactor, MCB and the timer for operating the luminaries and power tool.



Dimension of Standard Polygonal Lighting Mast

Product ID	Product Name	Top Diameter	Bottom Diameter	Section	Section Length	Section Thickness	Base Plate	Foundation Bolts
JPC/HW/12	12Mtr High Mast	100	310	2	12000	3/3	500X25	M24X750mm
JPC/HW/12	12Mtr High Mast	150	360	2	12000	3/3	520X25	M24X750mm
JPC/HW/12/A	12.5Mtr High Mast	100	310	2	12500	3/3	500X25	M24X750mm
JPC/HW/12/B	12.5Mtr High Mast	150	310	2	12500	3/3	500X25	M24X750mm
JPC/HW/12/C	12.5Mtr High Mast	150	360	2	12500	3/3	520X25	M24X750mm
JPC/HW/16	16Mtr High Mast	150	360	2	16000	3/3	520X25	M24X750mm
JPC/HW/16/A	16Mtr High Mast	150	410	2	16000	3/4	610X25	M24X850mm
JPC/HW/16/B	16Mtr High Mast	150	460	2	16000	3/4	650X25	M24X850mm
JPC/HW/20	20Mtr High Mast	150	410	2	20000	3/4	610X25	M24X850mm
JPC/HW/20/A	20Mtr High Mast	150	460	2	20000	4/4	650X25	M24X850mm
JPC/HW/25	25Mtr High Mast	150	460	3	25000	4/4/4	650X25	M24X850mm
JPC/HW/25/A	25Mtr High Mast	150	510	3	25000	3/4/5	710X30	M24X850mm
JPC/HW/25/B	25Mtr High Mast	150	540	3	25000	3/4/5	740X30	M24X850mm
JPC/HW/30	30Mtr High Mast	150	540	3	30000	3/4/5	740X30	M30X850mm
JPC/HW/30/A	30Mtr High Mast	150	610	3	30000	4/4/5	810X30	M30X850mm

Note: Dimensions are subject to change based on the location of mast installation, Luminary Type, Number, Distribution, Soil Condition, Design Life etc.

FRP / GRP POLE



Fiber Reinforced Polymer Pole or Glass Fiber Reinforced Polymer Pole Composite poles are high tech and innovative. Manufactured by CNC filament winding/centrifugal casting/ pultrusion, from UV inhibited unsaturated polyester resins selected to suit the environment, glass reinforcement geometry to meet the structural needs and complemented with a polyester non-woven veil to ensure a resin rich finish that provides durability and long life, our composite poles offer a modern solution to traditional problems. They are used in places where poles of other materials face serious problems, such as coastal areas where salinity may be detrimental as well as marshlands and areas with high temperature fluctuation. Essentially composite Poles are well suited for location where traditional materials struggle to offer a definite and lasting solution.

FEATURES

- Best for all atmospheric conditions.
- Long Lasting.
- Highly Non-Corrosive.
- Maintenance Free.
- Joint less, single piece construction up to 13 meters.
- Light weight, low handling cost.
- UV stabilised.
- Available in different colours.
- Radar Transparent.



ADVANTAGE

Light weight

- Lighter than Steel, Concrete & Wooden Poles Resulting in lower installation and transportation costs.

Maintenance

- No Maintenance required due to its inherent technical properties.

High Mechanical Strength

- Low mechanical stiffness of the composite material enables high mechanical strength of the Poles.

Frangibility

- In road traffic accidents involving poles, composite poles cause fewer deaths than steel or concrete poles, due to their ability to fall in a controlled manner.

Economical

- Composite Poles are less expensive than conventional poles and involve lower installation costs due to their light weight, they can be hand-carried to inaccessible places; do not require any surface treatments, servicing or painting.

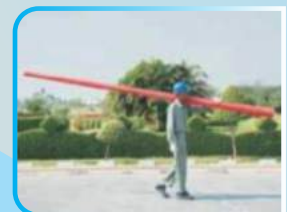

IDEAL FOR

- Coastal / Containment. Discharge Area where corrosion is the main concern
- Chemical / Petrochemical industries.
- Off-shore / On - shore facilities.
- Road lighting / Traffic lights / Road Signals / Airport & Defense Areas

JUNCTION BOX

Internal



External



FOUNDATION

Grouted

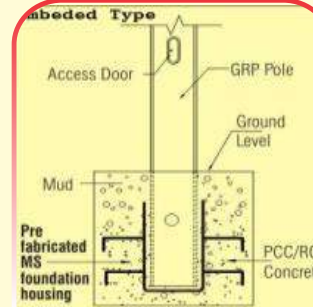

Base Plate Type

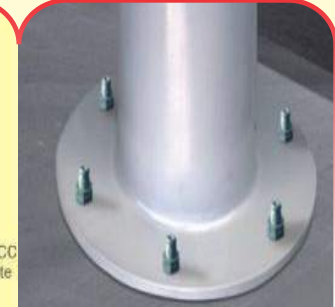

ACCESSORIES

Single Arm Bracket

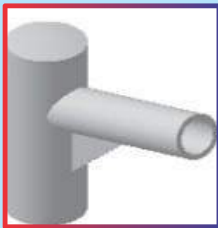

Double Arm Bracket

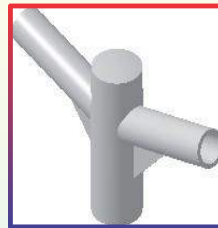

Base Bracket



APPLICATIONS OF COMPOSITE POLES

The excellent mechanical properties and resistance to chemical and corrosive attacks combined with simple installation techniques have evolved a wide variety of uses for Composite Poles to develop. In addition to the advantages already described, Composite Poles are aesthetically pleasing in any outdoor situation because of the wide range of colour choices and the pleasant appearance.

- Installation of electric lighting poles
- Installation of telephone lines
- Installation of lighting in chemical plants
- Traffic lights
- Directional Sign Systems
- Road lighting
- Urban equipment
- Lighting of park and other open spaces
- Advertising signs and standard poles
- Poles for protective barriers



METAL vs FRP

FEATURES	FRP POLE	METAL POLE
Concrete foundation	Not required	Required
Handling	Easy and hand carried	Very difficult
Joints	No joints	Many joints
Corrosion	Non-corrosive	Highly corrosive
Maintenance	Not required	Required due to rusting
Life	Long life	Less life compared to FRP
Yield	400-500MPa	410MPa
Painting process	Colour granules used at the time of winding and will last long	Hand painted and to be painted regularly
Electrocution	Nonconductive & shock proof	High risk
Ideal for environments	Ideal for all possible environments	Can't survive rains, coastal regions



Registered Office



JINDAL POWER CORPORATION

An ISO 9001:2015, OHSAS-18001:2007 Certified Company

33/96 Poorna Complex, Chowk Topi Bazaar

Kanpur 208021 U.P. (India)

Tele./Fax : +91-0512-2350502

Mob. 7754969996

Decorative Pole



Monopole



WORKS

Uttar Pradesh	02 units
West Bengal	02 units
Rajasthan	02 units
Odisha	01 unit
Karnataka	01 unit

Camera Pole



Flag Pole

