

DISTRIBUTION SOLUTIONS

SafeLink CB

Gas insulated ring main unit



—
Gas insulated
ring main unit

- SF6 gas insulated switchgear with extremely compact and robust design
- 12 kV, 630 A, 21 kA for 3 sec
- Metal enclosed design with IP54 protection
- IAC classified 21kA/1s
- Both sides extensible
- Stand alone vacuum circuit breakers or switch disconnectors
- Type tested according to latest IEC standards
- Robotically welded SS304 tank
- Vacuum circuit breaker with high mechanical endurance of 10000 operations
- Maintenance free and complete safety with no exposure to live parts
- Mandatory safety interlocks ensuring operator safety
- Manufactured according to ISO 9001, 14001 and OHSAS 18001
- Complete solutions, including applications for remote control and monitoring
- Recyclable and very low environmental impact

Technical data

		C Module		V Module	
		Switch disconnecter	Earthing switch	Vacuum circuit breaker	Earthing switch
Rated voltage	kV	12/13.8	12/13.8	12/13.8	12/13.8
Rated frequency	Hz	50/60	50/60	50/60	50/60
Power frequency withstand voltage	kVrms	38	38	38	38
- across disconnecter	kVrms	45	45	45	45
Lightning impulse withstand voltage	kVp	95	95	95	95
- across isolating distance	kVp	110	110	110	110
Rated normal current*	A	630	630	630	630
Breaking capacities					
- active load breaking current	A	630			
- closed loop breaking current	A	630			
- cable charging breaking current	A	25		25 (Class C2)	
- line charging breaking current	A	1		10 (Class C2)	
- earth fault breaking current	A	75			
- earth fault cable and line charging	A	43.5			
- short circuit breaking current	kA			21	
Making capacity	kAp	52.5/54.6	52.5/54.6	52.5/54.6	52.5/54.6 ¹⁾
Short time current (3-sec)	kA	21	21	21	21
Short time current (1-sec)	kA		21 (Earthing circuit)		21 (Earthing Circuit)
Electrical & mechanical classes		E3, C2, M1	E2, M0	E2, C2, S1, M1+3000, M2 (Optional)	E2, M0
Rated operating sequence	-			0-0.3 sec-CO-3 min-CO	
Rated filling level for insulation		0.02 MPa			
Internal arc classification		AFLR 10kA 0.1s / AF 21kA 1s			

1) Earthing operation is through vacuum circuit breaker, hence no making capacity is assigned.

Dimensions

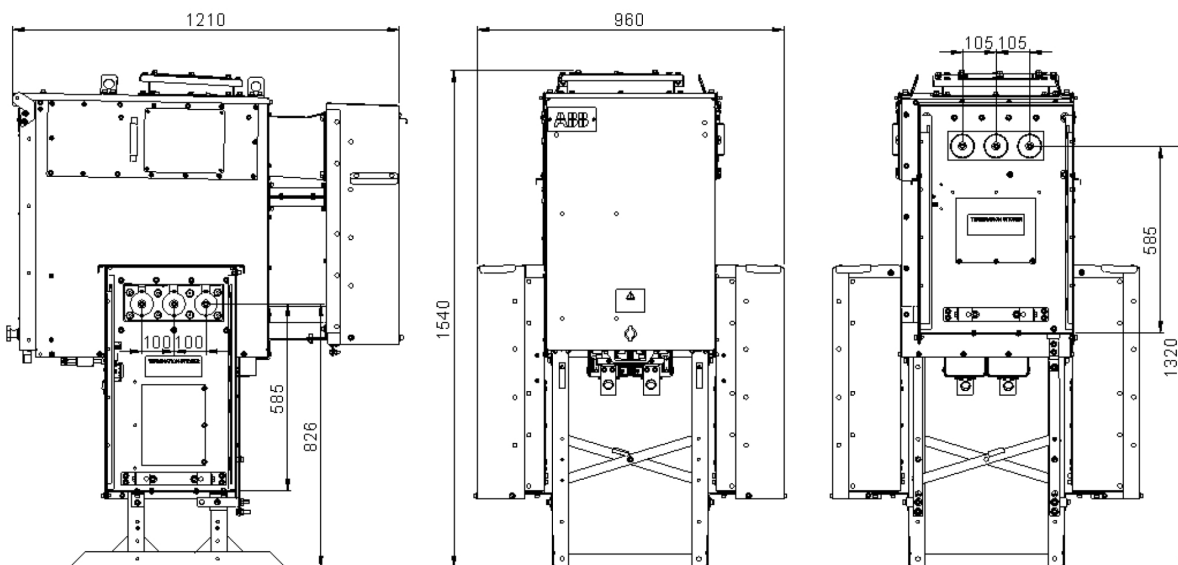

For more information, please contact service department at **ABB India Limited**
Plot No. 79, Street No. 17, MIDC Estate, Satpur, Nashik, Maharashtra -422 007, India
Tel: +91 253-2201200 Fax: +91 253-2351260

abb.com/mediumvoltage

NOTE:
Data and illustration are not binding. We reserve the right to make changes in the course of technical development.