

Weld-Less Fastening Systems



BLIND RIVET NUTS (INSERTS)





Certificate of Registration

STATE ENTERPRISES
43, STREET NO- 1, SAMAIPUR INDUSTRIAL AREA,
DELHI- 110042; INDIA

Equalitas Certifications Limited Certifies that the Management System of the above mentioned Company has been assessed and meets the requirement established by the following rules:

ISO 9001:2008

The Management System Includes :

TRADING OF BLIND FASTENERS



Certificate No: **02120801** Valid From: **01 Aug 2012** Valid Till: **31 Jul 2015***

1st Surv. Due Before - **1 Aug 2013** 2nd Surv. Due Before- **1 Aug 2014**

*** After Successful Completion of Surveillance Audit New Certificate Shall Be Issued.**

In the course of validity of the present certificate the enterprise management system must permanently satisfy the requirements of the international regulations the fulfillment of these regulations will be regularly controlled by Equalitas Certifications Limited



Director



Equalitas Certifications Limited

URL: www.theeci.com

Accreditation by Joint Accreditation System of Australia and New Zealand (Accreditation No. M44102100)

4 Phipps Close DEAKIN, ACT 2600, AUSTRALIA

For precise and updated information concerning possible changes occurred in the certification objective of the present certificate, please contact info@theeci.com
Rev. 05

COMPANY PROFILE **We ensure qualitative products and solutions**

State Enterprises is a leading name in offering blind fasteners, with its Head Office situated in Delhi. Being an importer and distributor of exclusive blind fasteners, the company provides an array of Blind Rivets, Rivet Nuts, Self Drilling Screws, Self Clinching Fasteners and Riveting Tools.

We also provide industrial fasteners and fastening systems to the automotive, aircraft, switchgear, white goods and electronics industries in India. In addition we have Authorized Distributors in Bangalore, Bombay, Calcutta, Madras, Hyderabad and Pune.

Our approach of marketing, dealership and service network, ensure a high degree of consumer satisfaction and excellent after sales service to the end user. Our alignment and attention to customer centric approach has helped us to remain unbeaten in providing state-of-the-art services added with an excellent after sales and technical support.

State Enterprises offer India's largest range of products and permanently stock 40 million pieces. Our Research and Development Department takes utmost initiative in assisting many of the major manufacturers in finding solutions for their products. And our quality measures assure the qualitative products and services to our valued customers.

VISION

To be the partner of choice in hardware top quality products and fittings for every selected domain, so as to be a major role-player in the development of the country.

MISSION

To compete with the global players and facilitate products & solutions which are at par with international standards.

QUALITY

State Enterprises success has been and will continue to be based on a commitment to provide its customers with the best quality products and services available. As the needs of industrial customers have changed, State Enterprises has invested in its people, equipment and technology necessary to continue its tradition. Our expertise has enabled us to guarantee constant operational quality.

About Blind Rivet Nuts

A Blind Rivet Nut is a reliable and low cost system of inserting high quality, load bearing threads in thin gauge materials. Rivet nuts offer many benefits over nuts and bolts, weld nuts, self-tapping screws and pressed inserts.

State Enterprises offers intelligent fastening systems and the most suitable installation tools and assembly stations to join components reliably and efficiently. Wherever you need high quality, load bearing threads in thin materials, the State Enterprises Blind Rivet Nut System offers the ideal solution quickly and reliably installed without rework or damage to the parent application, even with painted sheet materials and tubes where there is no blind side access. State Enterprises Rivet Nuts are most commonly used in the automotive, vehicle, electronics chassis manufacturing, equipment manufacturing and shipbuilding industries. The wide variety of State Enterprises Rivet Nuts provide perfect engineering results and economic solutions in every application. Together with our customers, we develop blind fastening systems that simplify your production processes and improve the quality of your products. We see ourselves not only as a provider of fasteners, tools and assembly systems, but also as a system and development partner with the objective of helping our customers improve their assembly performance.

Benefits of Assembly

➤ **Blind Sided Assembly**

Access is needed to only one side of the work piece. These results in increased speed of assembly, lower assembly costs, reduced operator error and is ideal for assembly of box or closed sections.

➤ **Thin Sheet Application**

Rivet Nuts can be installed into material as thin as 0.50mm providing strong load bearing threads.

➤ **Purely Mechanical Fastening**

State Enterprises Rivet Nuts can be used to join dissimilar materials. They avoid damage of surface coatings and thus can be installed in pre as well as in post finished applications. The work piece is not affected by a welding process.

➤ **Designed for Rapid Rate of Installation**

The typical assembly cycle of 3 seconds reduces assembly time and costs.

➤ **Designed for Automation**

State Enterprises Rivet Nuts can be installed fully automatically resulting in a high speed and precision assembly. The set up costs are lower compared to welding equipment.

➤ **Forms a Permanent Fixture in Material**

State Enterprises Rivet Nuts deliver a vibration resistant joint without requiring maintenance.

➤ **Speed with no Specialized Labor**

Rivet Nuts can be installed at the rate of 20 pieces per minute with pneumatic power tools and can be installed with semi skilled labor with minimal training.

➤ **Multi-Functional Fastener**

Rivet Nuts feature multi functions: they provide a female thread in sheet while giving the opportunity to clamp two or more sheets at the same time; can act as a spacer –resulting in fewer components required.

➤ **Suitable for a Wide Range of Installation Tools**

The facilities of installation range from hand tools for small batch and repair work and pneumatic tools for medium volume up to full automation for in-line assembly.

➤ **Environment Friendly**

Installation is environmentally friendly and produces no harmful gases, heat, dust, or electromagnetic fields to affect workers.

Selecting a Correct Rivet Nut

Selecting a Rivet Nut is a simple process. The six factors detailed below are designed to help you identify an insert suitable for your application:

➤ **Thread Size**

State Enterprises Rivet Nuts range from M3 to M12 thread sizes dependent upon the insert.

➤ **Grip Range**

The Rivet Nut should be selected to ensure that the thicknesses of the parent material(s) falls within the grip range.

➤ **Hole Size**

This is specified on the relevant technical data page for the insert. Allowance for coating the parent material should be made to avoid an undersized hole.

➤ **Torque-to-Turn**

Resistance is dependent upon the body shape and increases in the series: round, splined, hexagonal and square.

➤ **Special Features**

Additional features such as low profile, large flange, closed end and countersunk are available within the standard range of products.

➤ **Corrosion Resistance**

The selection of the material type and coating of the Rivet Nut should be made on the basis of the corrosion resistance required.

How Rivet Nut Works

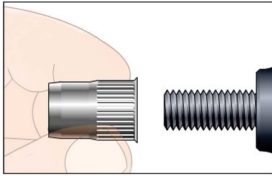

Nutsert

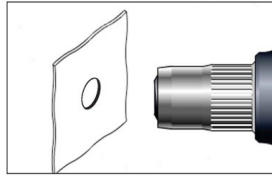

Positioning Nutsurt

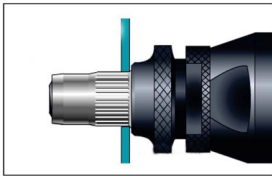

Before Expanding

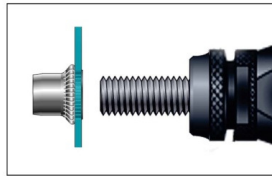

After Expanding

Applications



Aerospace Industry

Automotive Industry

Building Construction

Electrical Electronics Industry

Medical Instruments

BLIND RIVET NUTS

STEEL

Open End

Round Body With Groove, Reduced Head - Steel
 Material : Steel
 Finish : Zinc Plated clear trivalent passivated

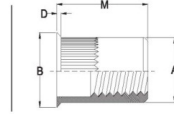

Metric / 6H

Thread Size	Grip Range	Hole Size	Body Dia				Head Diameter	Head Height	Recommended Max Torque	Pull-out	Torque-To-Turn	Push-out	Part Number
			A (max)	M (+/- 0.2)	B (+/- 0.3)	D (+/- 0.2)							
	(min - max)												
M3 x 0.5	0.5 - 2.0	4.8	4.72	8.7	5.3	0.4	1.5	2.7	0.4	0.8		M3-R-G-RH-S-A	
M4 x 0.7	0.5 - 2.5	6.4	6.35	10.4	7.3	0.5	5.1	6.6	1.9	1.5		M4-R-G-RH-S-A	
M5 x 0.8	0.5 - 2.5	7.2	7.10	12	8.1	0.5	7.9	8.0	2.6	1.9		M5-R-G-RH-S-A	
M6 x 1.0	0.7 - 3.2	9.8	9.50	15	10.5	0.5	12.4	11.4	3.4	2.4		M6-R-G-RH-S-A	
M8 x 1.25	0.7 - 3.2	10.6	10.50	18	11.5	0.5	18.4	15.7	3.6	2.8		M8-R-G-RH-S-A	
M10 x 1.5	0.7 - 3.5	12.8	12.70	19	13.9	0.6	33.9	18.7	4.2	3.7		M10-R-G-RH-S-A	

Round Body With Groove, Reduced Head - Steel - European

M3 x 0.5	0.5 - 2.0	5.0	4.95	9.0	6.0	0.5	1.5	2.7	0.4	0.8		M3-R-G-RH-S-E
M4 x 0.7	0.5 - 2.5	8.0	5.95	10.0	7.0	0.5	5.1	3.8	2.0	1.2		M4-R-G-RH-S-E
M5 x 0.8	0.5 - 3.0	7.0	6.95	12.0	8.0	0.5	7.9	7.8	2.8	1.4		M5-R-G-RH-S-E
M6 x 1.0	0.7 - 3.2	9.0	8.95	15.0	10.0	0.5	12.4	15.8	5.0	2.6		M6-R-G-RH-S-E
M8 x 1.25	0.7 - 3.2	11.0	10.95	18.0	12.0	0.5	32.0	18.1	9.1	3.5		M8-R-G-RH-S-E
M10 x 1.5	0.7 - 3.2	13.0	12.95	20.0	14.0	0.7	45.0	20.8	16.7	3.9		M10-R-G-RH-S-E

Round Body With Groove, Reduced Head - Long - Steel - European

M4 x 0.7	2.5 - 4.0	8.0	5.95	12	7.0	0.5	5.1	3.8	2.0	1.2		M4-R-G-RH-L-S-E
M5 x 0.8	2.5 - 4.5	7.0	6.95	14	8.0	0.5	7.9	7.8	2.8	1.4		M5-R-G-RH-L-S-E
M6 x 1.0	3.0 - 5.0	9.0	8.95	17	10.0	0.5	12.4	15.8	5.0	2.6		M6-R-G-RH-L-S-E
M8 x 1.25	3.0 - 5.5	11.0	10.95	18.5	12.0	0.5	32.0	18.1	9.1	3.5		M8-R-G-RH-L-S-E
M10 x 1.5	3.5 - 6.0	13.0	12.95	23.5	14.0	0.6	45.0	20.8	16.7	3.9		M10-R-G-RH-L-S-E

Unified / 2B

Thread Size	Grip Range	Hole Size	Body Dia				Head Diameter	Head Height	Recommended Max Torque	Pull-out	Torque-To-Turn	Push-out	Part Number
			A (max)	M (+/- 0.219)	B (+/- 0.3)	D (+/- 0.208)							
	(min - max)												
UNC 6-32	0.020 - 0.080	0.250	0.249	0.410	0.295	0.018	0.018	45	920	17	310		UNC 6-32-R-G-RH-S-A
UNC 8-32	0.020 - 0.080	0.250	0.249	0.410	0.295	0.018	45	920	17	310		UNC 8-32-R-G-RH-S-A	
UNC 10-24	0.020 - 0.130	0.281	0.279	0.470	0.319	0.020	70	1280	23	445		UNC 10-24-R-G-RH-S-A	
UNF 10-32	0.020 - 0.130	0.281	0.279	0.470	0.319	0.020	70	1280	23	445		UNF 10-32-R-G-RH-S-A	
UNC 14-20	0.020 - 0.165	0.375	0.374	0.590	0.413	0.020	110	1520	30	560		UNC 14-20-R-G-RH-S-A	
UNC 5/16-18	0.040 - 0.200	0.500	0.498	0.690	0.543	0.022	145	3300	31	632		UNC 5/16-18-R-G-RH-S-A	

Close End

Round Body With Groove, Reduced Head - Close Type - Steel
 Material : Steel
 Finish : Zinc Plated clear trivalent passivated

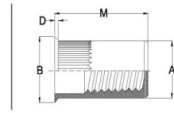

Metric / 6H

Thread Size	Grip Range	Hole Size	Body Dia				Head Diameter	Head Height	Recommended Max Torque	Pull-out	Torque-To-Turn	Push-out	Part Number
			A (max)	M (+/- 0.2)	B (+/- 0.3)	D (+/- 0.2)							
	(min - max)												
M4 x 0.7	0.5 - 2.5	6.0	5.95	15.0	6.8	0.5	5.1	6.6	1.9	1.5		M4-R-G-RH-CT-S-E	
M5 x 0.8	0.5 - 3.0	7.0	6.95	18.0	8.0	0.5	7.9	8.0	2.6	1.9		M5-R-G-RH-CT-S-E	
M6 x 1.0	0.5 - 3.0	9.0	8.95	21.5	9.9	0.5	12.4	11.4	3.4	2.4		M6-R-G-RH-CT-S-E	
M8 x 1.25	0.5 - 3.0	11.0	10.95	22.0	12.0	0.5	32.0	15.7	3.6	2.8		M8-R-G-RH-CT-S-E	

STEEL

Open End

Round Body With Groove, Flat Head - Steel

Material : Steel

Finish : Zinc Plated clear trivalent passivated

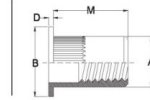

Metric / 6H

Round Body With Groove, Flat Head - Steel - European											
Thread Size	Grip Range	Hole Size	Body Dia	Body Length	Head Diameter	Head Height	Recommended Max Torque	Pull-out	Torque-To-Turn	Push-out	Part Number
	(min - max)	A (max)	M (+/- 0.2)	B (+/- 0.3)	D (+/- 0.2)	Nm (max)	kN	Nm (min)	kN		
M3 x 0.5	0.5 - 2.0	5.0	4.96	9.7	8.0	0.8	1.5	4.2	1.1	1.8	M3-R-G-FH-S-E
M4 x 0.7	0.5 - 2.5	6.0	5.96	10.5	9.0	0.8	5.1	5.5	2.2	2.9	M4-R-G-FH-S-E
M5 x 0.8	0.5 - 2.5	7.0	6.96	12.0	10.0	1.0	7.9	8.0	3.4	4.2	M5-R-G-FH-S-E
M6 x 1.0	1.0 - 3.5	9.0	8.96	14.5	13.0	1.5	12.4	10.8	4.7	6.5	M6-R-G-FH-S-E
M8 x 1.25	1.0 - 4.0	11.0	10.96	16.0	16.0	1.5	32.0	12.5	6.8	7.9	M8-R-G-FH-S-E
M10 x 1.5	1.0 - 4.0	13.0	12.96	22.0	19.0	2.0	45.0	17.3	16.7	10.7	M10-R-G-FH-S-E
M12 x 1.75	1.0 - 5.0	16.0	15.96	23.5	22.0	2.0	N/A	N/A	N/A	N/A	M12-R-G-FH-S-E

Round Body With Groove, Flat Head - Long - Steel - European											
Thread Size	Grip Range	Hole Size	Body Dia	Body Length	Head Diameter	Head Height	Recommended Max Torque	Pull-out	Torque-To-Turn	Push-out	Part Number
	(min - max)	A (max)	M (+/- 0.2)	B (+/- 0.3)	D (+/- 0.2)	Nm (max)	kN	Nm (min)	kN		
M4 x 0.7	2.5 - 3.5	6.0	5.96	11.7	9.0	0.8	5.1	5.5	2.2	2.9	M4-R-G-FH-L-S-E
M5 x 0.8	2.5 - 4.5	7.0	6.96	13.5	10.0	1.0	7.9	8.0	3.4	4.2	M5-R-G-FH-L-S-E
M6 x 1.0	3.0 - 5.0	9.0	8.96	17.0	13.0	1.5	12.4	10.8	4.7	6.5	M6-R-G-FH-L-S-E
M8 x 1.25	3.5 - 5.5	11.0	10.96	19.5	15.0	1.5	32.0	12.5	6.8	7.9	M8-R-G-FH-L-S-E
M10 x 1.5	3.5 - 5.5	13.0	12.96	23.5	19.0	2.0	45.0	17.3	16.7	10.7	M10-R-G-FH-L-S-E

Close End

Round Body With Groove, Flat Head - Close Type - Steel

Material : Steel

Finish : Zinc Plated clear trivalent passivated

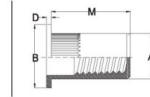

Metric / 6H

Round Body With Groove, Flat Head - Close Type - Steel - European											
Thread Size	Grip Range	Hole Size	Body Dia	Body Length	Head Diameter	Head Height	Recommended Max Torque	Pull-out	Torque-To-Turn	Push-out	Part Number
	(min - max)	A (max)	M (+/- 0.2)	B (+/- 0.3)	D (+/- 0.2)	Nm (max)	kN	Nm (min)	kN		
M4 x 0.7	0.5 - 2.5	6.0	5.96	14.9	9.0	0.8	5.1	5.5	1.5	2.9	M4-R-G-FH-CT-S-E
M5 x 0.8	0.5 - 2.5	7.0	6.96	17.0	10.0	1.0	7.9	8.0	3.0	4.2	M5-R-G-FH-CT-S-E
M6 x 1.0	1.0 - 3.5	9.0	8.96	20.0	13.0	1.5	12.4	10.8	3.4	6.5	M6-R-G-FH-CT-S-E
M8 x 1.25	1.0 - 4.0	11.0	10.96	23.5	16.0	1.5	32.0	12.5	5.6	7.9	M8-R-G-FH-CT-S-E
M10 x 1.5	1.0 - 4.0	13.0	12.96	31.0	19.0	2.0	45.0	17.3	16.7	10.7	M10-R-G-FH-CT-S-E

BLIND RIVET NUTS

STEEL

Open End

Hex Body, Reduced Head - Steel

Material : Steel

Finish : Zinc Plated clear trivalent passivated

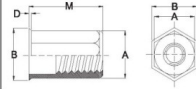

Hex Body, Reduced Head - Steel - European											
Thread Size	Grip Range	Hole Size	Body Dia	Body Length	Head Diameter	Head Height	Recommended Max Torque	Pull-out	Torque-To-Turn	Push-out	Part Number
	(min - max)		A (max)	M (+/- 0.2)	B (+/- 0.3)	D (+/- 0.2)	Nm (max)	kN	Nm (min)	kN	
M4 x 0.7	0.5 - 2.5	6.0	5.95	10.3	7.0	0.5	5.1	6.3	4.2	1.4	M4-HRH-S-E
M5 x 0.8	0.5 - 3.0	7.0	6.95	12.2	8.0	0.5	7.9	8.8	7.5	2.6	M5-HRH-S-E
M6 x 1.0	0.5 - 3.3	9.0	8.95	15.0	10.0	0.6	12.4	14.4	10.7	3.2	M6-HRH-S-E
M8 x 1.25	0.5 - 3.3	11.0	10.95	17.8	12.0	0.6	32.0	15.0	22.7	4.1	M8-HRH-S-E
M10 x 1.5	0.5 - 3.5	13.0	12.95	23.0	14.5	0.8	45.0	19.7	38.5	5.2	M10-HRH-S-E

Hex Body, Reduced Head - Long - Steel - European											
Thread Size	Grip Range	Hole Size	Body Dia	Body Length	Head Diameter	Head Height	Recommended Max Torque	Pull-out	Torque-To-Turn	Push-out	Part Number
	(min - max)		A (max)	M (+/- 0.2)	B (+/- 0.3)	D (+/- 0.2)	Nm (max)	kN	Nm (min)	kN	
M4 x 0.7	2.0 - 3.0	6.0	5.95	12.2	7.0	0.5	5.1	6.3	4.2	1.4	M4-HRH-L-S-E
M5 x 0.8	3.0 - 4.5	7.0	6.95	14.8	8.0	0.5	7.9	8.8	7.5	2.6	M5-HRH-L-S-E
M6 x 1.0	3.0 - 4.5	9.0	8.95	17.8	10.0	0.5	12.4	14.4	10.7	3.2	M6-HRH-L-S-E
M8 x 1.25	3.0 - 4.5	11.0	10.95	19.0	12.0	0.6	32.0	15.0	22.7	4.1	M8-HRH-L-S-E
M10 x 1.5	3.0 - 5.0	13.0	12.95	25.0	14.5	0.8	45.0	19.7	38.5	5.2	M10-HRH-L-S-E

Close End

Hex Body, Reduced Head - Close Type - Steel

Material : Steel

Finish : Zinc Plated clear trivalent passivated

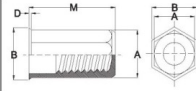

Hex Body, Reduced Head - Close Type - Steel - European											
Thread Size	Grip Range	Hole Size	Body Dia	Body Length	Head Diameter	Head Height	Recommended Max Torque	Pull-out	Torque-To-Turn	Push-out	Part Number
	(min - max)		A (max)	M (+/- 0.2)	B (+/- 0.3)	D (+/- 0.2)	Nm (max)	kN	Nm (min)	kN	
M4 x 0.7	0.5 - 2.5	6.0	5.95	17.0	7.0	0.5	5.1	6.3	4.2	1.4	M4-HRH-CT-S-E
M5 x 0.8	0.5 - 3.0	7.0	6.95	20.0	8.0	0.5	7.9	8.8	7.5	2.6	M5-HRH-CT-S-E
M6 x 1.0	0.5 - 3.3	9.0	8.95	22.0	10.0	0.6	12.4	14.4	10.7	3.2	M6-HRH-CT-S-E
M8 x 1.25	0.5 - 3.3	11.0	10.95	28.0	12.0	0.6	32.0	15.0	22.7	4.1	M8-HRH-CT-S-E

STEEL

Open End

Hex Body, Flat Head - Steel

Material : Steel

Finish : Zinc Plated clear trivalent passivated

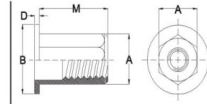

Hex Body, Flat Head - Steel - European											Metric / 6H
Thread Size	Grip Range	Hole Size	Body Dia	Body Length	Head Diameter	Head Height	Recommended Max Torque	Pull-out	Torque-To-Turn	Push-out	Part Number
	(min - max)		A (max)	M (+/- 0.2)	B (+/- 0.3)	D (+/- 0.2)	Nm (max)	kN	Nm (min)	kN	
M4 x 0.7	0.5 - 2.5	6.0	5.95	10.3	9.0	0.9	5.1	6.3	4.5	2.2	M4-H-FH-S-E
M5 x 0.8	0.5 - 3.0	7.0	6.95	12.0	10.0	1.0	7.9	8.8	8.6	3.6	M5-H-FH-S-E
M6 x 1.0	0.5 - 3.3	9.0	8.95	14.5	13.0	1.5	12.4	14.4	11.9	5.3	M6-H-FH-S-E
M8 x 1.25	0.5 - 3.3	11.0	10.95	16.5	16.0	1.5	32.0	15.0	25.0	8.0	M8-H-FH-S-E
M10 x 1.5	0.5 - 3.5	13.0	12.95	22.0	19.0	2.0	45.0	19.7	45.2	9.2	M10-H-FH-S-E
Hex Body, Flat Head - Long - Steel - European											
M4 x 0.7	2.0 - 3.5	6.0	5.95	11.8	9.0	0.9	5.1	6.3	4.5	2.2	M4-H-FHL-S-E
M5 x 0.8	3.0 - 4.5	7.0	6.95	13.5	10.0	1.0	7.9	8.8	8.6	3.6	M5-H-FHL-S-E
M6 x 1.0	3.0 - 5.0	9.0	8.95	16.5	13.0	1.5	12.4	14.4	11.9	5.3	M6-H-FHL-S-E
M8 x 1.25	3.0 - 5.0	11.0	10.95	19.0	16.0	1.5	32.0	15.0	25.0	8.0	M8-H-FHL-S-E
M10 x 1.5	3.0 - 5.5	13.0	12.95	23.5	19.0	2.0	45.0	19.7	45.2	9.2	M10-H-FHL-S-E

Close End

Hex Body, Flat Head - Close Type - Steel

Material : Steel

Finish : Zinc Plated clear trivalent passivated

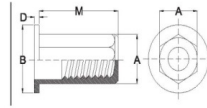

Hex Body, Flat Head - Close Type - Steel - European											Metric / 6H
Thread Size	Grip Range	Hole Size	Body Dia	Body Length	Head Diameter	Head Height	Recommended Max Torque	Pull-out	Torque-To-Turn	Push-out	Part Number
	(min - max)		A (max)	M (+/- 0.2)	B (+/- 0.3)	D (+/- 0.2)	Nm (max)	kN	Nm (min)	kN	
M4 x 0.7	0.5 - 2.5	6.0	5.95	14.0	9.0	0.9	5.1	6.3	4.5	2.2	M4-H-FH-CT-S-E
M5 x 0.8	0.5 - 3.0	7.0	6.95	19.0	10.0	1.0	7.9	8.8	8.6	3.6	M5-H-FH-CT-S-E
M6 x 1.0	0.5 - 3.3	9.0	8.95	21.5	13.0	1.5	12.4	14.4	11.9	5.3	M6-H-FH-CT-S-E
M8 x 1.25	0.5 - 3.3	11.0	10.95	25.0	16.0	1.5	32.0	15.0	25.0	8.0	M8-H-FH-CT-S-E
M10 x 1.5	0.5 - 3.5	13.0	12.95	31.0	19.0	2.0	45.0	19.7	45.2	9.2	M10-H-FH-CT-S-E

BLIND RIVET NUTS

STEEL

Open End

Semi Hex Body, Reduced Head - Steel

Material : Steel

Finish : Zinc Plated clear trivalent passivated

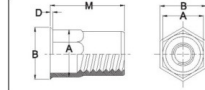

Metric / 6H

Semi Hex Body, Reduced Head - Steel											
Thread Size	Grip Range (min - max)	Hole Size	Body Dia		Head Diameter	Head Height	Recommended Max Torque Nm (max)	Pull-out kN	Torque-To-Turn Nm (min)	Push-out kN	Part Number
			A (max)	M (+/- 0.2)							
M4 x 0.7	0.5 - 2.5	6.35	6.25	10.5	7.0	0.5	5.1	4.2	4.0	1.3	M4-SH-RH-S-A
M5 x 0.8	0.5 - 3.0	7.20	7.10	12.0	8.0	0.5	7.9	5.9	6.8	1.9	M5-SH-RH-S-A
M6 x 1.0	0.5 - 3.3	8.60	8.50	14.5	10.6	0.6	12.4	6.9	8.7	2.4	M6-SH-RH-S-A
M8 x 1.25	0.5 - 3.5	10.60	10.50	18.0	11.5	0.6	16.4	14.8	11.8	2.8	M8-SH-RH-S-A
M10 x 1.5	0.5 - 3.8	12.70	12.60	19.5	14.0	0.8	33.9	15.0	21.0	3.2	M10-SH-RH-S-A
Semi Hex Body, Reduced Head - Steel - European											
M4 x 0.7	0.5 - 2.5	8.0	5.95	10.5	7.0	0.5	5.1	6.3	4.2	1.4	M4-SH-RH-S-E
M5 x 0.8	0.5 - 3.0	7.0	6.95	11.7	8.0	0.5	7.9	8.8	7.5	2.6	M5-SH-RH-S-E
M6 x 1.0	0.5 - 3.3	9.0	8.95	14.5	10.0	0.6	12.4	14.4	10.7	3.2	M6-SH-RH-S-E
M8 x 1.25	0.5 - 3.5	11.0	10.95	16.5	12.0	0.8	32.0	15.0	22.7	4.1	M8-SH-RH-S-E
M10 x 1.5	0.5 - 3.8	13.0	12.95	20.0	14.5	0.8	45.0	19.7	38.5	5.2	M10-SH-RH-S-E
Semi Hex Body, Reduced Head - Long - Steel - European											
M5 x 0.8	3.0 - 5.5	7.0	6.95	15.2	8.0	0.5	7.9	8.8	7.5	2.6	M5-SH-RH-L-S-E
M6 x 1.0	3.0 - 5.5	9.0	8.95	17.5	10.0	0.6	12.4	14.4	10.7	3.2	M6-SH-RH-L-S-E
M8 x 1.25	3.0 - 5.5	11.0	10.95	20.0	12.0	0.6	32.0	15.0	22.7	4.1	M8-SH-RH-L-S-E

Close End

Semi Hex Body, Reduced Head - Close Type - Steel

Material : Steel

Finish : Zinc Plated clear trivalent passivated

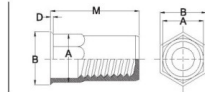

Metric / 6H

Semi Hex Body, Reduced Head - Close Type - Steel - European											
Thread Size	Grip Range (min - max)	Hole Size	Body Dia		Head Diameter	Head Height	Recommended Max Torque Nm (max)	Pull-out kN	Torque-To-Turn Nm (min)	Push-out kN	Part Number
			A (max)	M (+/- 0.2)							
M4 x 0.7	0.5 - 2.5	8.0	5.95	16.3	7.0	0.5	5.1	6.3	4.2	1.4	M4-SH-RH-CT-S-E
M5 x 0.8	0.5 - 3.0	7.0	6.95	18.3	8.0	0.5	7.9	8.8	7.5	2.6	M5-SH-RH-CT-S-E
M6 x 1.0	0.5 - 3.3	9.0	8.95	21.3	10.0	0.6	12.4	14.4	11.9	5.3	M6-SH-RH-CT-S-E
M8 x 1.25	0.5 - 3.5	11.0	10.95	23.8	12.0	0.6	32.0	15.0	25.0	8.0	M8-SH-RH-CT-S-E

STEEL

Open End

Semi Hex Body, Flat Head - Steel

Material : Steel

Finish : Zinc Plated clear trivalent passivated

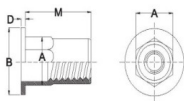

Metric / 6H

Semi Hex Body, Flat Head - Steel - European											
Thread Size	Grip Range	Hole Size	Body Dia	Body Length	Head Diameter	Head Height	Recommended Max Torque	Pull-out	Torque-To-Turn	Push-out	Part Number
	(min - max)		A (max)	M (+/- 0.2)	B (+/- 0.3)	D (+/- 0.2)	Nm (max)	kN	Nm (min)	kN	
M4 x 0.7	0.5 - 2.5	6.0	5.95	9.0	9.0	1.0	5.1	6.3	4.5	2.2	M4-SH-FH-S-E
M5 x 0.8	0.5 - 3.0	7.0	6.95	12.0	10.0	1.0	7.9	8.8	8.6	3.6	M5-SH-FH-S-E
M6 x 1.0	0.5 - 3.3	9.0	8.95	14.5	13.0	1.5	12.4	14.4	11.9	5.3	M6-SH-FH-S-E
M8 x 1.25	0.5 - 3.3	11.0	10.95	16.5	16.0	1.5	32.0	15.0	25.0	8.0	M8-SH-FH-S-E
M10 x 1.5	0.5 - 3.5	13.0	12.95	20.0	19.0	2.0	45.0	19.7	45.2	9.2	M10-SH-FH-S-E
Semi Hex Body, Flat Head - Long - Steel - European											
M4 x 0.7	0.5 - 2.5	6.0	5.95	11.0	9.0	1.0	5.4	6.3	4.5	2.2	M4-SH-FHL-S-E
M5 x 0.8	0.5 - 3.0	7.0	6.95	14.7	10.0	1.0	7.9	8.8	8.6	3.6	M5-SH-FHL-S-E
M6 x 1.0	0.5 - 3.3	9.0	8.95	16.5	13.0	1.5	12.4	14.4	11.9	5.3	M6-SH-FHL-S-E
M8 x 1.25	0.5 - 3.3	11.0	10.95	19.0	16.0	1.5	32.0	15.0	25.0	8.0	M8-SH-FHL-S-E
M10 x 1.5	0.5 - 3.5	13.0	12.95	21.0	19.0	2.0	45.0	19.7	45.2	9.2	M10-SH-FHL-S-E

Close End

Semi Hex Body, Flat Head - Close Type - Steel

Material : Steel

Finish : Zinc Plated clear trivalent passivated

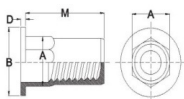

Metric / 6H

Semi Hex Body, Flat Head - Close Type - Steel - European											
Thread Size	Grip Range	Hole Size	Body Dia	Body Length	Head Diameter	Head Height	Recommended Max Torque	Pull-out	Torque-To-Turn	Push-out	Part Number
	(min - max)		A (max)	M (+/- 0.2)	B (+/- 0.3)	D (+/- 0.2)	Nm (max)	kN	Nm (min)	kN	
M4 x 0.7	0.5 - 2.5	6.0	5.95	16.0	9.0	1.0	5.1	6.3	4.5	2.2	M4-SH-FH-CT-S-E
M5 x 0.8	0.5 - 3.0	7.0	6.95	18.0	10.0	1.0	7.9	8.8	8.6	3.6	M5-SH-FH-CT-S-E
M6 x 1.0	0.5 - 3.0	9.0	8.95	21.0	13.0	1.5	12.4	14.4	11.9	5.3	M6-SH-FH-CT-S-E
M8 x 1.25	0.5 - 3.0	11.0	10.95	24.5	16.0	1.5	32.0	15.0	25.0	8.0	M8-SH-FH-CT-S-E
M10 x 1.5	1.0 - 3.5	13.0	12.95	26.5	17.0	2.0	45.0	19.7	45.2	9.2	M10-SH-FH-CT-S-E

BLIND RIVET NUTS

STEEL

Open End

Round Body With Groove, Reduced Head - Steel - American

Material : Steel

Finish : Zinc Plated clear trivalent passivated

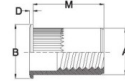

Metric / 6H

Round Body With Groove, Reduced Head - Steel - American											
Thread Size	Grip Range	Hole Size	Body Dia	Body Length	Head Diameter	Head Height	Recommended Max Torque	Pull-out	Torque-To-Turn	Push-out	Part Number
M4 x 0.7	0.5 - 2.0	6.8	6.75	10.7	7.87	0.48	6.2	2.3	1.1	0.8	M4-R-G-RH-S-AM
M5 x 0.8	0.5 - 3.3	7.6	7.55	12.07	8.64	0.48	10.7	2.8	1.4	1.5	M5-R-G-RH-S-AM
M6 x 1.0	0.7 - 4.0	10.0	9.90	14.70	11.50	0.55	18.1	3.0	1.4	1.4	M6-R-G-RH-S-AM
M8 x 1.25	0.7 - 3.8	13.5	13.45	17.55	15.11	0.55	32.0	5.0	2.7	2.3	M8-R-G-RH-S-AM
M10 x 1.5	0.7 - 3.8	13.5	13.45	17.55	15.11	0.55	45.0	5.0	2.7	2.3	M10-R-G-RH-S-AM

Unified / 2B

Round Body With Groove, Reduced Head - Steel - American											
Thread Size	Grip Range	Hole Size	Body Dia	Body Length	Head Diameter	Head Height	Recommended Max Torque	Pull-out	Torque-To-Turn	Push-out	Part Number
UNC 6-32	0.020 - 0.080	0.266	0.265	0.420	0.310	0.019	47	520	10	180	UNC 6-32-R-G-RH-S-AM
UNC 8-32	0.020 - 0.080	0.266	0.265	0.420	0.310	0.019	65	520	10	180	UNC 8-32-R-G-RH-S-AM
UNC 10-24	0.020 - 0.130	0.297	0.296	0.475	0.340	0.019	95	630	12	335	UNC 10-24-R-G-RH-S-AM
UNF 10-32	0.020 - 0.130	0.297	0.296	0.475	0.340	0.019	95	630	12	335	UNF 10-32-R-G-RH-S-AM
UNC 1/4-20	0.027 - 0.165	0.391	0.390	0.580	0.455	0.022	235	685	12	320	UNC 1/4-20-R-G-RH-S-AM
UNC 5/16-18	0.027 - 0.150	0.531	0.530	0.690	0.595	0.022	N/A	1115	24	510	UNC 5/16-18-R-G-RH-S-AM
UNC 3/8-16	0.027 - 0.150	0.531	0.530	0.690	0.595	0.022	N/A	1115	24	510	UNC 3/8-16-R-G-RH-S-AM

Close End

Round Body With Groove, Reduced Head - Close Type - Steel - American

Material : Steel

Finish : Zinc Plated clear trivalent passivated

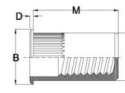

Metric / 6H

Round Body With Groove, Reduced Head - Close Type - Steel - American											
Thread Size	Grip Range	Hole Size	Body Dia	Body Length	Head Diameter	Head Height	Recommended Max Torque	Pull-out	Torque-To-Turn	Push-out	Part Number
M4 x 0.7	0.5 - 2.5	6.4	6.35	15.00	7.30	0.5	6.2	2.3	1.1	0.8	M4-R-G-RH-CT-S-AM
M5 x 0.8	0.5 - 2.5	7.2	7.10	16.00	8.10	0.5	10.7	2.8	1.4	1.5	M5-R-G-RH-CT-S-AM
M6 x 1.0	0.7 - 3.2	9.6	9.50	21.50	10.50	0.5	18.1	3.0	1.4	1.4	M6-R-G-RH-CT-S-AM
M8 x 1.25	0.7 - 3.2	10.6	10.50	22.00	11.50	0.5	32.0	5.0	2.7	2.3	M8-R-G-RH-CT-S-AM
M10 x 1.5	0.7 - 3.2	12.6	12.70	26.50	13.90	0.7	45.0	5.0	2.7	2.3	M10-R-G-RH-CT-S-AM

STEEL

Open End

Round Body With Groove, Flat Head - Steel - American

Material : Steel

Finish : Zinc Plated clear trivalent passivated

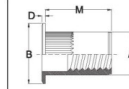

Metric / BH

Round Body With Groove, Flat Head - Steel - American											
Thread Size	Grip Range (min ~ max)	Hole Size A (max)	Body Dia M (+/- 0.2)	Body Length B (+/- 0.3)	Head Diameter D (+/- 0.2)	Head Height D (+/- 0.2)	Recommended Max Torque lbf (max)	Pull-out kN	Torque-To-Turn Nm (min)	Push-out kN	Part Number
M4 x 0.7	0.5 - 2.0	6.8	6.75	10.67	9.90	0.76	6.2	2.3	1.1	0.8	M4-R-G-FH-S-AM
M5 x 0.8	0.5 - 3.3	7.6	7.55	12.07	10.50	0.76	10.7	2.8	1.4	1.5	M5-R-G-FH-S-AM
M6 x 1.0	0.7 - 4.2	10.0	9.90	14.70	12.70	0.76	18.1	3.0	1.4	1.4	M6-R-G-FH-S-AM
M8 x 1.25	0.7 - 3.8	13.5	13.45	17.55	17.40	0.89	32.0	5.0	2.7	2.3	M8-R-G-FH-S-AM
M10 x 1.5	0.7 - 3.8	13.5	13.45	17.50	17.40	0.89	45.0	5.0	2.7	2.3	M10-R-G-FH-S-AM
Round Body With Groove, Flat Head - Long - Steel - American											
M5 x 0.8	3.3 - 5.7	7.6	7.55	15.60	10.50	0.76	10.7	2.8	1.4	1.5	M5-R-G-FH-L-S-AM
M6 x 1.0	4.2 - 6.6	10.0	9.90	18.00	12.70	0.76	18.1	3.0	1.4	1.4	M6-R-G-FH-L-S-AM
M8 x 1.25	3.8 - 7.9	13.5	13.45	20.45	17.40	0.89	32.0	5.0	2.7	2.3	M8-R-G-FH-L-S-AM
M10 x 1.5	3.8 - 7.9	13.5	13.45	21.30	17.40	0.89	45.0	5.0	2.7	2.3	M10-R-G-FH-L-S-AM

Unified / ZB

Round Body With Groove, Flat Head - Steel - American											
Thread Size	Grip Range (min ~ max)	Hole Size A (max)	Body Dia M (+/- 0.2)	Body Length B (+/- 0.3)	Head Diameter D (+/- 0.2)	Head Height D (+/- 0.2)	Recommended Max Torque lbf (max)	Pull-out kN	Torque-To-Turn lbf (min)	Push-out kN	Part Number
UNC 6-32	0.020 - 0.080	0.266	0.265	0.420	0.390	0.030	47	520	10	180	UNC 6-32-R-G-FH-S-AM
UNC 8-32	0.020 - 0.080	0.266	0.265	0.420	0.390	0.030	65	520	10	180	UNC 8-32-R-G-FH-S-AM
UNC 10-24	0.020 - 0.130	0.297	0.296	0.475	0.415	0.030	95	630	12	335	UNC 10-24-R-G-FH-S-AM
UNC 10-32	0.020 - 0.130	0.297	0.296	0.475	0.415	0.030	95	630	12	335	UNC 10-32-R-G-FH-S-AM
UNC 14-20	0.027 - 0.165	0.391	0.390	0.580	0.500	0.030	235	685	12	300	UNC 14-20-R-G-FH-S-AM
UNC 5/16-18	0.027 - 0.150	0.531	0.530	0.690	0.685	0.035	N/A	1115	24	510	UNC 5/16-18-R-G-FH-S-AM
UNC 3/8-16	0.027 - 0.150	0.531	0.530	0.690	0.685	0.035	N/A	1115	24	510	UNC 3/8-16-R-G-FH-S-AM

Open End

Semi Hex Body, Flat Head - Steel - American

Material : Steel

Finish : Zinc Plated clear trivalent passivated

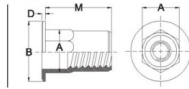

Metric / BH

Semi Hex Body, Flat Head - Steel - American											
Thread Size	Grip Range (min ~ max)	Hole Size A (max)	Body Dia M (+/- 0.2)	Body Length B (+/- 0.3)	Head Diameter D (+/- 0.2)	Head Height D (+/- 0.2)	Recommended Max Torque lbf (max)	Pull-out kN	Torque-To-Turn Nm (min)	Push-out kN	Part Number
M4 x 0.7	0.5 - 2.0	6.35	6.33	10.50	9.50	0.68	6.2	2.3	1.1	0.8	M4-SH-FH-S-AM
M5 x 0.8	0.5 - 3.3	7.14	7.10	11.80	9.90	0.68	10.7	2.8	1.4	1.5	M5-SH-FH-S-AM
M6 x 1.0	0.7 - 4.2	9.53	9.50	14.90	12.95	0.75	18.1	3.0	1.4	1.4	M6-SH-FH-S-AM
M8 x 1.25	0.7 - 3.8	12.7	12.65	17.40	16.64	0.89	32.0	5.0	2.7	2.3	M8-SH-FH-S-AM
M10 x 1.5	0.7 - 3.8	12.7	12.65	17.40	16.64	0.89	45.0	5.0	2.7	2.3	M10-SH-FH-S-AM
M12 x 1.75	1.6 - 5.1	17.6	17.50	29.20	21.90	1.20	N/A	N/A	N/A	N/A	M12-SH-FH-S-AM

Unified / ZB

Semi Hex Body, Flat Head - Steel - American											
Thread Size	Grip Range (min ~ max)	Hole Size A (max)	Body Dia M (+/- 0.2)	Body Length B (+/- 0.3)	Head Diameter D (+/- 0.2)	Head Height D (+/- 0.2)	Recommended Max Torque lbf (max)	Pull-out kN	Torque-To-Turn lbf (min)	Push-out kN	Part Number
UNC 10-24	0.020 - 0.130	0.281	0.280	0.435	0.390	0.027	95	630	12	335	UNC 10-24-SH-FH-S-AM
UNC 10-32	0.020 - 0.130	0.281	0.280	0.435	0.390	0.027	95	630	12	335	UNC 10-32-SH-FH-S-AM
UNC 14-20	0.027 - 0.165	0.375	0.374	0.585	0.510	0.029	235	685	12	320	UNC 14-20-SH-FH-S-AM
UNC 5/16-18	0.027 - 0.150	0.500	0.498	0.685	0.653	0.0345	N/A	1115	24	510	UNC 5/16-18-SH-FH-S-AM
UNC 3/8-16	0.027 - 0.150	0.500	0.498	0.685	0.653	0.0345	N/A	1115	24	510	UNC 3/8-16-SH-FH-S-AM

BLIND RIVET NUTS

STEEL

Open End

Round Body With Groove, Countersunk Head - Steel

Material : Steel

Finish : Zinc Plated clear trivalent passivated

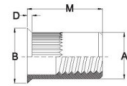

Metric / 6H

Round Body With Groove, Countersunk Head - Steel - European											
Thread Size	Grip Range (min - max)	Hole Size	Body Dia A (max)	Body Length M (+/- 0.2)	Head Diameter B (+/- 0.3)	Head Height D (+/- 0.2)	Recommended Max Torque Nm (max)	Pull-out kN	Torque-To-Turn Nm (min)	Push-out kN	Part Number
M3 x 0.5	0.5 - 2.0	5.0	4.95	11.3	6.6	1.0	1.5	2.7	0.4	0.8	M3-R-G-CSK-S-E
M4 x 0.7	1.0 - 4.0	6.0	5.95	11.5	8.7	1.5	5.1	6.6	1.9	1.5	M4-R-G-CSK-S-E
M5 x 0.8	1.5 - 4.5	7.0	6.95	13.0	9.7	1.5	7.9	8.0	2.6	1.9	M5-R-G-CSK-S-E
M6 x 1.0	1.5 - 4.5	8.0	8.95	16.0	11.5	1.5	12.4	11.4	3.4	2.4	M6-R-G-CSK-S-E
M8 x 1.25	1.5 - 4.5	11.0	10.95	18.5	13.8	1.5	16.4	15.7	3.6	2.8	M8-R-G-CSK-S-E
M10 x 1.5	1.5 - 4.5	13.0	12.90	20.5	15.2	1.5	33.9	18.7	4.2	3.7	M10-R-G-CSK-S-E

Round Body With Groove, Countersunk Head - Long - Steel - European											
Thread Size	Grip Range (min - max)	Hole Size	Body Dia A (max)	Body Length M (+/- 0.2)	Head Diameter B (+/- 0.3)	Head Height D (+/- 0.2)	Recommended Max Torque Nm (max)	Pull-out kN	Torque-To-Turn Nm (min)	Push-out kN	Part Number
M3 x 0.5	3.5 - 5.0	5.0	4.95	12.5	7.5	1.5	1.5	2.7	0.4	0.8	M3-R-G-CSK-L-S-E
M4 x 0.7	4.0 - 6.0	6.0	5.95	15.0	8.5	1.5	5.1	6.6	1.9	1.5	M4-R-G-CSK-L-S-E
M5 x 0.8	4.0 - 6.5	7.0	6.95	16.0	9.5	1.5	7.9	8.0	2.6	1.9	M5-R-G-CSK-L-S-E
M6 x 1.0	4.0 - 6.5	8.0	8.95	18.0	11.5	1.5	12.4	11.4	3.4	2.4	M6-R-G-CSK-L-S-E
M8 x 1.25	4.0 - 6.5	11.0	10.95	21.0	13.5	1.5	16.4	15.7	3.6	2.8	M8-R-G-CSK-L-S-E
M10 x 1.5	4.5 - 7.5	12.0	11.90	24.0	14.5	1.7	33.9	18.7	4.2	3.7	M10-R-G-CSK-L-S-E

Close End

Round Body With Groove, Countersunk Head - Close Type - Steel

Material : Steel

Finish : Zinc Plated clear trivalent passivated

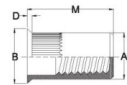

Metric / 6H

Round Body With Groove, Countersunk Head - Close Type - Steel - European											
Thread Size	Grip Range (min - max)	Hole Size	Body Dia A (max)	Body Length M (+/- 0.2)	Head Diameter B (+/- 0.3)	Head Height D (+/- 0.2)	Recommended Max Torque Nm (max)	Pull-out kN	Torque-To-Turn Nm (min)	Push-out kN	Part Number
M3 x 0.5	1.5 - 3.5	5.0	4.95	16.0	7.5	1.5	1.5	2.7	0.4	0.8	M3-R-G-CSK-CT-S-E
M4 x 0.7	1.5 - 4.0	6.0	5.95	17.5	8.5	1.5	5.1	6.6	1.9	1.5	M4-R-G-CSK-CT-S-E
M5 x 0.8	1.5 - 4.0	7.0	6.95	20.0	9.5	1.5	7.9	8.0	2.6	1.9	M5-R-G-CSK-CT-S-E
M6 x 1.0	1.5 - 4.0	8.0	8.95	23.0	11.5	1.5	12.4	11.4	3.4	2.4	M6-R-G-CSK-CT-S-E
M8 x 1.25	1.5 - 4.0	11.0	10.95	27.0	13.5	1.5	16.4	15.7	3.6	2.8	M8-R-G-CSK-CT-S-E
M10 x 1.5	2.0 - 4.5	12.0	11.90	30.0	14.5	1.7	33.9	18.7	4.2	3.7	M10-R-G-CSK-CT-S-E

Open End

Square Body, Flat Head - Steel

Material : Steel

Finish : Zinc Plated clear trivalent passivated

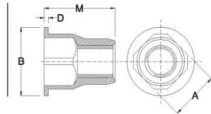

Metric / 6H

Square Body, Flat Head - Steel - European											
Thread Size	Grip Range (min - max)	Hole Size	Body Dia A (max)	Body Length M (+/- 0.2)	Head Diameter B (+/- 0.3)	Head Height D (+/- 0.2)	Recommended Max Torque Nm (max)	Pull-out kN	Torque-To-Turn Nm (min)	Push-out kN	Part Number
M5 x 0.8	0.5 - 2.0	7.30	7.00	10.4	10.5	0.6	7.9	5.5	10.2	2.4	M5-SQ-FH-S-E
M6 x 1.0	0.5 - 2.0	9.30	9.00	14.6	13.0	0.9	12.4	7.3	15.4	4.6	M6-SQ-FH-S-E
M8 x 1.25	1.0 - 3.0	11.30	11.00	17.3	17.6	1.6	32.0	10.5	34.0	6.5	M8-SQ-FH-S-E

STEEL

Split Nuts

Round Body, Flat Head - Steel - Split Nut

Material : Steel

Finish : Zinc Plated clear trivalent passivated

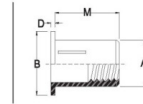

The Split Nut insert is a wide grip range threaded insert, which provides an extra large blind side bearing area when placed.

Split Nut specifically designed for use in soft materials, plastics and composites. With up to twice the grip range of standard blind inserts the Split rivet nut enables a reduction in the number of fasteners in an assembly.

The steel Split Nut from looks like an elongated flat head rivet nut, and it sets like a rivet nut with spin-pull tooling, but the difference lies in the method of setting. The Splits into 4 as it sets, leaving a wide clamp up tail formation and an insert thread.

Ideal for use in soft materials, composites, composites and high density plastics, it combines a wide grip range with impressive maximum torque to bolt results. The Split Nut series is offered in M5, M6, and M8 and in two grip lengths.



Round Body, Flat Head - Steel - Split Nut								Metric / GH
Thread Size	Grip Range	Hole Size	Body Dia	Body Length	Head Diameter	Head Height	Part Number	
	(min - max)	(+0.12/-0.00)	A (max)	M (+/-0.38)	B (min - max)	D (+/- 0.13)		
M4 x 0.7	0.50 - 3.80	6.13	6.12	16.92	10.84 - 11.34	0.90	M4-R-FH-S-SN	
M5 x 0.8	0.50 - 4.45	7.48	7.47	21.03	12.45 - 12.95	0.96	M5-R-FH-S-SN	
M6 x 1.0	0.50 - 7.10	8.80	8.79	25.40	15.50 - 16.38	1.50	M6-R-FH-S-SN	
M8 x 1.25	0.50 - 7.10	11.11	11.10	28.95	18.80 - 19.56	1.57	M8-R-FH-S-SN	

Round Body, Flat Head - Long - Steel - Split Nut								Metric / GH
Thread Size	Grip Range	Hole Size	Body Dia	Body Length	Head Diameter	Head Height	Part Number	
	(min - max)	(+0.12/-0.00)	A (max)	M (+/-0.38)	B (min - max)	D (+/- 0.13)		
M4 x 0.7	3.80 - 6.85	6.13	6.12	20.07	10.84 - 11.34	0.90	M4-R-FH-L-S-SN	
M5 x 0.8	4.45 - 8.10	7.48	7.47	23.80	12.45 - 12.95	0.96	M5-R-FH-L-S-SN	
M6 x 1.0	7.10 - 12.70	8.80	8.79	31.32	15.50 - 16.38	1.50	M6-R-FH-L-S-SN	
M8 x 1.25	7.10 - 12.70	11.11	11.10	34.90	18.80 - 19.56	1.57	M8-R-FH-L-S-SN	

BLIND RIVET NUTS

STAINLESS STEEL

Open End

Round Body With Groove, Reduced Head - Stainless Steel

Material : Stainless Steel

Finish : Natural

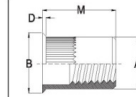

Metric / 6H

Round Body With Groove, Reduced Head - Stainless Steel											
Thread Size	Grip Range	Hole Size	Body Dia	Body Length	Head Diameter	Head Height	Recommended Max Torque	Pull-out	Torque-To-Turn	Push-out	Part Number
M3 x 0.5	0.5 - 1.5	4.8	4.7	9.0	5.5	0.5	4.0	8.2	0.4	1.0	M3-R-G-RH-ST-A
M4 x 0.7	0.5 - 2.5	6.4	6.3	10.5	7.0	0.5	5.6	9.2	1.9	2.0	M4-R-G-RH-ST-A
M5 x 0.8	0.5 - 3.0	7.2	7.1	12.0	8.0	0.5	11.3	12.0	2.6	2.7	M5-R-G-RH-ST-A
M6 x 1.0	0.5 - 3.0	9.6	9.5	14.5	10.5	0.5	16.9	18.3	3.4	2.9	M6-R-G-RH-ST-A
M8 x 1.25	0.5 - 3.0	10.6	10.5	16.0	11.5	0.5	22.6	24.2	3.6	3.2	M8-R-G-RH-ST-A
M10 x 1.5	1.0 - 3.5	14.3	14.28	18.5	15.8	0.7	33.8	33.9	4.2	4.2	M10-R-G-RH-ST-A
Round Body With Groove, Reduced Head - Stainless Steel - European											
M3 x 0.5	0.5 - 2.0	5.0	4.95	9.0	6.0	0.5	4.0	8.2	0.4	1.0	M3-R-G-RH-ST-E
M4 x 0.7	0.5 - 2.5	6.0	5.95	11.0	7.0	0.5	5.6	9.2	1.9	2.0	M4-R-G-RH-ST-E
M5 x 0.8	0.5 - 3.0	7.0	6.95	12.0	8.0	0.5	11.3	12.0	2.6	2.7	M5-R-G-RH-ST-E
M6 x 1.0	0.5 - 3.0	9.0	8.95	14.0	10.0	0.5	16.9	18.3	3.4	2.9	M6-R-G-RH-ST-E
M8 x 1.25	0.5 - 3.0	11.0	10.95	16.0	12.0	0.5	22.6	24.2	3.6	3.2	M8-R-G-RH-ST-E
M10 x 1.5	1.0 - 3.5	13.0	12.95	19.0	14.3	0.7	33.8	33.9	4.2	4.2	M10-R-G-RH-ST-E
Round Body With Groove, Reduced Head - Long - Stainless Steel - European											
M4 x 0.7	2.5 - 4.0	6.0	5.90	12.5	7.0	0.5	5.6	9.2	1.9	2.0	M4-R-G-RH-L-ST-E
M5 x 0.8	3.0 - 4.5	7.0	6.90	13.5	8.0	0.5	11.3	12.0	2.6	2.7	M5-R-G-RH-L-ST-E
M6 x 1.0	3.0 - 5.0	9.0	8.90	16.0	10.0	0.5	16.9	18.3	3.4	2.9	M6-R-G-RH-L-ST-E
M8 x 1.25	3.0 - 5.5	11.0	10.90	18.5	12.0	0.5	22.6	24.2	3.6	3.2	M8-R-G-RH-L-ST-E
M10 x 1.5	3.5 - 6.0	13.0	12.90	21.5	14.3	0.7	33.8	33.9	4.2	4.2	M10-R-G-RH-L-ST-E

Close End

Round Body With Groove, Reduced Head - Close Type - Stainless Steel

Material : Stainless Steel

Finish : Natural

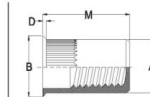

Metric / 6H

Round Body With Groove, Reduced Head - Close Type - Stainless Steel - European											
Thread Size	Grip Range	Hole Size	Body Dia	Body Length	Head Diameter	Head Height	Recommended Max Torque	Pull-out	Torque-To-Turn	Push-out	Part Number
M4 x 0.7	0.5 - 2.5	6.0	5.90	16.0	7.0	0.5	5.6	9.2	1.9	2.0	M4-R-G-RH-CT-ST-E
M5 x 0.8	0.5 - 3.0	7.0	6.90	16.0	8.0	0.5	11.3	12.0	2.6	2.7	M5-R-G-RH-CT-ST-E
M6 x 1.0	0.5 - 3.0	9.0	8.90	21.0	10.0	0.5	16.9	18.3	3.4	2.9	M6-R-G-RH-CT-ST-E
M8 x 1.25	0.5 - 3.0	11.0	10.90	23.5	12.0	0.5	22.6	24.2	3.6	3.2	M8-R-G-RH-CT-ST-E
M10 x 1.5	1.0 - 3.5	13.0	12.90	26.5	14.3	0.7	33.8	33.9	4.2	4.2	M10-R-G-RH-CT-ST-E

STAINLESS STEEL

Open End

Round Body With Groove, Flat Head - Stainless Steel
Material : Stainless Steel
Finish : Natural

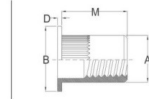

Metric / 6H

Round Body With Groove, Flat Head - Stainless Steel - European											
Thread Size	Grip Range (min ~ max)	Hole Size	Body Dia A (max)	Body Length M (+/- 0.2)	Head Diameter B (+/- 0.3)	Head Height D (+/- 0.2)	Recommended Max Torque Nm (max)	Pull-out kN	Torque- To-Turn Nm (min)	Push-out kN	Part Number
M3 x 0.5	0.5 - 2.0	5.0	4.95	9.0	6.0	0.8	4.0	8.2	0.4	2.0	M3-R-G-FH-ST-E
M4 x 0.7	0.5 - 2.5	6.0	5.95	11.0	9.0	1.0	5.6	9.2	1.9	3.0	M4-R-G-FH-ST-E
M5 x 0.8	0.5 - 3.0	7.0	6.95	12.0	10.0	1.0	11.3	12.0	2.6	4.7	M5-R-G-FH-ST-E
M6 x 1.0	0.5 - 3.0	9.0	8.95	14.0	12.0	1.5	16.9	18.3	3.4	5.3	M6-R-G-FH-ST-E
M8 x 1.25	0.5 - 3.0	11.0	10.95	16.0	15.0	1.5	22.6	24.2	3.6	7.2	M8-R-G-FH-ST-E
M10 x 1.5	1.0 - 3.5	13.0	12.95	19.0	17.0	2.0	33.8	33.9	4.2	8.7	M10-R-G-FH-ST-E

Round Body With Groove, Flat Head - Long - Stainless Steel - European											
Thread Size	Grip Range (min ~ max)	Hole Size	Body Dia A (max)	Body Length M (+/- 0.2)	Head Diameter B (+/- 0.3)	Head Height D (+/- 0.2)	Recommended Max Torque Nm (max)	Pull-out kN	Torque- To-Turn Nm (min)	Push-out kN	Part Number
M4 x 0.7	2.5 - 4.0	6.0	5.95	12.5	9.0	1.0	5.6	9.2	1.9	3.0	M4-R-G-FH-L-ST-E
M5 x 0.8	3.0 - 4.5	7.0	6.95	13.5	10.0	1.0	11.3	12.0	2.6	4.7	M5-R-G-FH-L-ST-E
M6 x 1.0	3.0 - 5.0	9.0	8.95	16.0	12.0	1.5	16.9	18.3	3.4	5.3	M6-R-G-FH-L-ST-E
M8 x 1.25	3.0 - 5.5	11.0	10.95	18.5	15.0	1.5	22.6	24.2	3.6	7.2	M8-R-G-FH-L-ST-E
M10 x 1.5	3.5 - 6.0	13.0	12.95	21.5	17.0	2.0	33.8	33.9	4.2	8.7	M10-R-G-FH-L-ST-E

Close End

Round Body With Groove, Flat Head - Close Type - Stainless Steel
Material : Stainless Steel
Finish : Natural

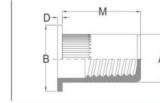

Metric / 6H

Round Body With Groove, Flat Head - Close Type - Stainless Steel - European											
Thread Size	Grip Range (min ~ max)	Hole Size	Body Dia A (max)	Body Length M (+/- 0.2)	Head Diameter B (+/- 0.3)	Head Height D (+/- 0.2)	Recommended Max Torque Nm (max)	Pull-out kN	Torque- To-Turn Nm (min)	Push-out kN	Part Number
M4 x 0.7	0.5 - 2.5	6.0	5.90	16.0	9.0	1.0	5.6	9.2	1.9	3.0	M4-R-G-FH-CT-ST-E
M5 x 0.8	0.5 - 3.0	7.0	6.90	18.0	10.0	1.0	11.3	12.0	2.6	4.7	M5-R-G-FH-CT-ST-E
M6 x 1.0	0.5 - 3.0	9.0	8.90	21.0	12.0	1.5	16.9	18.3	3.4	5.3	M6-R-G-FH-CT-ST-E
M8 x 1.25	0.5 - 3.0	11.0	10.90	23.5	15.0	1.5	22.6	24.2	3.6	7.2	M8-R-G-FH-CT-ST-E
M10 x 1.5	1.0 - 3.5	13.0	12.90	26.5	17.0	2.0	33.8	33.9	4.2	8.7	M10-R-G-FH-CT-ST-E

Open End

Round Body With Groove, Countersunk Head - Stainless Steel
Material : Stainless Steel
Finish : Natural

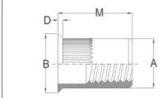

Metric / 6H

Round Body With Groove, Countersunk Head - Stainless Steel - European											
Thread Size	Grip Range (min ~ max)	Hole Size	Body Dia A (max)	Body Length M (+/- 0.2)	Head Diameter B (+/- 0.3)	Head Height D (+/- 0.2)	Recommended Max Torque Nm (max)	Pull-out kN	Torque- To-Turn Nm (min)	Push-out kN	Part Number
M3 x 0.5	0.5 - 2.0	5.0	4.95	11.3	6.6	1.0	4.0	8.2	0.4	1.0	M3-R-G-CSK-ST-E
M4 x 0.7	1.5 - 4.0	6.0	5.90	12.0	9.0	1.5	5.6	9.2	1.9	2.0	M4-R-G-CSK-ST-E
M5 x 0.8	1.5 - 4.5	7.0	6.90	13.5	10.0	1.5	11.3	12.0	2.6	2.7	M5-R-G-CSK-ST-E
M6 x 1.0	1.5 - 4.5	9.0	8.90	16.0	12.0	1.5	16.9	18.3	3.4	2.9	M6-R-G-CSK-ST-E
M8 x 1.25	1.5 - 4.5	11.0	10.90	18.0	14.0	1.5	22.6	24.2	3.6	3.2	M8-R-G-CSK-ST-E
M10 x 1.5	1.5 - 4.5	13.0	12.90	20.5	15.2	1.5	33.8	33.9	4.2	4.2	M10-R-G-CSK-ST-E

BLIND RIVET NUTS

STAINLESS STEEL

Open End

Semi Hex Body, Reduced Head - Stainless Steel

Material : Stainless Steel

Finish : Natural

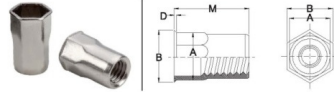

Metric / 6H

Semi Hex Body, Reduced Head - Stainless Steel - European												
Thread Size	Grip Range (min - max)	Hole Size	Body Dia		Head Diameter		Head Height D (+/- 0.2)	Recommended Max Torque Nm (max)	Pull-out kN	Torque- To-Turn Nm (min)	Push-out kN	Part Number
			A (max)	M (+/- 0.2)	B (+/- 0.3)	D (+/- 0.2)						
M4 x 0.7	0.5 - 2.5	6.0	5.95	11.0	7.0	0.5	5.1	6.3	4.2	1.4		M4-SH-RH-ST-E
M5 x 0.8	0.5 - 3.0	7.0	6.95	12.0	8.0	0.5	7.9	8.8	7.5	2.6		M5-SH-RH-ST-E
M6 x 1.0	0.5 - 3.0	9.0	8.95	14.0	10.0	0.5	12.4	14.4	10.7	3.2		M6-SH-RH-ST-E
M8 x 1.25	0.5 - 3.5	11.0	10.95	16.0	12.0	0.5	32.0	15.0	22.7	4.1		M8-SH-RH-ST-E
M10 x 1.5	0.7 - 3.8	13.0	12.95	19.0	14.2	0.8	45.0	19.7	38.5	5.2		M10-SH-RH-ST-E
Semi Hex Body, Reduced Head - Long - Stainless Steel - European												
M4 x 0.7	2.5 - 4.0	6.0	5.95	12.8	7.0	0.5	5.1	6.3	4.2	1.4		M4-SH-RH-L-ST-E
M5 x 0.8	2.5 - 4.5	7.0	6.95	15.2	8.0	0.5	7.9	8.8	7.5	2.6		M5-SH-RH-L-ST-E
M6 x 1.0	3.0 - 5.0	8.0	8.95	17.2	10.0	0.5	12.4	14.4	10.7	3.2		M6-SH-RH-L-ST-E
M8 x 1.25	3.0 - 5.5	11.0	10.95	18.7	12.0	0.5	32.0	15.0	22.7	4.1		M8-SH-RH-L-ST-E
M10 x 1.5	3.5 - 6.0	13.0	12.95	21.5	14.0	0.6	45.0	19.7	38.5	5.2		M10-SH-RH-L-ST-E

Close End

Semi Hex Body, Reduced Head - Close Type - Stainless Steel

Material : Stainless Steel

Finish : Natural

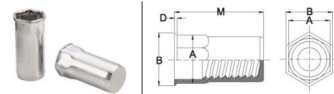

Metric / 6H

Semi Hex Body, Reduced Head - Close Type - Stainless Steel - European												
Thread Size	Grip Range (min - max)	Hole Size	Body Dia		Head Diameter		Head Height D (+/- 0.2)	Recommended Max Torque Nm (max)	Pull-out kN	Torque- To-Turn Nm (min)	Push-out kN	Part Number
			A (max)	M (+/- 0.2)	B (+/- 0.3)	D (+/- 0.2)						
M4 x 0.7	0.5 - 2.5	6.0	5.95	16.0	7.0	0.5	5.1	6.3	4.2	1.4		M4-SH-RH-CT-ST-E
M5 x 0.8	0.5 - 3.0	7.0	6.95	18.0	8.0	0.5	7.9	8.8	7.5	2.6		M5-SH-RH-CT-ST-E
M6 x 1.0	0.5 - 3.0	9.0	8.95	21.0	10.0	0.5	12.4	14.4	10.7	3.2		M6-SH-RH-CT-ST-E
M8 x 1.25	0.5 - 3.0	11.0	10.95	23.5	12.0	0.5	32.0	15.0	22.7	4.1		M8-SH-RH-CT-ST-E
M10 x 1.5	1.0 - 3.5	13.0	12.95	26.5	14.0	0.7	45.0	19.7	38.5	5.2		M10-SH-RH-CT-ST-E

STAINLESS STEEL

Open End

Semi Hex Body, Flat Head - Stainless Steel
 Material : Stainless Steel
 Finish : Natural

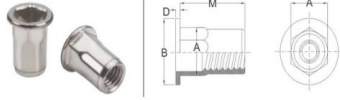

Metric / GH

Semi Hex Body, Flat Head - Stainless Steel - European											
Thread Size	Grip Range (min - max)	Hole Size	Body Dia	Body Length	Head Diameter	Head Height	Recommended Max Torque Nm (max)	Pull-out kN	Torque-To-Turn Nm (min)	Push-out kN	Part Number
			A (max)	M (+/- 0.2)	B (+/- 0.3)	D (+/- 0.2)					
M4 x 0.7	0.5 - 2.5	6.0	5.95	11.0	9.0	1.0	5.1	6.3	4.5	2.2	M4-SH-FH-ST-E
M5 x 0.8	0.5 - 3.0	7.0	6.95	12.0	10.0	1.0	7.9	8.8	8.6	3.6	M5-SH-FH-ST-E
M6 x 1.0	0.5 - 3.0	9.0	8.95	14.0	12.0	1.5	12.4	14.4	11.9	5.3	M6-SH-FH-ST-E
M8 x 1.25	0.5 - 3.0	11.0	10.95	16.0	15.0	1.5	32.0	15.0	25.0	8.0	M8-SH-FH-ST-E
M10 x 1.5	0.5 - 4.0	13.0	12.95	20.0	18.0	2.0	45.0	19.7	45.2	9.2	M10-SH-FH-ST-E

Close End

Semi Hex Body, Flat Head - Close Type - Stainless Steel
 Material : Stainless Steel
 Finish : Natural

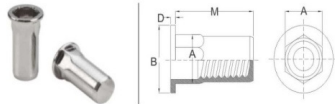

Metric / GH

Semi Hex Body, Flat Head - Close Type - Stainless Steel - European											
Thread Size	Grip Range (min - max)	Hole Size	Body Dia	Body Length	Head Diameter	Head Height	Recommended Max Torque Nm (max)	Pull-out kN	Torque-To-Turn Nm (min)	Push-out kN	Part Number
			A (max)	M (+/- 0.2)	B (+/- 0.3)	D (+/- 0.2)					
M4 x 0.7	0.5 - 2.5	6.0	5.95	16.0	9.0	1.0	5.1	6.3	4.5	2.2	M4-SH-FH-CT-ST-E
M5 x 0.8	0.5 - 3.0	7.0	6.95	18.0	10.0	1.0	7.9	8.8	8.6	3.6	M5-SH-FH-CT-ST-E
M6 x 1.0	0.5 - 3.0	9.0	8.95	21.0	12.0	1.5	12.4	14.4	11.9	5.3	M6-SH-FH-CT-ST-E
M8 x 1.25	0.5 - 3.0	11.0	10.95	23.5	15.0	1.5	32.0	15.0	25.0	8.0	M8-SH-FH-CT-ST-E
M10 x 1.5	1.0 - 3.5	13.0	12.95	26.5	17.0	2.0	45.0	19.7	45.2	9.2	M10-SH-FH-CT-ST-E

BLIND RIVET NUTS

STAINLESS STEEL

Open End

Round Body With Groove, Reduced Head - Stainless Steel - American
 Material : Stainless Steel
 Finish : Natural

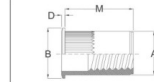

Round Body With Groove, Reduced Head - Stainless Steel - American											Metric / GH	
Thread Size	Grip Range	Hole Size	Body Dia	Body Length	Head Diameter	Head Height	Recommended Max Torque	Pull-out	Torque-To-Turn	Push-out	Part Number	
	(min - max)		A (max)	M (+/- 0.2)	B (+/- 0.3)	D (+/- 0.2)	Nm (max)	kN	Nm (min)	kN		
M4 x 0.7	0.5 - 2.0	6.75	6.70	10.7	7.8	0.6	5.6	9.2	1.9	2.0	M4-R-G-RH-ST-AM	
M5 x 0.8	0.5 - 3.3	7.60	7.50	12.1	8.6	0.6	11.3	12.0	2.6	2.7	M5-R-G-RH-ST-AM	
M6 x 1.0	0.7 - 4.2	10.00	9.90	14.7	11.5	0.6	16.9	18.3	3.4	2.9	M6-R-G-RH-ST-AM	
M8 x 1.25	0.7 - 3.8	13.50	13.45	17.5	15.1	0.8	22.6	24.2	3.6	3.2	M8-R-G-RH-ST-AM	
M10 x 1.5	0.7 - 3.8	13.50	13.45	17.5	15.1	0.8	33.8	33.9	4.2	4.2	M10-R-G-RH-ST-AM	

Round Body With Groove, Reduced Head - Stainless Steel - American											Unified / ZB	
Thread Size	Grip Range	Hole Size	Body Dia	Body Length	Head Diameter	Head Height	Recommended Max Torque	Pull-out	Torque-To-Turn	Push-out	Part Number	
	(min - max)		A (max)	M (+/- 0.015)	B (+/- 0.012)	D (+/- 0.008)	lbf (max)	lbf	lbf (min)	lbf		
UNC 8-32	0.020 - 0.080	0.266	0.265	0.421	0.311	0.024	4.13	6785	1.40	1475	UNC 8-32-R-G-RH-ST-AM	
UNC 10-24	0.020 - 0.130	0.297	0.296	0.475	0.340	0.024	8.33	8850	1.90	1991	UNC 10-24-R-G-RH-ST-AM	
UNC 10-32	0.020 - 0.130	0.297	0.296	0.475	0.340	0.024	8.33	8850	1.90	1991	UNC 10-32-R-G-RH-ST-AM	
UNC 1/4-20	0.027 - 0.165	0.391	0.390	0.580	0.455	0.024	12.46	13497	2.50	2138	UNC 1/4-20-R-G-RH-ST-AM	
UNC 5/16-18	0.027 - 0.150	0.531	0.530	0.690	0.595	0.032	16.66	17849	2.65	2360	UNC 5/16-18-R-G-RH-ST-AM	
UNC 3/8-16	0.027 - 0.150	0.5312	0.530	0.690	0.595	0.032	24.62	25003	3.10	3097	UNC 3/8-16-R-G-RH-ST-AM	

Open End

Round Body With Groove, Flat Head - Stainless Steel - American
 Material : Stainless Steel
 Finish : Natural

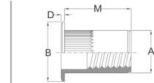

Round Body With Groove, Flat Head - Stainless Steel - American											Metric / GH	
Thread Size	Grip Range	Hole Size	Body Dia	Body Length	Head Diameter	Head Height	Recommended Max Torque	Pull-out	Torque-To-Turn	Push-out	Part Number	
	(min - max)		A (max)	M (+/- 0.2)	B (+/- 0.3)	D (+/- 0.2)	Nm (max)	kN	Nm (min)	kN		
M4 x 0.7	0.5 - 2.0	6.75	6.70	10.7	9.9	0.8	5.6	9.2	1.9	2.0	M4-R-G-FH-ST-AM	
M5 x 0.8	0.5 - 3.3	7.60	7.50	12.1	10.5	0.8	11.3	12.0	2.6	2.7	M5-R-G-FH-ST-AM	
M6 x 1.0	0.7 - 4.2	10.00	9.90	14.7	12.7	1.0	16.9	18.3	3.4	2.9	M6-R-G-FH-ST-AM	
M8 x 1.25	0.7 - 3.8	13.50	13.45	17.5	17.4	1.0	22.6	24.2	3.6	3.2	M8-R-G-FH-ST-AM	
M10 x 1.5	0.7 - 3.8	13.50	13.45	17.5	17.4	1.0	33.8	33.9	4.2	4.2	M10-R-G-FH-ST-AM	

Round Body With Groove, Flat Head - Stainless Steel - American											Unified / ZB	
Thread Size	Grip Range	Hole Size	Body Dia	Body Length	Head Diameter	Head Height	Recommended Max Torque	Pull-out	Torque-To-Turn	Push-out	Part Number	
	(min - max)		A (max)	M (+/- 0.015)	B (+/- 0.012)	D (+/- 0.008)	lbf (max)	lbf	lbf (min)	lbf		
UNC 8-32	0.020 - 0.080	0.266	0.265	0.421	0.390	0.030	4.13	6785	1.40	1475	UNC 8-32-R-G-FH-ST-AM	
UNC 10-24	0.020 - 0.130	0.297	0.296	0.475	0.415	0.032	8.33	8850	1.90	1991	UNC 10-24-R-G-FH-ST-AM	
UNC 10-32	0.020 - 0.130	0.297	0.296	0.475	0.415	0.032	8.33	8850	1.90	1991	UNC 10-32-R-G-FH-ST-AM	
UNC 1/4-20	0.027 - 0.165	0.391	0.390	0.580	0.500	0.040	12.46	13497	2.50	2138	UNC 1/4-20-R-G-FH-ST-AM	
UNC 5/16-18	0.027 - 0.150	0.531	0.530	0.690	0.685	0.040	16.66	17849	2.65	2360	UNC 5/16-18-R-G-FH-ST-AM	
UNC 3/8-16	0.027 - 0.150	0.5312	0.530	0.690	0.685	0.040	24.92	25003	3.10	3097	UNC 3/8-16-R-G-FH-ST-AM	

Manual Heavy Duty Blind Rivet Nut Tool



H-2

Type:- Lever Type (Foldable)
Head:- Static
Capacity:- M4-M10



HF-102

Type:- Lever Type
Head:- Static
Capacity:- M4-M10

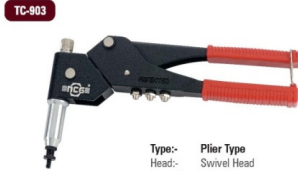

TC-903

Type:- Plier Type
Head:- Swivel Head
Capacity:- M3-M6



H9-3

Type:- Lever Type
Head:- Swivel Head
Capacity:- M4-M10

HN-02 Superior Blind Rivet Nut Tool



SRC HN-02, hand nut tool comes with a nosepiece kit including M4, M5, M6, M8 and M10 in order to fulfill customer demands in different threads. Nosepiece kit can be purchased as parts separately and its comes with a plastic box with nosepiece holder.

Pull the round knob grip to its maximum. This rotates the screw mandrel in the counter-clockwise and the rivet nut will not be threaded only the mandrel.

Rivet nut is threaded on to screw mandrel of the tool for installation by simply pushing the round knob.

Rivet nut on the tool mandrel is then inserted into the pre drilled hole in the material to installation. Just grip the two arms fully so that it touches the brackets. By doing so the screw mandrel rotates and the threaded position is pulled, forming a bulge in the unthreaded shank area of the rivet nut on the blind side.

And pull back the round knob grip, the screw mandrel will rotate in the counterclockwise, unthreading itself from set rivet nut.



Highlights

- ✓ Suitable for all material includes aluminum, steel and stainless steel rivet nuts up to size M10.
- ✓ Simple stroke adjustment by means of an adjuster ring with memory stroke scale or easy use in different sizes and grips.
- ✓ Push / Pull mechanism allows you for quick setting of rivet nut in clockwise and counter-clockwise motion for threading and unthreading.
- ✓ Easy maintenance access in order to maintain full capability for daily use. Oil and daily c leaning is required for the best performance and is recommended.
- ✓ All parts can be purchased separately by request and are quality guaranteed.

Item No.	Description	Weight	Length	Stroke	Specification
HN-02	Professional Hand Nut Tool	1.8 Kgs.	440mm	0-8mm	Blind Nuts M4, M5, M6, M8 & M10 for all materials

BLIND RIVET NUT TOOL

Pneumatic Blind Rivet Nut Tool (Spin Spin Technology)



LG-801



LG-802



LG-803

Riveter No.	Speed (rpm)	Capacity (mm)	Pressure Required	Weight (Kg)	Height (mm)	Length (mm)
LG-801	3000	M3, M4	0.39 - 0.49 Mpa (4-5 Kg/cm ²)	1.32	160	200
LG-802	1500	M5, M6	0.49 - 0.59 Mpa (5-6 Kg/cm ²)	1.32	160	200
LG-803	600	M8, M10	0.59 - 0.69 Mpa (5-7 Kg/cm ²)	1.36	160	220

Pneumatic Blind Rivet Nut Tool (Spin Pull Spin Technology)



SN-06

Item No.	Description	Weight	Air Pressure	Nut Setting Capacity	Specification
SN-06	Superior Air Blind Rivet Nut Tool	1.85 Kgs.	70-95 psi 5-7 kgf	M4-M6, UNC 8-32, UNC 10-24, UNC 1/4-20, Aluminum, Steel & Stainless Steel Blind Nuts	<ol style="list-style-type: none"> 1. Light Weight and heavy duty pneumatic nut tool. 2. Thread nut insert automatically and touch a button to un-thread. 3. Save at least 50% of time & Energy.

Hydro Pneumatic Heavy Duty Blind Rivet Nut Tool (Spin Pull Spin Technology)

SN-10

Type : Hydro Pneumatic Blind Rivet Nut Tool
Weight : 2.45kgs.
Stroke Length : 9mm
Pressure Required : 70 to 95 PSI
 5 to 7kgs.
Capacity : M4 to M12 in all material
Traction Power : 29800 N
 6670 LBF
 3026 Kgf
Specification : Light Weight & heavy duty pneumatic Rivet Nut tool.
 Thread & Unthread insert automatically & external touch a button to unthread.
 Low Consumption of Air.
 Worked on All materials Steel & Stainless Steel Blind Nuts.
 Save at least 50% of time & Energy.



ZP-183

Type : Hydro Pneumatic Blind Rivet Nut Tool
Weight : 2.9kgs.
Stroke Length : 7mm
Pressure Required : 80 to 100 PSI
 6 to 7kgs.
Capacity : M4 to M12 in all material
Traction Power : 30248 N
 6800 LBF
 3100 Kgf
Specification : One touch reversing operation.
 Reliable, Durable & heavy duty tool.
 Noise free operation.
 Simple & easy operation for work.



AN-200A

Type : Hydro Pneumatic Blind Rivet Nut Tool
Weight : 2.6kgs.
Stroke Length : Adjustable Stroke length upto 10mm
Pressure Required : 85 to 100 PSI
 6 to 7kgs.
Capacity : M3 to M10 in all material
Traction Power : 31138 N
 7000 LBF
 3175 Kgf
Specification : Heavy duty Hydro Pneumatic Rivet Nut Tool.
 Thread & Unthread Automatic on single lever Operation.
 One touch reversing operation Lever.
 Very simple & easy to operate.
 Reduce 50% of time & energy.



OUR OTHER RANGE OF PRODUCTS



BLIND RIVETS



SELF CLINCHING FASTENERS



SELF DRILLING SCREWS



RIVETING TOOLS



STATE ENTERPRISES

Plot No- 43, Street No.-1,
Samaypur Industrial Area, Delhi - 110042 (India).
Tel.: 91-11- 27837013 | Fax.: 91-11- 27835438
Email id : sales@rivetsindia.com