



Contour[®] plus

Blood Glucose Monitoring System



Uses only Bayer's CONTOUR[®]PLUS blood glucose test strips

USER GUIDE

Getting the Blood Drop - Fingertip Testing

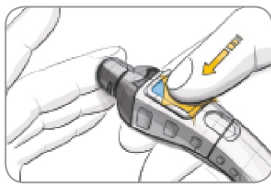

1. Press the endcap firmly against the fingertip and press the blue release button with your thumb.

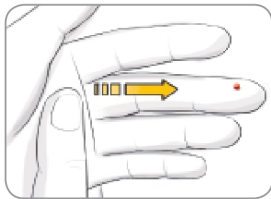

2. Stroke your hand and finger toward the puncture site to form a drop of blood. Do not squeeze around the puncture site.

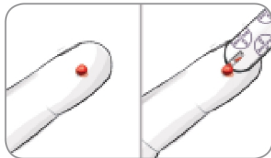

Suggested drop size

3. Test immediately after a good blood drop has formed.



Fingertip Testing

4. Immediately touch the **tip** of the test strip to the drop of blood. The blood is pulled into the test strip through the tip.

Hold the tip of the test strip in the blood drop until the meter beeps.

Do not press the tip against the skin or place the blood on top of the test strip or you could get inaccurate results or errors.



If the first blood drop is not enough, the meter may beep twice and display a strip underfill screen image.



You have about 30 seconds to apply more blood onto the same strip. If you are not able to apply enough blood within that time, an E2 error code will be displayed. Dispose of the used test strip as medical waste and start over with a new strip.

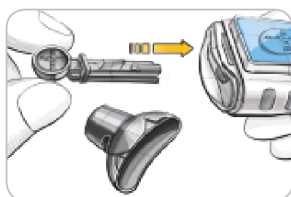

3. Insert the lancet firmly into the lancing device until it comes to a full stop. This will re-set the device. You can also pull and release the re-setting handle.



4. Twist off the round protective lancet cap. Save it for disposing of the used lancet.

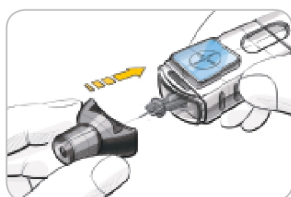

5. Replace the grey endcap.



6. The puncture depth depends on the endcap setting and the amount of pressure applied to the puncture site. Rotate the endcap dial to adjust the puncture depth.

8

Inserting the Test Strip

1. Remove a CONTOUR®PLUS test strip from the bottle. **Tightly close the bottle lid immediately after you have removed the test strip.**



2. Hold the test strip with the grey square end facing up toward the meter.



3. Insert the grey square end firmly into the test strip port until the meter beeps.

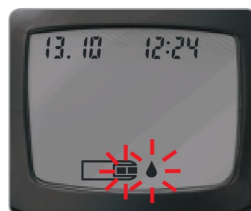

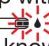
This will turn the meter on. An image of a test strip with a flashing blood drop  will appear letting you know the meter is ready to test.

HINT: After the test strip is inserted, if you do not apply blood to the test strip within 3 minutes, the meter will turn off. Remove the test strip and reinsert it to begin a test.

9

Your Meter Display

The picture below shows all the symbols that appear on your meter display. To view, with the meter off, press and hold ▲ or ▼. All display segments will appear for 10 seconds. If you need more than 10 seconds to check the display, press and hold ▲ or ▼ again.



While all characters are displayed, it is very important to verify that 8.8.8 is fully displayed. If there are missing segments, see Error Codes and Symbols (pages 42 - 45). This may affect the way you see your results.



Icon	What it Means
08/08	Top area on the display presenting date and time.
🍏	Pre-meal result marker.
🍴	Post-meal result marker.
📖	Identifies a Diary entry.
🕒	Indicates a reminder has been set.
888	Center area on the display that shows either your test result or any error codes.
🔋	The meter is ready to test.
✓	Control solution result marker.
🌡️	Indicates it is too cold or too hot for your meter to test accurately.
A	Indicates Average.
mmol/L 7dL	Results are displayed as mmol/L or mg/dL. The 7 appears when viewing 7 day HI-LO summary.
d.m/d	Day/month format.
🔋	The batteries are low and need to be changed, and will remain on display until batteries are changed.
AM PM	Appear if the meter is in 12 hour setup.
🔊	Indicates sound is turned on.

Your CONTOUR®PLUS Meter

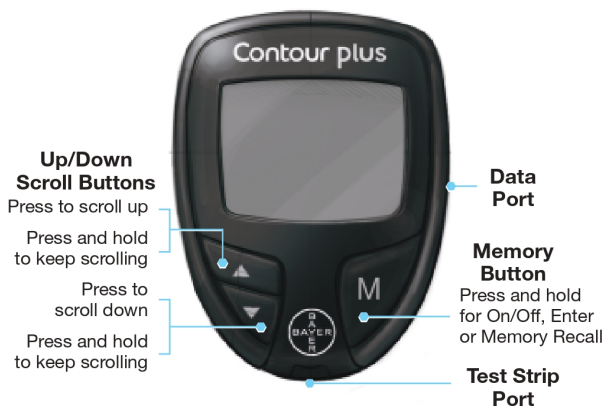

Using the Meter Buttons

- Press and hold the **M** button **until the meter turns on.**
- Press and hold the **M** button **until the meter turns off.**
- The **▲** or **▼** scroll buttons on the meter allow you to scroll. You can hold the **▲** or **▼** button to scroll continuously through a list.
- Press the **M** button to select the option that appears.
- To access Setup, with the meter off, press and hold **M** for 3 seconds. See page 24.

2



84721973_CntrPLUS_UG_EN_FpBp_v2.indd 2-3

Your CONTOUR®PLUS Test Strip

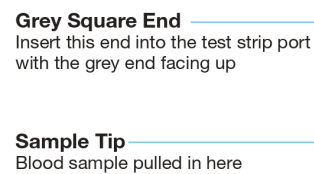

Your MICROLET®2 Lancing Device

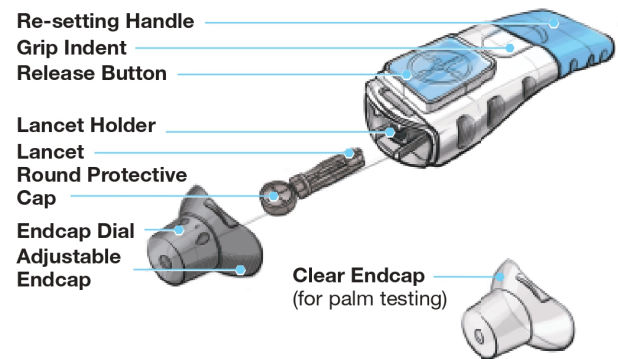

3

1/22/13 9:41 AM