



# SANDHYA ENTERPRISES

**Address:** 5-24-1223/8/1, Ambedkar Nagar, Gajularamaram, Hyderabad – 500055.

**AN ISO 9001:2015 Certified Company**

Contact No: 9652998932

**GSTIN:** 36GNLPS1299P1ZS

**Email :** [sandhyapprises@gmail.com](mailto:sandhyapprises@gmail.com)

**Website:** [www.sandhyaflex.com](http://www.sandhyaflex.com)

## SLURR & MUD RUBBER HOSE (HEAVY DUTY)

**As per IS: IS: 13071-1991 Specification**

### Construction

**Core** Black colour, Synthetic and natural rubber blend resistant to abrasion

**Reinforcement** High Tensile Synthetic Textile cord

**Cover** Black colour, Synthetic rubber resistant to ozone, weather and abrasion

These are heavy duty rubber hoses manufactured by "SANDHYAFLEX" that can be used for vacuum suction of sand, concrete, crushed rocks and other type of abrasive solid/semi solid material. Hoses are required to have high strength and abrasion resistance for this kind of function and hence we have come up with rubber hose for sand and gravel. Highly abrasion resistant hoses used

**Application** in sand and gravel pits, dredging, mining, coal and grain handling.

### PRODUCT NAME:

1. Slurry Rubber Suction and Discharge Hose
2. Slurry Rubber Hose
3. Heavy duty Rubber Hose
4. Mining Flexible Rubber Hose
5. Mines Dewatering Suction Rubber Hose
6. Dewatering Flexible Hose
7. Mines Water Suction and Delivery Rubber Hose
8. Sand and Grovel Rubber Hose
9. Rubber Suction Hose with Steel Flange
10. Sand Blaster Rubber Hose Heavy Duty
11. Mininng and Material and Handling Rubber Hose

12. Rubber Round Mining Hose

13. Slurry Hose for Mining Industries

14. Floating Rubber Hose for Mining and Dredging

15. Dewatering Flexible Rubber Hose



Sr.No	CODE	Description	Max Length
1	<a href="#">SANDYAFLEX-150NB-SRH</a>	6" (150mm)IDx 6 Mtr (LG) with Both End MS Flange as per ASA150#	15 Mtr
2	<a href="#">SANDYAFLEX-200NB-SRH</a>	8" (200mm)IDx 6 Mtr (LG) with Both End MS Flange as per ASA150#	06 Mtr
3	<a href="#">SANDYAFLEX-250NB-SRH</a>	10" (250mm)IDx 6 Mtr (LG) with Both End MS Flange as per ASA150#	06 Mtr
4	<a href="#">SANDYAFLEX-300NB-SRH</a>	12" (300mm)IDx 6 Mtr (LG) with Both End MS Flange as per ASA150#	06 Mtr
5	<a href="#">SANDYAFLEX-350NB-SRH</a>	14" (350mm)IDx 5 Mtr (LG) with Both End MS Flange as per ASA150#	05 Mtr
6	<a href="#">SANDYAFLEX-400NB-SRH</a>	16" (400mm)IDx 5 Mtr (LG) with Both End MS Flange as per ASA150#	05 Mtr

## RUBBER MUD HOSE PIPE

**Rubber mud hose pipe** is manufactured for carrying mud and slurry at a relatively high pressure and with high suction capacity. This hose has very high level of flexibility and can be used for wide variety of applications in the industry. The material used is water absorption resistant and provide the required strength to hose to deal with abrasive material passing through it.

SANDHYAFLEX BRAND NAME is a well known name in manufacturing of heavy duty rubber hoses. We believe in delivering the top class products with continuous improvements in our manufacturing processes.

### APPLICATION

It is widely used for carrying slurry and mud through suction process. This product comes with numerous features such as built in flanges fitted at the end. The quality of rubber used is unmatched which makes it the best hose available in market for transferring mud.

Sr.No	CODE	Description	Max Length
1	SANDHYAFLEX-150NB-MRH	6" (150mm)IDx 6 Mtr (LG) with Both End MS Flange as per ASA150#	15 Mtr
2	SANDHYAFLEX-200NB-MRH	8" (200mm)IDx 6 Mtr (LG) with Both End MS Flange as per ASA150#	06 Mtr
3	SANDHYAFLEX-250NB-MRH	10" (250mm)IDx 6 Mtr (LG) with Both End MS Flange as per ASA150#	06 Mtr
4	SANDHYAFLEX-300NB-MRH	12" (300mm)IDx 6 Mtr (LG) with Both End MS Flange as per ASA150#	06 Mtr
5	SANDHYAFLEX-350NB-MRH	14" (350mm)IDx 5 Mtr (LG) with Both End MS Flange as per ASA150#	05 Mtr
6	SANDHYAFLEX-400NB-MRH	16" (400mm)IDx 5 Mtr (LG) with Both End MS Flange as per ASA150#	05 Mtr



SANDHYAFLEX RUBBER HOSE FOR SAND & GRAVEL SUCTION AND DISCHARGE SERVICES AS PER IS:13071/91 SPECIFICATION

**Lining:** Two types of lining are available in thicknesses from 3mm to 12mm depending on the nature and severity of the application. A tan coloured gumstock 40# hard Natural rubber for fine air-borne abrasives [A402] and a black reinforced 60# hard Natural rubber for slurries and heavy abrasives such as gravel and rock [A412].

**Reinforcement:** Multiple layers of synthetic cord and a single steel helix, giving minimum 3.5:1 safety factor and a minimum bend radius of up to 6x bore size.

**Pressure:** Rated up to 10 to 25 bars working pressure. Higher working pressures are available on request. Hose assemblies are tested upon request.

**Cover:** Corrugated for greater flexibility. Tough weather and abrasion resistant. Two types are available, black Natural rubber for normal use or black Neoprene rubber for more extreme external conditions. Smooth outer covers are available to accommodate external aluminium flanges and MS Flange.

**Couplings:** The following types are usually supplied where the abrasive material would excessively wear a steel hose tail: Integral flanges with steel backing plates. D section ring with two-piece split flanges and Beaded End with one-piece captive flanges.

However, a heavy duty thick walled carbon steel hose tail, wired, strapped or Built-in can be an option.

**Variations:** Lining thickness' can vary depending on the nature of the application. Please remember that our hoses can be designed to your requirements, if you do not see what you want, please call us. 9652998932 and 9550921831

**APPLICATION**

These are heavy duty rubber hoses manufactured by "SANDHYAFLEX" that can be used for vacuum suction of sand, concrete, crushed rocks and other type of abrasive solid/semi solid material. Hoses are required to have high strength and abrasion resistance for this kind of function and hence we have come up with rubber hose for sand and gravel. Highly abrasion resistant hoses used in sand and gravel pits, dredging, mining, coal and grain handling.



Sr.No	CODE	Description	Max Length
-------	------	-------------	------------

1	SANDHYAFLEX-150NB-S&GRH	6" (150mm)IDx 6 Mtr (LG) with Both End MS Flange as per ASA150#	15 Mtr
2	SANDHYAFLEX-200NB- S&GRH	8" (200mm)IDx 6 Mtr (LG) with Both End MS Flange as per ASA150#	06 Mtr
3	SANDHYAFLEX-250NB- S&GRH	10" (250mm)IDx 6 Mtr (LG) with Both End MS Flange as per ASA150#	06 Mtr
4	SANDHYAFLEX-300NB- S&GRH	12" (300mm)IDx 6 Mtr (LG) with Both End MS Flange as per ASA150#	06 Mtr
5	SANDHYAFLEX-350NB- S&GRH	14" (350mm)IDx 5 Mtr (LG) with Both End MS Flange as per ASA150#	05 Mtr
6	SANDHYAFLEX-400NB- S&GRH	16" (400mm)IDx 5 Mtr (LG) with Both End MS Flange as per ASA150#	05 Mtr

### MS Flange Dimension of Class 150 Flanges As per ANSIB 16.5

Nominal Bore		OD	Wall Thickness	RFD	PCD	Holes Dai	No of Hose
ID INCH	ID mm	mm	mm	Mm	mm		
6	150	279.4	25.4	215.9	241.3	22.2	8
8	200	342.9	28.6	269.9	298.4	22.2	8
10	250	406.4	30.2	323.8	361.9	25.4	12
12	300	482.6	31.8	381.	431.8	25.4	12
14	350	533.4	34.9	412.7	476.2	28.6	12
16	400	596.9	36.5	469.9	539.7	28.6	16.0



### Dimension of Split Flange Fitting for Slurry Rubber Hose

Nominal Bore		OD	Height	Closure ID	Closure Outer ID	Closure Inner ID	No of Holes	Side Bolt	Bolt Hole ID
ID INCH	ID mm	mm	mm	Mm	Mm	mm	Nos	mm	Mm
6	150	190.5	114	180	280	197	3x2	2x2	22.2
8	200	241.3	150	228	335	252	4x1	2x2	22.2

## SPLIT FLANGES

### ALUMINUM SPLIT FLANGES

### FOR CMC MAXX HOSE

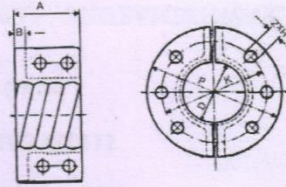

Part Number	'D' (in.)	'A' (in.)	'B' (in.)	'K' (in.)	'P' (in.)	'Z' (# of bolts)	'H' (bolt hole ID, in.)	Approx. Weight (lbs)
CMCC-2	2	3-11/32	5/8	4-3/4	6	4	3/4	3.3
CMCC-3	3	3-5/16	5/8	6	7-1/2	4	3/4	4.4
CMCC-4	4	3-5/16	5/8	7-1/2	9	8	3/4	6.6
CMCC-5	5	4-1/8	5/8	8-1/2	10	8	7/8	7.7
CMCC-6	6	4-1/2	5/8	9-1/2	11	8	7/8	8.8
CMCC-8	8	5-7/8	5/8	11-3/4	13-1/2	8	7/8	13.2
CMCC-10	10	6-7/8	5/8	14-1/4	16	12	1	25.4
CMCC-12	12	7-11/16	5/8	17	19	12	1	30.9

## Aluminium Split Flange Fitting for Slurry Rubber Hose

DETAILS	6" ID	8" ID
HOSE ID	6"	8"
HOSE OD	7.5"	9.5"
HEIGHT	114	150
CLOSURE ID	180	228
CLOSURE OUTER ID	280	335
CLOSURE INNER ID	197	252
NO OF HOLE	3 X 2	4 X 1
SIDE BOLT	2 X 2	2 X 2
BOLE HOLE ID	22.2	22.2







CODE	Description	Images
------	-------------	--------

**SANDHYAFLE  
X-150NB-**

**6"  
(150mm)  
D x 5Mtr  
(LG) with  
Both End  
MS  
Flange as  
per ASA  
150#**



**SANDHYAFLE  
X-150NB**

**6"  
(150mm)  
D x 5Mtr  
(LG)**



**SANDHYAFLE  
X-200NB**

**8"  
(200mm)  
D with  
Both End  
MS  
Flange as  
per ASA  
150#**



**SANDHYAFLE  
X-200NB-  
CFRH**

**8"  
(200mm)  
D**



**SANDHYAFLE  
X-250NB**

**10"  
(250mm)  
D with  
Both End  
MS  
Flange as  
per ASA  
150#**



**SANDHYAFLE  
X-250NB**

**10"  
(250mm)  
D**



**SANDHYAFLE  
X-300NB**

**12"  
(300mm)  
with Both  
End MS  
Flange as  
per ASA  
150#**



**SANDHYAFLE  
X-300NB**

**12"  
(300mm) I  
D**



**SANDHYAFLE  
X-350NB**

**14"  
(350mm)  
with Both  
End MS  
Flange as  
per ASA  
150#**



**SANDHYAFLE  
X-350NB**

**14"  
(350mm) I  
D**



**SANDHYAFLE  
X-400NB**

**16"  
(400mm)  
with Both  
End MS  
Flange as  
per ASA  
150#**



**SANDHYAFLE  
X-400NB**

**16"  
(400mm)  
D**





## SLURRY & MUD RUBBER HOSE (HEAVY DUTY)

As per IS: IS: 13071-1991 Specification

Size: 6" (150mm) ID x 6.0Mtr (LG) with Both End MS Flange

OD	S. No.	Description	Thickness
162.40	1	Lining	5.00
165.60	2	2 Ply (Reinforcement)	0.80
167.60	4	Middle	1.00
0.00	3	MS Wire 12 SWG	2.60
169.60	4	Middle	1.00
172.80	5	2 Ply (Reinforcement)	0.80
176.80	7	Middle	1.00
0.00	6	MS Wire 12 SWG	2.60
178.80	7	Middle	1.00
180.40	8	1 Ply (Reinforcement)	0.80
183.40	9	Cover	1.50

Wall Thickness:16.0kmm

Working Pressure:25 Bar (25Kg/cm<sup>2</sup>)

Proof Pressure:1.5 times of W.P.

Bursting Pressure: 3 times of W.P.

Reinforcement: 2 or 3 galvanized wire helices embedded in layers of Rubber compounds

End Connection: Built –in- Flange Type

Maxim length: 6.0Mtr Maximum

Application: Suction & Discharge of Sand and Gravel, Mud Slurry, Concrete Slurry

/Mining Particles etc.

Bore: Smooth Bore

Bending Radius:10xInner Diameter of Hose ( 1500mm)

Vacuum: Minimum700mmHg (0.9Bar)

Lining material: NR/SBR Resistant to the passage of Abrasive and Corrosive Products

Hardness-50 to 60 Shore A.

Carcass: Synthetic Textile Plies with Embedded Steel Helix

Coating Material: Resistance to Severe and Bad Weather

Temperature: @1 Deg C to 100 Deg C

## SLURRY & MUD RUBBER HOSE (HEAVY DUTY)

As per IS: IS: 13071-1991 Specification

Size: 8" (200mm) ID x 6.0Mtr (LG) with Both End MS Flange

OD	S. No.	Description	Thickness
213.20	1	Lining	5.00
216.40	2	2 Ply (Reinforcement)	0.80
218.40	4	Middle	1.00
0.00	3	MS Wire 10 SWG	3.20
220.40	4	Middle	1.00
223.60	5	2 Ply (Reinforcement)	0.80
227.60	7	Middle	1.00
0.00	6	MS Wire 10 SWG	3.20
229.60	7	Middle	1.00
232.80	8	2 Ply (Reinforcement)	0.80
235.80	9	Cover	1.50

Wall Thickness: 16.3kmm

Working Pressure: 25 Bar (25Kg/cm<sup>2</sup>)

Proof Pressure: 1.5 times of W.P.

Bursting Pressure: 3 times of W.P.

Reinforcement: 2 or 3 galvanized wire helices embedded in layers of Rubber compounds

End Connection: Built -in- Flange Type

Maxim length: 6.0Mtr maximum

Application: Suction & Discharge of Sand and Gravel, Mud Slurry, Concrete Slurry /Mining Particles etc.

Bore: Smooth Bore

Bending Radius: 10xInner Diameter of Hose ( 2000mm)

Vacuum: Minimum 700mmHg (0.9Bar)

Lining material: NR/SBR Resistant to the passage of Abrasive and Corrosive Products

Hardness-50 to 60 Shore A.

Carcass: Synthetic Textile Plies with Embedded Steel Helix

Coating Material: Resistance to Severe and Bad Weather

Temperature: @1 Deg C to 100 Deg C

## SLURRY & MUD RUBBER HOSE (HEAVY DUTY)

As per IS: IS: 13071-1991 Specification

Siize:10" (250mm) ID x 6.0Mtr (LG) with Both End MS Flange

OD	S. No.	Description	Thickness
260.00	1	Lining	5.00
263.2	2	2 Ply (Reinforcement)	0.80
265.2	4	Middle	1.00
0.00	3	MS Wire 10 SWG	3.20
267.2	4	Middle	1.00
270.4	5	2 Ply (Reinforcement)	0.80
272.4	7	Middle	1.00
0.00	6	MS Wire 10 SWG	3.20
274.4	7	Middle	1.00
277.6	8	2 Ply (Reinforcement)	0.80
280.6	9	Cover	1.50

Wall Thickness:15.3kmm

Working Pressure:25 Bar (25Kg/cm<sup>2</sup>)

Proof Pressure:1.5 times of W.P.

Bursting Pressure: 3 times of W.P.

Reinforcement: 2 or 3 galvanized wire helices embedded in layers of Rubber compounds

End Connection: Built -in- Flange Type

Maxim length: 6.0 Mtr Maximum

Application: Suction & Discharge of Sand and Gravel, Mud Slurry, Concrete Slurry

/Mining Particles etc.

Bore: Smooth Bore

Bending Radius:10xInner Diameter of Hose ( 2500mm)

Vacuum: Minimum700mmHg (0.9Bar)

Lining material: NR/SBR Resistant to the passage of Abrasive and Corrosive Products

Hardness-50 to 60 Shore A.

Carcass: Synthetic Textile Plies with Embedded Steel Helix

Coating Material: Resistance to Severe and Bad Weather

Temperature: @ Deg C to 100 Deg C

## SLURRY & MUD RUBBER HOSE (HEAVY DUTY)

As per IS: IS: 13071-1991 Specification

Size: 12" (300mm) ID x 6.0Mtr (LG) with Both End MS Flange

OD	S. No.	Description	Thickness
318.00	1	Lining	9.00
322.80	2	3 Ply (Reinforcement)	0.80
0.00	3	MS Wire 8 SWG	4.00
324.80	4	Middle	1.00
329.60	5	3 Ply (Reinforcement))	0.80
0.00	6	MS Wire 10 SWG	4.00
331.60	7	Middle	1.00
336.40	8	3 Ply (Reinforcement))	0.80
339.40	9	Cover	1.50

Wall Thickness: 20.0mm

Working Pressure: 25 Bar (250Kg/cm<sup>2</sup>)

Proof Pressure: 1.5 times of WP.

Bursting Pressure: 3 times of WP.

Reinforcement: 2 or 3 galvanized wire helices embedded in layers of Rubber compounds

End Connection: Built-in- Flange Type

Maxim length: 6.0Mtr Maximum

Application: Suction & Discharge of Sand and Gravel, Mud Slurry, Concrete Slurry / Mining Particles etc.

Bore: Smooth Bore

Bending Radius: 10x Inner Diameter of Hbse (3000mm)

Vacuum Minimum: 700mm Hg (0.9Bar)

Lining material: NR/SBR Resistant to the passage of Abrasive and Corrosive Products

Hardness: 50 to 60 Shore A

Carcass: Synthetic Textile Plies with Embedded Steel Helix

Coating Material: Resistance to Severe and Bad Weather

Temperature: @ 1 Deg C to 100 Deg C

## SLURRY & MUD RUBBER HOSE (HEAVY DUTY)

As per IS: IS: 13071-1991 Specification

Siize:14" (350mm) ID x 5.0Mtr (LG) with Both End MS Flange

OD	S Nb	Description	Thickness
368.00	1	Lining	9.00
372.80	2	3 Ply (Reinforcement)	0.80
0.00	3	MSWire 8 SWG	4.00
374.80	4	Mddle	1.00
379.6	5	3 Ply (Reinforcement))	0.80
0.00	6	MSWire 10 SWG	4.00
381.6	7	Mddle	1.00
386.4	8	3 Ply (Reinforcement))	0.80
389.4	9	Cover	1.50

Wall Thickness-19.7mm

Working Pressure:25 Bar (25Kg/cm2)

Proof Pressure:1.5 times of W.P.

Bursting Pressure: 3 times of W.P.

Reinforcement: 2 or 3 galvanized wire helices embedded in layers of Rubber compounds

End Connection: Built –in- Flange Type

Maxim length: 6 Mtr

Application: Suction & Discharge of Sand and Gravel, Mud Slurry, Concrete Slurry /Mining Particles etc.

Bore: Smooth Bore

Bending Radius:10xInner Diameter of Hose ( 3500mm)

Vacuum: Minimum700mmHg (0.9Bar)

Lining material: NR/SBR Resistant to the passage of Abrasive and Corrosive Products

Hardness-50 to 60 Shore A.

Carcass: Synthetic Textile Plies with Embedded Steel Helix

Coating Material: Resistance to Severe and Bad Weather

Temperature: @1 Deg C to 100 Deg C

## SLURRY & MUD RUBBER HOSE (HEAVY DUTY)

As per IS: IS: 13071-1991 Specification

Siize:16" (400mm) ID x 4.0Mtr (LG) with Both End MS Flange

OD	S Nb	Description	Thickness
420.00	1	Lining	10.00
424.8	2	3 Ply (Reinforcement)	0.80
0.00	3	MSWire 8 SWG	4.00
427.8	4	Mddle	1.50
432.6	5	3 Ply (Reinforcement))	0.80
0.00	6	MSWire 10 SWG	4.00
435.6	7	Mddle	1.50
440.4	8	3 Ply (Reinforcement))	0.80
443.4	9	Cover	1.50

Wall Thckness:21.70mm

Working Pressure:25 Bar (25Kg/cm2)

Proof Pressure:1.5 times of W.P.

Bursting Pressure: 3 times of W.P.

Reinforcement: 2 or 3 galvanized wire helices embedded in layers of Rubber compounds

End Connection: Built –in- Flange Type

Maxim length: 6 Mtr Maximum

Application: Suction & Discharge of Sand and Gravel, Mud Slurry, Concrete Slurry

/Mining Particles etc.

Bore: Smooth Bore

Bending Radius:10xInner Diameter of Hose ( 4000mm)

Vacuum: Minimum700mmHg (0.9Bar)

Lining material: NR/SBR Resistant to the passage of Abrasive and Corrosive Products

Hardness-50 to 60 Shore A.

Carcass: Synthetic Textile Plies with Embedded Steel Helix

Coating Material: Resistance to Severe and Bad Weather

Temperature: @1 Deg C to 100 Deg C

## BUSINESS POLICY

Inquiry

Quotation

Purchase Order

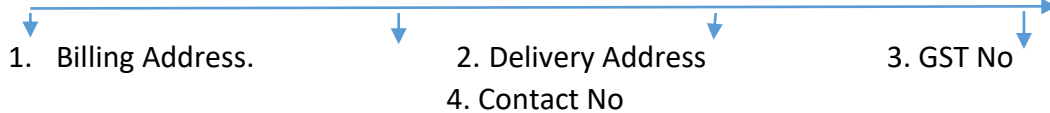

Performa Invoice

Advance Payment

Take in Production as per Purchase Order

After Completed Consignment Inform to Client for  
Balance Payment

Dispatch the Material

Provide LR Copy

Bank Details	
<b>COMPANY NAME</b>	SANDHYA ENTERPRISES
<b>Bank</b>	HDFC Bank Ltd
<b>Branch</b>	5-80,HMT Road,Chintal, Jeedimetla,Qutubulapur Mandal Dist. R R ,Hyderabad-500054 Telangana

<b>Account No</b>	50200016352482
<b>IFSC</b>	HDFC0001041
<b>PAN No</b>	GNLPS1299P
<b>GST NO</b>	36GNLpPS1299P1ZS
<b>IEC</b>	0916915042
<b>AD Code</b>	05114228381149
<b>MSME</b>	TS20B0028147

**For More Information, Please Contact Us:**

Mobile: 9652998932, 6304766851.

<mailto:sandhyapprises@gmail.com>

WhatsApp: 9652998932

YouTube: [www.youtube.com/c/SANDHYAENTERPRISES](http://www.youtube.com/c/SANDHYAENTERPRISES)

Website : <http://www.sandhyaflex.com/pvc-water-...>

**Request a Quote :** <https://www.sandhyaflex.com/contactus-1.php>