

LXSC-15G Multi-jet Dry Type Vane Wheel Water Meter



Copper Sealed Register



Application

- ◆ Measuring the volume of cold potable water passing through the pipeline.

Working Conditions

- ◆ Water temperature: $\leq 40^{\circ}\text{C}$.
- ◆ Water pressure: $\leq 1.6\text{MPa}$.

Construction

- ◆ The meter consists of a body, a measuring unit, a register unit, a retaining ring and others. The retaining ring secures the internal parts.

Working Principle

- ◆ This is a multi-jet impeller meter with a drive magnet and an internal dry type register. The impeller movements is transferred by a magnetic coupling to the vacuumized and hermetically sealed register, which the reading is made.

Compliance with Standard

- ◆ Technical data conforms to ISO 4064 Class B Standard for horizontal installation.

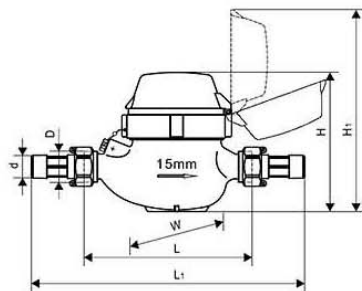

Features

- ◆ With external regulating device.
- ◆ Magnetic drive, lower transmission resistance.
- ◆ Magnetic shield, use for external magnetic field protection.
- ◆ Evacuated and sealed dry dial register ensures clear reading.
- ◆ inlet strainer.
- ◆ Non return valve for selecting

Attachment

- ◆ With every water meter(threaded ends), there will be two couplings, two nuts, two coupling gaskets and two meter spud thread protectors. Note: To protect the meter spud threads, store the meter with thread protectors in place.

Indication

- ◆ Cubic meter(m^3) for selecting.

Dimensions and Weights

Nominal diameter	DN	15
Body thread	D	G3/4B
Connector thread	d	R1/2
Body length	mm	L 165
Overall length	mm	L ₁ 246
Width	mm	W 81
Meter height	mm	H 105
Working height	mm	H ₁ 153
Weight without connectors	Kg	1.1
Weight with connectors	Kg	1.3

LXSC-15G Multi-jet Dry Type Vane Wheel Water Meter

Main Technical Data

Nominal diameter	DN	15
Maximum flow rate	m ³ /h	Qmax 3.0
Nominal flow rate	m ³ /h	Qn 1.5
Transition flow rate	l/h	Qt 120
Minimum flow rate	l/h	Qmin 30
Maximum reading	m ³	9999.9999
Minimum reading	m ³	0.0001



Copper Sealed Register

◆ Maximum Permissible Error:

In the lower zone from Qmin inclusive up to but excluding Qt is ±5%.
 In the upper zone from Qt inclusive up to and including Qmax is ±2%.

Accuracy Curve

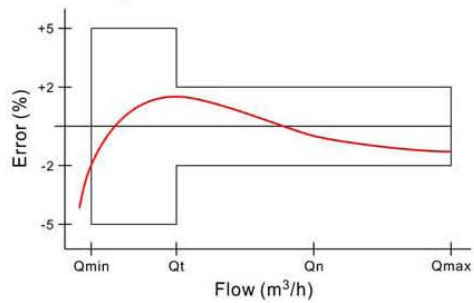

Installation

- ◆ Attention should be paid that the cold water meter must not be used for hot water and caustic liquid.
- ◆ The nominal diameter of water meter should be selected according to the volume of water passing through the pipeline.
- ◆ The meter can be installed in one position:

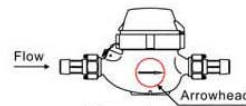
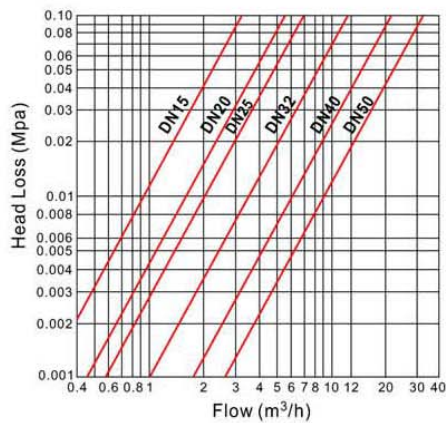

Figure 1

Head Loss Curve



- ◆ The meter must be installed with the direction of the flow as indicated by the arrow cast in the meter body (see figure 1).
- ◆ A horizontal position with the register face upwards is recommended.
- ◆ In order to keep the water meter in good working, the pipeline should be clear up before install the meter.
- ◆ The valves must be installed in the front and the back of the water meter.
- ◆ The water meter should not be installed under the surface of water.

LXSC-15G

Multi-jet Dry Type Vane Wheel Water Meter

Exploded View

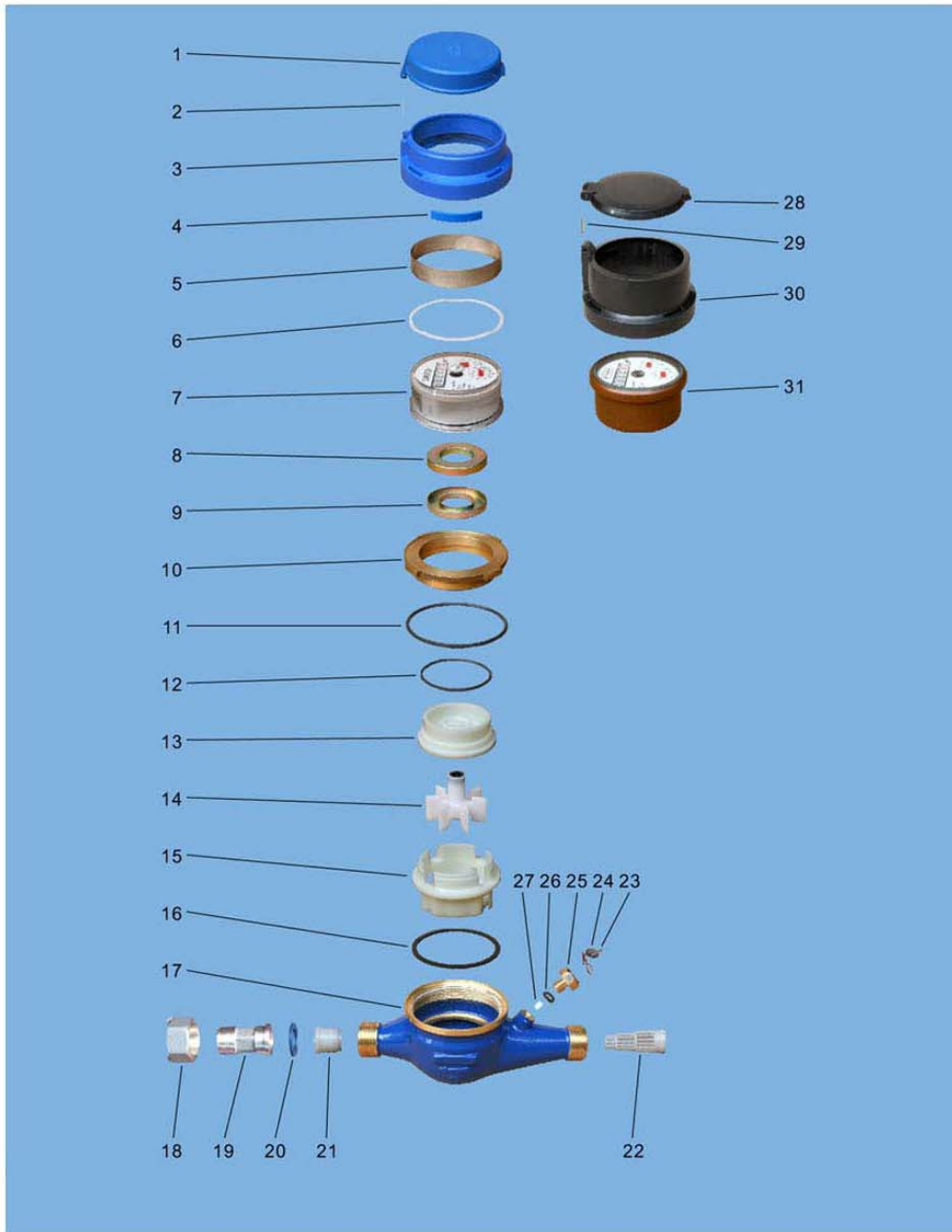

Parts List

No.	Name	Qty
1	Lid	1
2	Hinge pin	1
3	Retaining ring	1
4	Flashboard	1
5	Protect ring	1
6	Gasket	1
7	Register	1
8	Magnetic shield	1
9	Magnetic shield	1
10	Impact ring	1
11	O-ring	1
12	O-ring	1
13	Seal plate	1
14	Impeller	1
15	Measuring chamber	1
16	Gasket	1
17	Body	1
18	Nut	2
19	Coupling	2
20	Gasket	2
21	Non return valve(for selecting)	1
22	Inlet strainer	1
23	Copper wire	1
24	Seal lead	1
25	Regulating bolt	1
26	Gasket	1
27	Regulating screw	1
28	Lid(for copper sealed register)	1
29	Hinge pin(for copper sealed register)	1
30	Retaining ring(for copper sealed register)	1
31	Copper sealed register	1